

F.A.U. RTE.	SECTION	COUNTY	TOTAL SHEETS	SHEET NO.
2722	3061 (A,B,&C) RS	COOK	25	1

STATE OF ILLINOIS
DEPARTMENT OF TRANSPORTATION
DIVISION OF HIGHWAYS

D-91-363-06

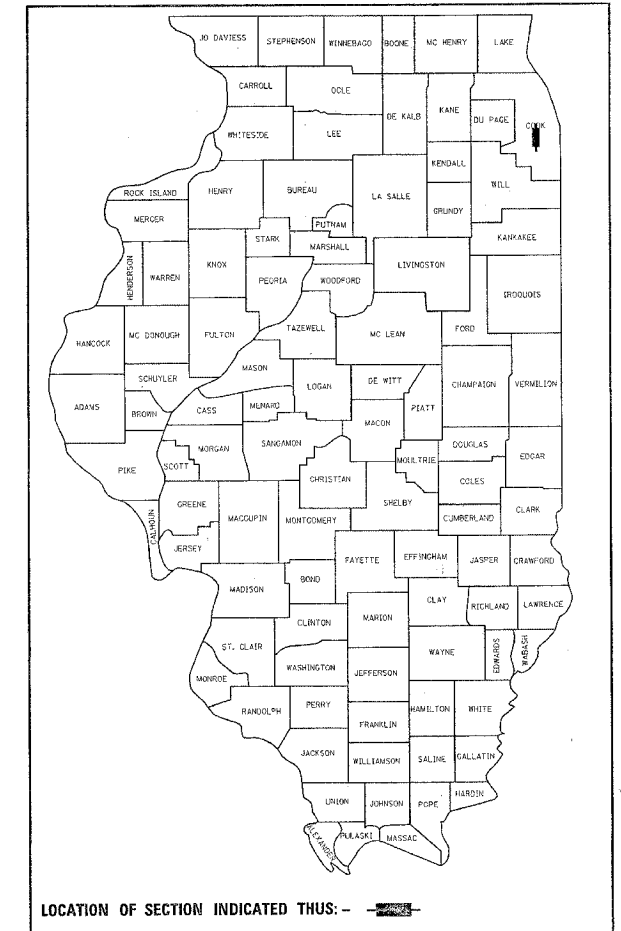

LOCATION OF SECTION INDICATED THUS: - [Symbol] -

FOR INDEX OF SHEETS, SEE SHEET NO. 2

IMPROVEMENT LOCATED IN THE
VILLAGES OF BROADVIEW, NORTH, RIVERSIDE,
La GRANGE PARK AND BROOKFIELD.

**PROPOSED
HIGHWAY PLANS**

FAU ROUTE 2722 : 17th AVENUE (MAPLE AVE.)
SECTION: 3061 (A,B,C) RS
ILLINOIS CENTRAL RAILROAD TO 31ST ST.
RESURFACING (3P)
COOK COUNTY
C-91-363-06

DISTRICT 1 DESIGN PLAN PREPARATION ENGINEER: KEN ENG/ LONG TRAN (847) 705-4240

IMPROVEMENT BEGINS
STATION 79+80

OMISSION:
STATION 44+78 TO
STATION 47+27

IMPROVEMENT ENDS
STATION 6+74

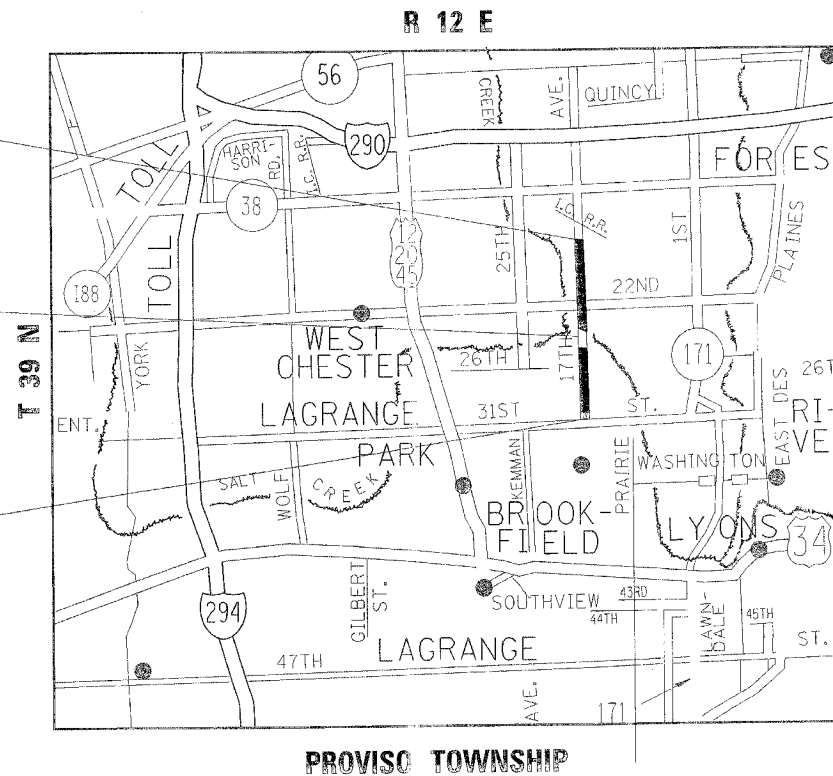

TRAFFIC DATA
2006 ADT = 9,500
POSTED SPEED LIMIT 30-35 MPH

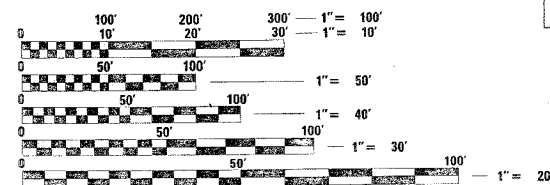

FULL SIZE PLANS HAVE BEEN PREPARED USING STANDARD
ENGINEERING SCALES. REDUCED SIZED PLANS WILL NOT
CONFORM TO STANDARD SCALES. IN MAKING MEASUREMENTS
ON REDUCED PLANS, THE ABOVE SCALES MAY BE USED.

J.U.L.I.E.
JOINT UTILITY LOCATION INFORMATION FOR EXCAVATION
1-800-892-0123

GROSS LENGTH OF IMPROVEMENT = 7,306 LINEAL FEET = 1.38 MILES
NET LENGTH OF IMPROVEMENT = 7,057 LINEAL FEET = 1.34 MILES

STATE OF ILLINOIS
DEPARTMENT OF TRANSPORTATION
DIVISION OF HIGHWAYS

SUBMITTED APRIL 12, 2007

[Signature]
DEPUTY DIRECTOR OF HIGHWAYS, REGION ENGINEER

May 11, 2007
[Signature]
SENIOR ENGINEER OF DESIGN AND ENVIRONMENT

May 11, 2007
[Signature]
DIRECTOR OF HIGHWAYS, CHIEF ENGINEER

**PRINTED BY THE AUTHORITY
OF THE STATE OF ILLINOIS**