

EXISTING STRUCTURE: S.N. 016-0978

BUILT IN 1970 AS A 3 SPAN WIDE FLANGE STEEL GIRDER BRIDGE CARRYING F.A.I. ROUTE 290 (I-290) OVER WOODFIELD DRIVE.

SHEET S26 OF S34		F.A.I. NO.	SECTION	COUNTY	TOTAL SHEETS	SHEET NO.
		290	2006-0301	COOK	78	63
STA.	TO STA.		FED. ROAD DIST. NO.			
		ILLINOIS		FED. AID PROJECT		

CONTRACT NO. 60B79

SCOPE OF WORK:

REMOVE THE EXIST. 1 3/4" HOT-MIX ASPHALT SURFACE & HYDRO-SCARIFY 3/4" OF THE CONCRETE SURFACE.

MARK AREAS OF FULL DEPTH REMOVAL.

PERFORM DECK SLAB REPAIRS.

REMOVE PARAPET HANDRAIL, PERFORM PARAPET REPAIRS AND CONSTRUCT CONCRETE PARAPET & WINGWALL EXTENSIONS.

RESEAL TRANSVERSE EXPANSION JOINTS AND EXTEND OR PLUG FLOOR DRAINS.

PLACE A 2 1/2" LATEX CONCRETE OVERLAY.

PERFORM SUBSTRUCTURE AND SLOPEWALL REPAIRS.

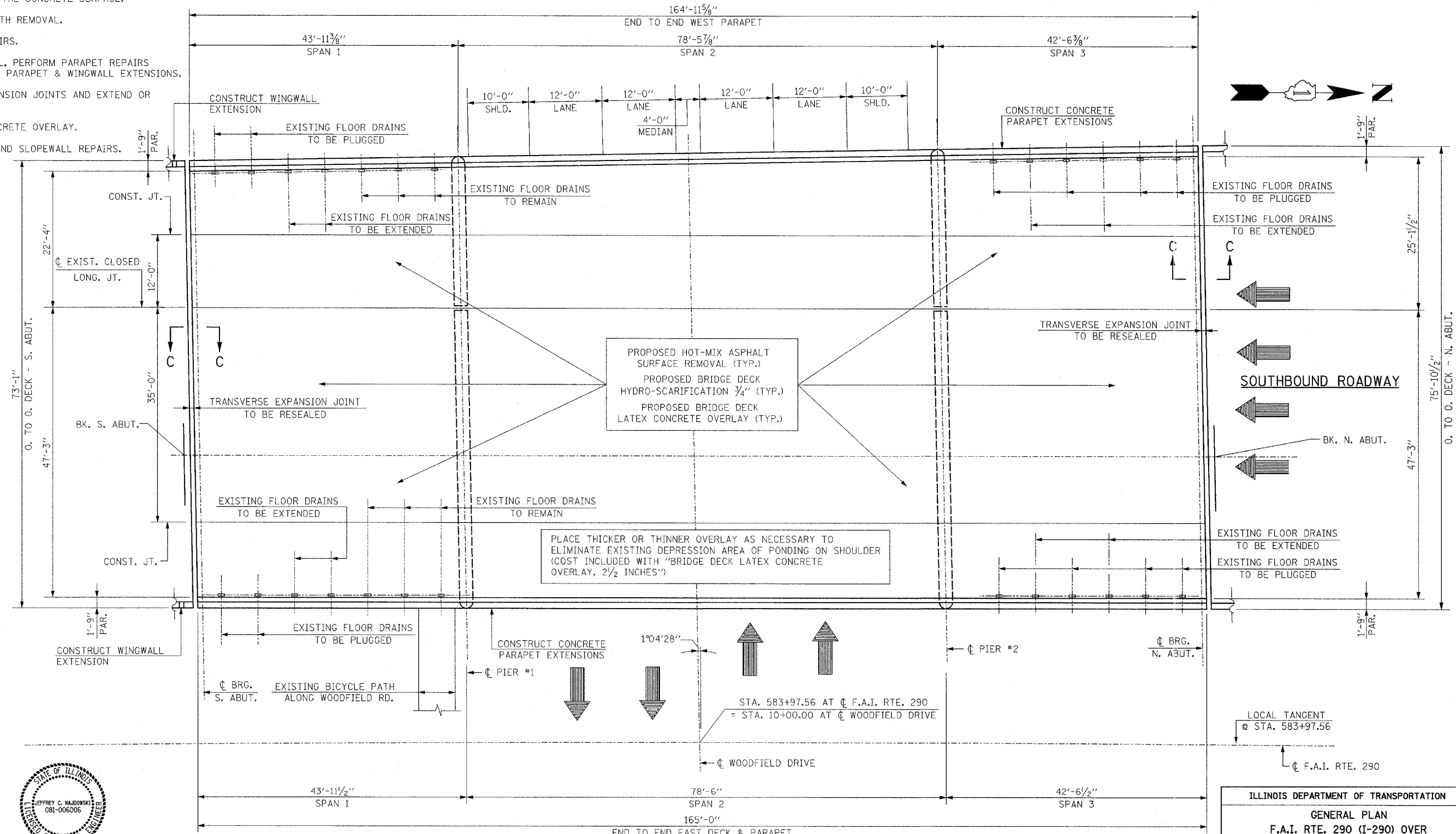

EXIST. PLAN - SOUTHBOUND ROADWAY



JEFFREY C. NAJDOWSKI
LICENSED STRUCTURAL ENGINEER
STATE OF ILLINOIS LIC. No. 081-006006
EXPIRES: 11-30-08

REVISIONS	
NAME	DATE

NOTE:
FOR SECTION C-C SEE SHT. S34.

ILLINOIS DEPARTMENT OF TRANSPORTATION

GENERAL PLAN
F.A.I. RTE. 290 (I-290) OVER
WOODFIELD DRIVE
F.A.I. RTE. 290 SECTION: 2006-0301
COOK COUNTY STATION 583+97.56
STRUCTURE NO. 016-0978

SCALE: DATE: MAY 10, 2007
DRAWN BY: D.L./F.M.
CHECKED BY: B.N.S./J.C.N.

CHRISTIAN-ROGE & ASSOC., INC.
CHICAGO ILLINOIS