

F.A.I. NO.	SECTION	COUNTY	TOTAL SHEETS	SHEET NO.
290	2006-0301	COOK	78	66
STA.	TO STA.			
FED. ROAD DIST. NO.	ILLINOIS	FED. AID PROJECT		

CONTRACT NO. 60B79

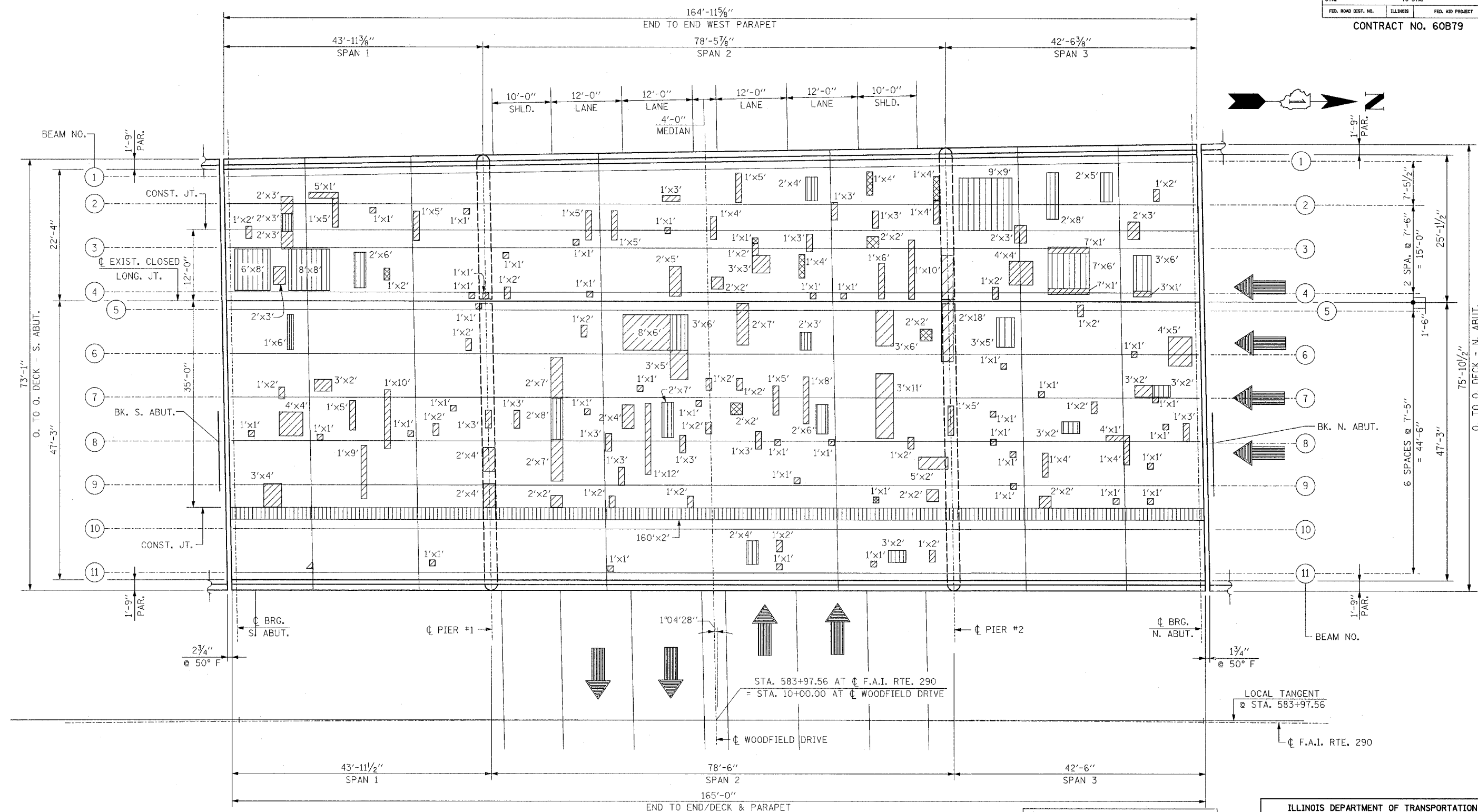

EXIST. PLAN - SOUTHBOUND ROADWAY

BILL OF MATERIAL

DESCRIPTION	UNIT	QUANTITY
DECK SLAB REPAIR (FULL DEPTH, TYPE I)	SQ. YD.	5
DECK SLAB REPAIR (FULL DEPTH, TYPE II)	SQ. YD.	95

LEGEND:

- \* DECK SLAB REPAIR (PARTIAL)
- DECK SLAB REPAIR (FULL DEPTH, TYPE I)
- DECK SLAB REPAIR (FULL DEPTH, TYPE II)

REVISIONS	
NAME	DATE

NOTE:  
REPAIR PATCH DIMENSIONS ARE CALLED OUT HORIZONTAL BY VERTICAL.  
PATCHING IS TO BE DETERMINED IN THE FIELD AT RESIDENT ENGINEER'S DISCRETION.

ILLINOIS DEPARTMENT OF TRANSPORTATION

BRIDGE DECK PATCHING  
F.A.I. RTE. 290 (I-290) OVER  
WOODFIELD DRIVE  
F.A.I. RTE. 290 SECTION: 2006-0301  
COOK COUNTY STATION 583+97.56  
STRUCTURE NO. 016-0978

SCALE:  
DATE: MAY 10, 2007

DRAWN BY: D.L./F.M.  
CHECKED BY: B.N.S./J.C.N.

CHRISTIAN-ROGE & ASSOC., INC.  
CHICAGO ILLINOIS