

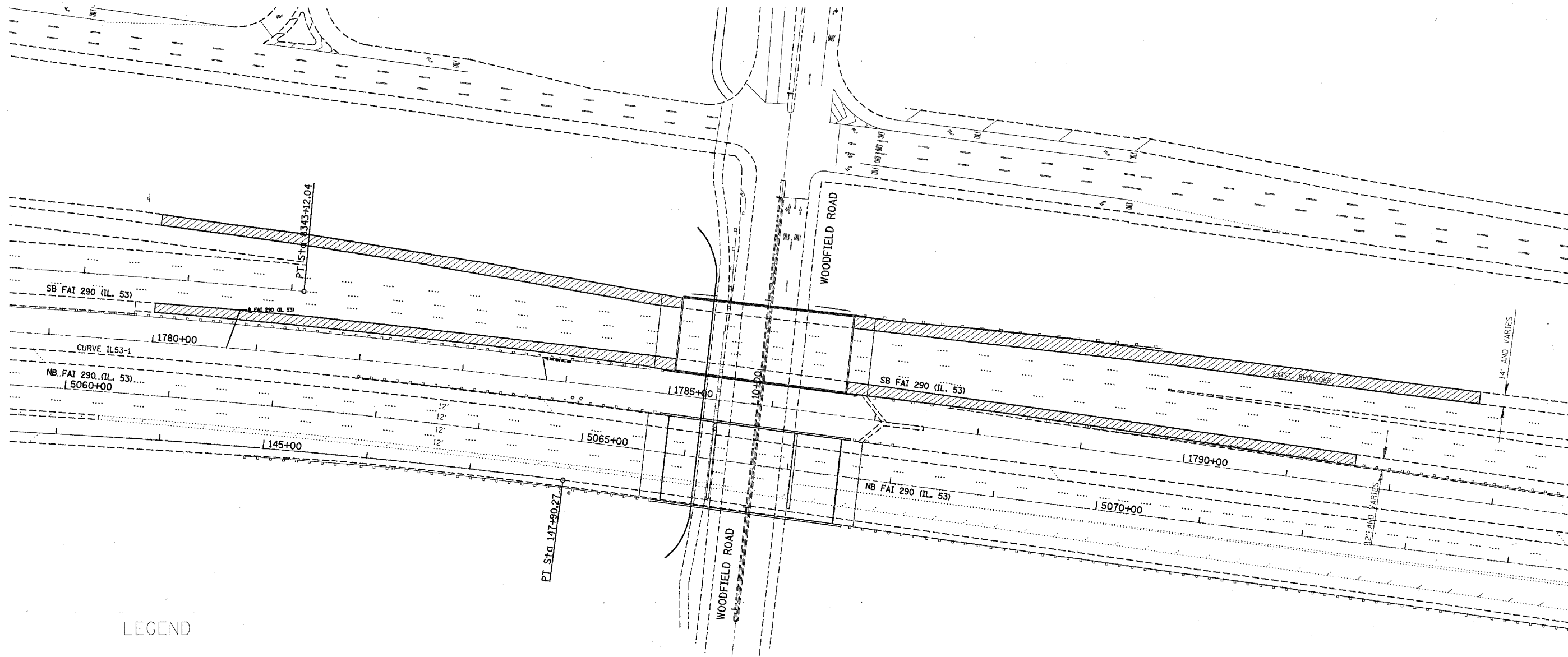

F.A. RTE.	SECTION	COUNTY	TOTAL SHEETS	SHEET NO.
290	2006-030 I	COOK	78	70
STA.		TO STA.		
FED. ROAD DIST. NO.		ILLINOIS	FED. AID PROJECT	



LEGEND

-  PROP. HMA SURFACE REMOVAL 1-1/2"
PROP. HMA SURFACE COURSE, MIX "D", N70
PROP. SHOULDER RUMBLE STRIP (TO BE INSTALLED AFTER STAGE CONSTRUCTION)
-  PROP. HMA SURFACE REMOVAL 2"
PROP. HMA SURFACE COURSE, MIX "F", N105

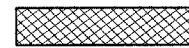
NOTE

HMA RESURFACING OF THE EXISTING ROADWAY SHOULDERS SHALL BE LIMITED TO AREAS WHERE TRAFFIC HAS TO BE WEAVED INTO THE SHOULDER FOR STAGING. SHOULDER RESURFACING SHALL BE COMPLETED PRIOR TO STAGE CONSTRUCTION.

REVISIONS	
NAME	DATE

ILLINOIS DEPARTMENT OF TRANSPORTATION

ROADWAY PLANS
I-290/IL. 53 AT
WOODFIELD DR.

SCALE: VERT.
HORIZ.
DATE

DRAWN BY
CHECKED BY