

F.A. RTE.	SECTION	COUNTY	TOTAL SHEETS	SHEET NO.
290	2006-030 I	Cook	78	72
STA.		TO STA.		
FED. ROAD DIST. NO.		ILLINOIS	FED. AID PROJECT	

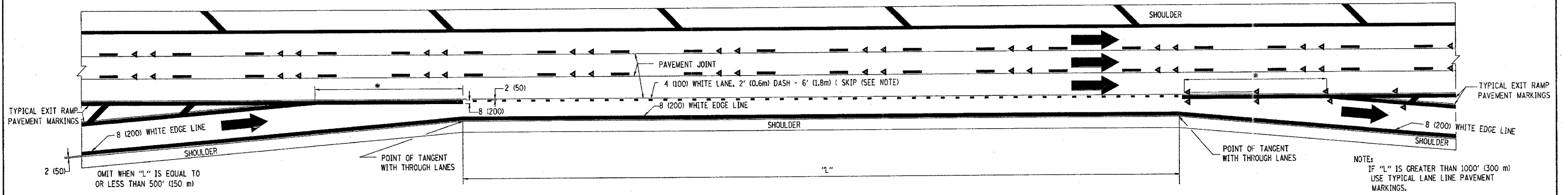

TYPICAL ENTRANCE/EXIT RAMP COMBINATION PAVEMENT MARKINGS

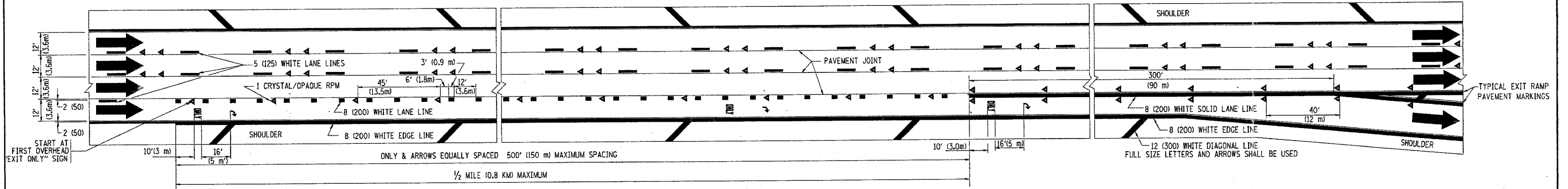

TYPICAL EXIT ONLY LANE PAVEMENT MARKINGS

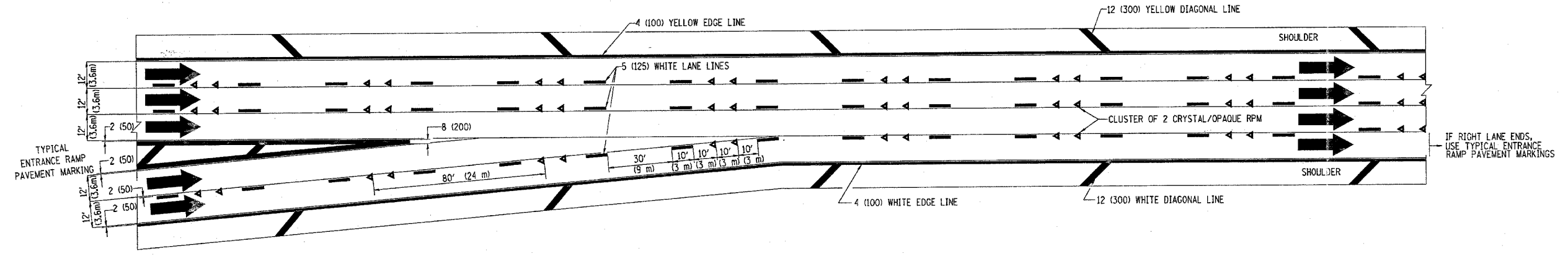

TYPICAL TWO LANE ENTRANCE RAMP PAVEMENT MARKINGS

REVISIONS	
NAME	DATE
DWS	1/90
DWS	5/91
SPB	1/07

ILLINOIS DEPARTMENT OF TRANSPORTATION
MULTI-LANE FREEWAY PAVEMENT MARKING DETAILS
 SCALE: NONE
 DRAWN BY C.A.D.D.
 CHECKED BY
 TC12 SHEET 2 OF 2

PLOT DATE = 3/6/2007
 FILE NAME = K:\dms\dms1\12.dgn
 PLOT SCALE = 300000 / IN.
 USER NAME = bounard