







F.A.P. RTE.	SECTION	COUNTY	TOTAL SHEETS	SHEET NO.
303	131B (1&2) BR	McHENRY	107	32
STA.	TO STA.			
FED. ROAD DIST. NO.	ILLINOIS	FED. AID PROJECT		
CONTRACT NO. 60B83				

EROSION CONTROL LEGEND

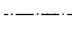
-  WORK ZONE - STAGE I
-  TEMPORARY PAVEMENT
-  CLEARING AND GRADING LIMIT
-  FENCE (EROSION CONTROL), SPECIAL, SEE DETAIL SHEET NO.
-  TEMPORARY DITCH CHECK
-  INLET AND PIPE PROTECTION
-  STONE RIP RAP

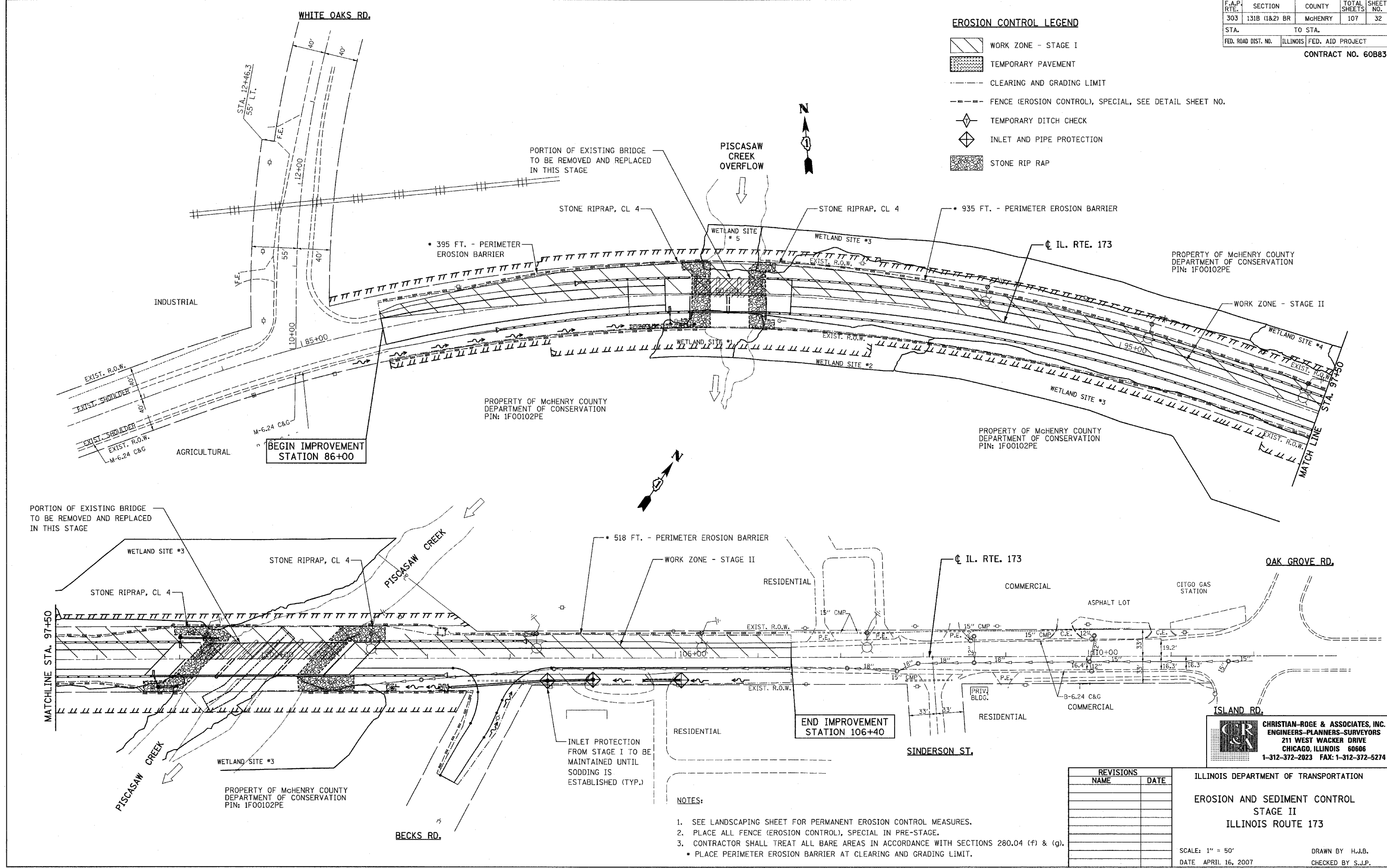

CHRISTIAN-ROGE & ASSOCIATES, INC.
 ENGINEERS-PLANNERS-SURVEYORS
 211 WEST WACKER DRIVE
 CHICAGO, ILLINOIS 60606
 1-312-372-2023 FAX: 1-312-372-5274

REVISIONS	
NAME	DATE

ILLINOIS DEPARTMENT OF TRANSPORTATION
 EROSION AND SEDIMENT CONTROL
 STAGE II
 ILLINOIS ROUTE 173

SCALE: 1" = 50'
 DATE: APRIL 16, 2007
 DRAWN BY: H.J.B.
 CHECKED BY: S.J.P.

- NOTES:**
- SEE LANDSCAPING SHEET FOR PERMANENT EROSION CONTROL MEASURES.
 - PLACE ALL FENCE (EROSION CONTROL), SPECIAL IN PRE-STAGE.
 - CONTRACTOR SHALL TREAT ALL BARE AREAS IN ACCORDANCE WITH SECTIONS 280.04 (f) & (g).
 • PLACE PERIMETER EROSION BARRIER AT CLEARING AND GRADING LIMIT.