

F.A.I. RTE.	SECTION	COUNTY	TOTAL SHEETS	SHEET NO.
59		WILL	102	39
STA.	TO STA.			
FED. ROAD DIST. NO. 1 ILLINOIS			FED. AID PROJECT	
99(1&2)AC-R-2			CONTRACT NO. 60897	

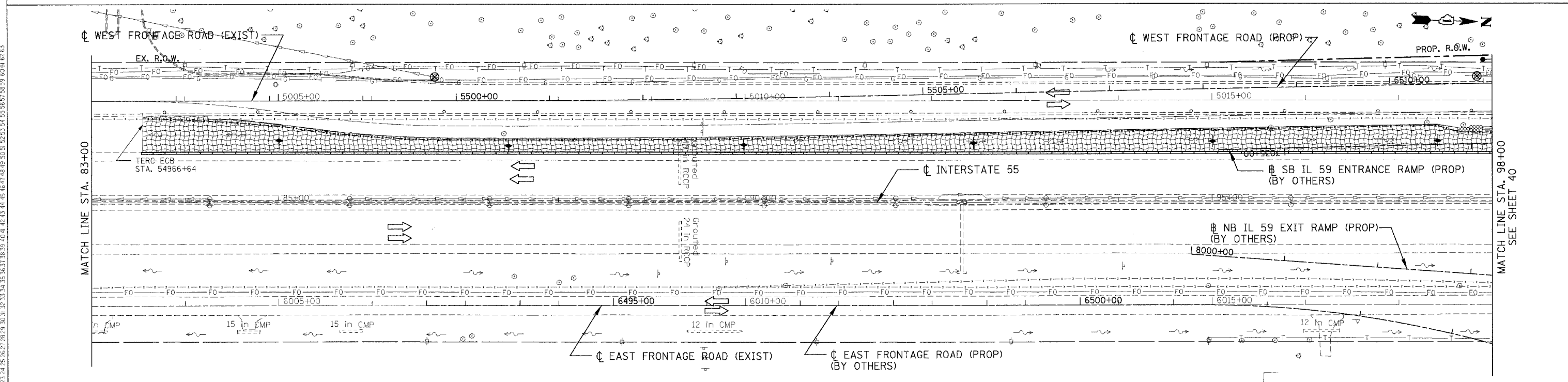
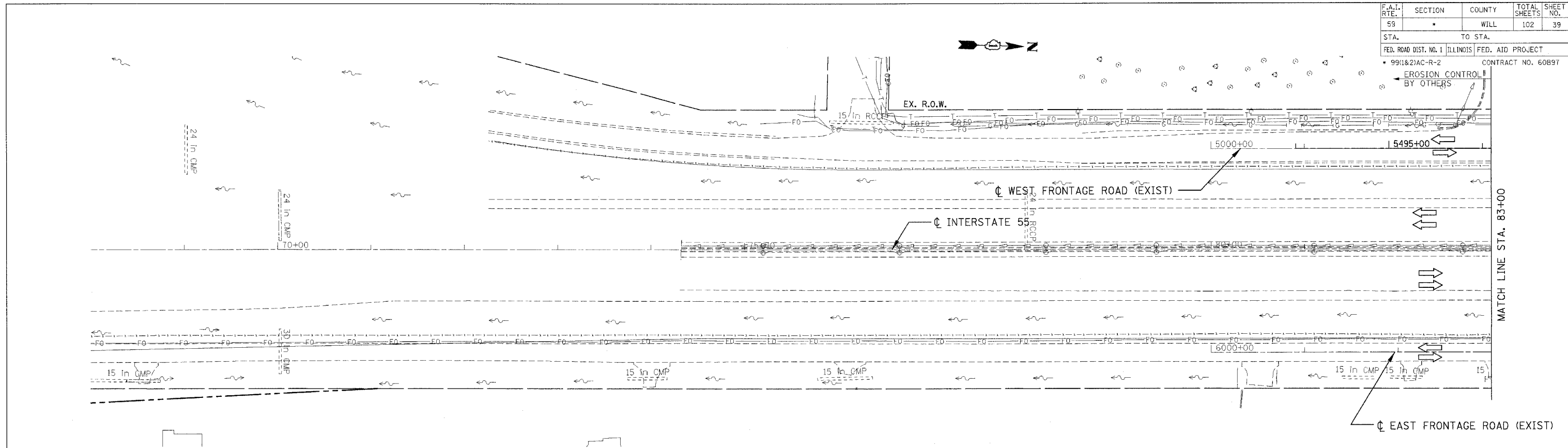

**EROSION CONTROL LEGEND**

- |  |   |  |  |
|--|---|--|--|
|  | SEDIMENT BASIN  |  | STRUCTURE REMOVAL                          |
|  | INLET FILTERS   |  | DRAINAGE STR. TO BE CLEANED                |
|  | INLET & PIPE PROTECTION   |  | STRUCTURE TO BE ADJUSTED                   |
|  | PERIMETER EROSION BARRIER (PEB)   |  | EROSION CONTROL BLANKET                    |
|  | TEMPORARY DITCH CHECK   |  | TEMPORARY PIPE REMOVAL                     |
|  | TEMPORARY EROSION CONTROL SEEDING AND EROSION CONTROL BLANKET (TERC ECB), UNLESS OTHERWISE NOTED          |  | TEMPORARY PAVEMENT, UNLESS OTHERWISE NOTED |
|  | EXISTING TEMPORARY EROSION CONTROL SEEDING AND EROSION CONTROL BLANKET (TERC ECB), UNLESS OTHERWISE NOTED |  | PAVEMENT REMOVAL, UNLESS OTHERWISE NOTED   |

**NOTES:**

- FOR PERMANENT DRAINAGE STRUCTURE AND PIPE INFORMATION SEE SHEET 56.
- PER STANDARD 2800001, ALL SEDIMENT BASINS TO BE PLACED AS SHOWN AND REMOVED AT THE END OF THE PROJECT. THE COST WILL BE INCLUDED IN THE CONTRACT UNIT PRICE BID PER CUBIC YARD FOR "EARTH EXCAVATION FOR EROSION CONTROL".
- AGGREGATE EROSION CONTROL IS NOT REQUIRED FOR SEDIMENT BASINS WHERE THESE DISCHARGE TO STONE RIPRAP.
- LATERAL SEWER PIPE TO MAINLINE SEWER SHALL HAVE THEIR UPSTREAM ENDS TEMPORARILY PLUGGED ACCORDING TO DETAILS OF SHEET 57, OR AS DIRECTED BY THE ENGINEER. PLUG WILL BE REMOVED UPON CONSTRUCTION OF REMAINING LATERAL PIPE, AS DIRECTED BY THE ENGINEER. COST OF TEMPORARY PLUG AND SUBSEQUENT REMOVAL FOR LATERAL STORM SEWER CONNECTIONS WILL NOT BE PAID FOR SEPARATELY, BUT WILL BE INCLUDED IN THE CONTRACT UNIT PRICE BID PER FOOT FOR STORM SEWERS, OF THE CLASS AND TYPE SPECIFIED.

REVISIONS	
NAME	DATE

ILLINOIS DEPARTMENT OF TRANSPORTATION  
 FAI 55 WEST FRONTAGE ROAD AT IL 59  
 SECTION: 99(1&2)AC-R-2  
**EROSION CONTROL**  
**STAGE I**  
**STA. 68+00 TO STA. 98+00**

SCALE: 1" = 50'  
 DATE: 03/22/2007  
 DRAWN BY: SN  
 CHECKED BY: ACL

**TENG**  
 TENG & ASSOCIATES, INC.  
 ENGINEERS/ARCHITECTS/PLANNERS  
 200 N. MICHIGAN AVE. CHICAGO, IL 60601  
 TELEPHONE: 312.644.8000

\\AL100264.DGN, \\S000264.DGN, \\T100264.DGN, \\L100264.DGN, \\S100264.DGN, \\L200264.DGN, \\S200264.DGN, \\L300264.DGN, \\S300264.DGN, \\L400264.DGN, \\S400264.DGN, \\L500264.DGN, \\S500264.DGN, \\L600264.DGN, \\S600264.DGN, \\L700264.DGN, \\S700264.DGN, \\L800264.DGN, \\S800264.DGN, \\L900264.DGN, \\S900264.DGN, \\L000264.DGN, \\S000264.DGN, \\L100264.DGN, \\S100264.DGN, \\L200264.DGN, \\S200264.DGN, \\L300264.DGN, \\S300264.DGN, \\L400264.DGN, \\S400264.DGN, \\L500264.DGN, \\S500264.DGN, \\L600264.DGN, \\S600264.DGN, \\L700264.DGN, \\S700264.DGN, \\L800264.DGN, \\S800264.DGN, \\L900264.DGN, \\S900264.DGN, \\L000264.DGN, \\S000264.DGN