

| F.A.U. RTE. | SECTION | COUNTY | TOTAL SHEETS | SHEET NO. |
|---------------------|----------|---------------------------|--------------|-----------|
| 1374 | 0406 WRS | COOK | 75 | 12 |
| STA. 94+70 | | TO STA. 104+75 | | |
| FED. ROAD DIST. NO. | | ILLINOIS FED. AID PROJECT | | |

NOTE: ALL LATERALS FROM STA. 92+00 TO STA. 106+00 WILL BE JETTED AND CLEANED

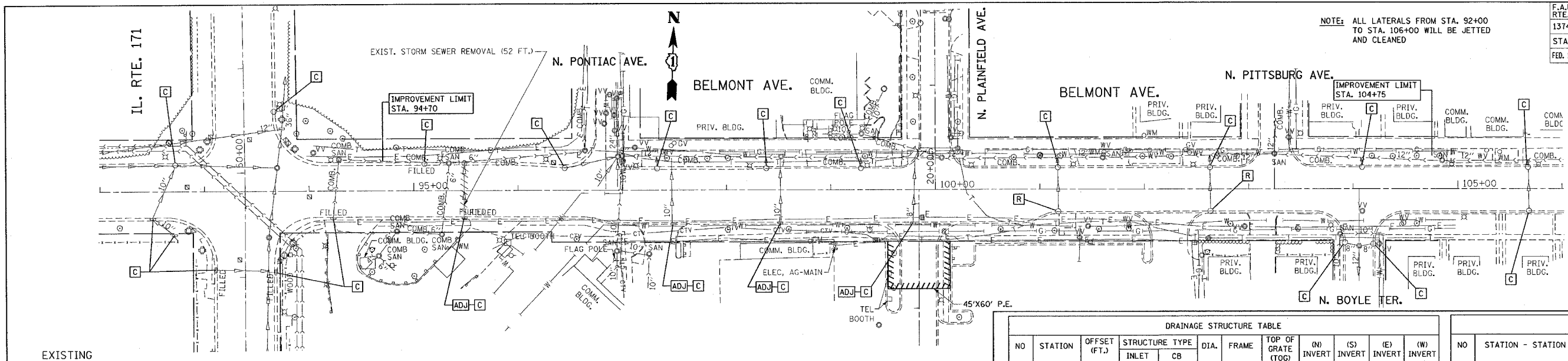

- [R] REMOVE STRUCTURE
- [ADJ] ADJUST STRUCTURE
- [C] CLEAN STRUCTURE

| STA. | OFFSET | TYPE |
|----------|--------|------|
| 101+17.7 | 21 S | CB |
| 102+63 | 21 S | CB |

| STA. | DIA. (IN.) | LIN. FT. |
|-------|------------|----------|
| 95+49 | 10" | 52 |

DATE: _____
 BY: _____
 CHECKED: _____
 DATE: _____

EXISTING

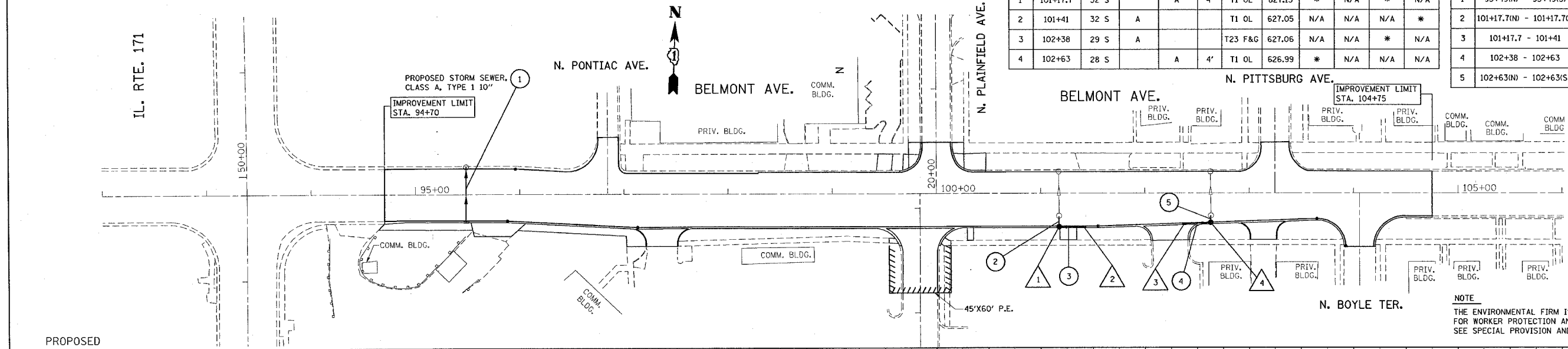

| NO | STATION | OFFSET (FT.) | STRUCTURE TYPE | | DIA. | FRAME | TOP OF GRATE (TOG) | (N) INVERT | (S) INVERT | (E) INVERT | (W) INVERT |
|----|----------|--------------|----------------|----|------|---------|--------------------|------------|------------|------------|------------|
| | | | INLET | CB | | | | | | | |
| 1 | 101+17.7 | 32 S | | A | 4' | TI OL | 627.13 | * | N/A | * | N/A |
| 2 | 101+41 | 32 S | | A | | TI OL | 627.05 | N/A | N/A | N/A | * |
| 3 | 102+38 | 29 S | | A | | T23 F&G | 627.06 | N/A | N/A | * | N/A |
| 4 | 102+63 | 28 S | | A | 4' | TI OL | 626.99 | * | N/A | N/A | N/A |

| NO | STATION - STATION | TYPE | DIA. (IN.) | LIN. FT. | TB (CU.YD.) | SLOPE FT/FT |
|----|---------------------------|-------|------------|----------|-------------|-------------|
| | | | | | | |
| 2 | 101+17.7(N) - 101+17.7(S) | 1 RCP | 10" | 11 | 3.6 | ** |
| 3 | 101+17.7 - 101+41 | 1 RCP | 8" | 23.3 | 7.4 | ** |
| 4 | 102+38 - 102+63 | 1 RCP | 8" | 22 | 7.0 | ** |
| 5 | 102+63(N) - 102+63(S) | 1 RCP | 10" | 7 | 2.3 | ** |

* STRUCTURE FILLED WITH WATER INVERT TO BE DETERMINED BY THE ENGINEER IN FIELD ONCE STRUCTURE IS CLEANED
 ** TO BE DETERMINED BY ENGINEER ONCE STRUCTURES ARE CLEANED

DATE: _____
 BY: _____
 CHECKED: _____
 DATE: _____

PROPOSED

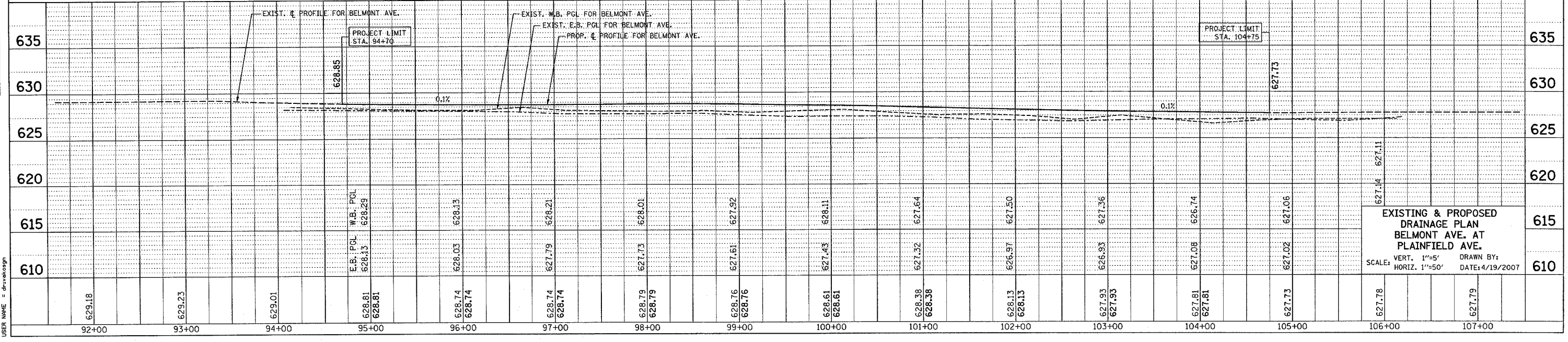

NOTE: THE ENVIRONMENTAL FIRM IS REQUIRED TO CONTINUOUSLY MONITOR FOR WORKER PROTECTION AND SOIL CONTAMINATION AT SEVERAL AREAS. SEE SPECIAL PROVISION AND SPECIFICATIONS FOR DETAILS.

EXISTING & PROPOSED DRAINAGE PLAN BELMONT AVE. AT PLAINFIELD AVE.
 VERT. 1"=5' DRAWN BY: DATE: 4/19/2007
 HORIZ. 1"=50'