

F.A.P. RTE.	SECTION	COUNTY	TOTAL SHEETS	SHEET NO.
353	(12&13) RS-12	WILL	17	1

+2  
19

D-91-303-07

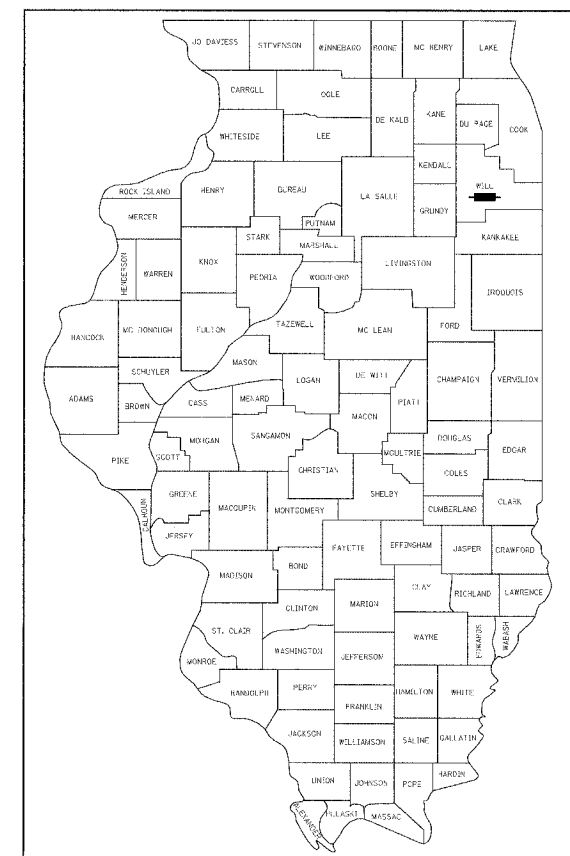

LOCATION OF SECTION INDICATED THUS: - ■ -

**INDEX OF SHEETS**

SHEET NO.	DESCRIPTION
1	COVER SHEET
2	SUMMARY OF QUANTITIES
3-5	TYPICAL SECTIONS
6-9	ROADWAY PLANS AND PAVEMENT MARKINGS
10	DETAILS FOR FRAMES AND LIDS ADJUSTMENT WITH MILLING (BD-2)
11	PAVEMENT PATCHING FOR HMA SURFACED PAVEMENT (BD-22)
11A	CURB OR CURB AND GUTTER REMOVAL AND REPLACEMENT (BD-24)
12	BUTT JOINT AND HMA TAPER DETAILS (BD-32)
12A	METHOD OF FLAGGING (BM-14)
13	TRAFFIC CONTROL AND PROTECTION FOR SIDE ROADS, INTERSECTIONS, AND DRIVEWAYS (TC-10)
14	TYPICAL APPLICATIONS RAISED REFLECTIVE PAVEMENT MARKERS (SNOW-PLow RESISTANT) (TC-11)
15	DISTRICT ONE TYPICAL PAVEMENT MARKINGS (TC-13)
16	PAVEMENT MARKING LETTERS AND SYMBOLS FOR TRAFFIC STAGING (TC-16)
17	ARTERIAL ROAD INFORMATION SIGNING (TC-22)

**STATE STANDARDS**

STANDARD NO.	DESCRIPTION
000001-04	STANDARD SYMBOLS, ABBREVIATIONS AND PATTERNS
442201-02	CLASS C AND D PATCHES
701011-01	OFF-RD MOVING OPERATIONS, 2L, 2W, DAY ONLY
701201-02	LANE CLOSURE, 2L, 2W, DAY ONLY, FOR SPEEDS >=45 MPH
701301-02	LANE CLOSURE, 2L, 2W, SHORT TIME OPERATIONS
701306-01	LANE CLOSURE, 2L, 2W, SLOW MOVING OPERATIONS DAY ONLY, FOR SPEEDS >= 45 MPH
701311-02	LANE CLOSURE, 2L, 2W, MOVING OPERATIONS-DAY ONLY
701501-03	URBAN LANE CLOSURE, 2L, 2W, UNDIVIDED
701502-01	URBAN LANE CLOSURE, 2L, 2W, WITH BIDIRECTIONAL LEFT TURN LANE
702001-06	TRAFFIC CONTROL DEVICES
780001-01	TYPICAL PAVEMENT MARKINGS
781001-02	TYPICAL APPLICATIONS RAISED REFLECTIVE PAVEMENT MARKERS

**PROJECT IS LOCATED IN VILLAGE OF FRANKFORT**

**TRAFFIC DATA**

U. S. RTE 30	ADT ( 2000 )	POSTED SPEED
LOCATION 1		
ELSNER TO HACKBERRY	16,000	45
HACKBERRY TO ELM	16,000	40
LOCATION 2		
BOTH TO 78TH	15,000	40
78TH TO PLANK TRAIL DR.	15,000	45
PLANK TRAIL DR. TO IL RTE 43	15,000	55

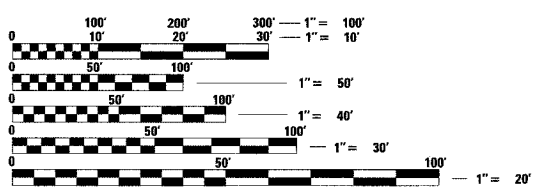

FULL SIZE PLANS HAVE BEEN PREPARED USING STANDARD ENGINEERING SCALES. REDUCED SIZED PLANS WILL NOT CONFORM TO STANDARD SCALES. IN MAKING MEASUREMENTS ON REDUCED PLANS, THE ABOVE SCALES MAY BE USED.

J.U.L.I.E.  
JOINT UTILITY LOCATION INFORMATION FOR EXCAVATION  
1-800-892-0123

**CONTRACT NO. 60D08**

**STATE OF ILLINOIS  
DEPARTMENT OF TRANSPORTATION  
DIVISION OF HIGHWAYS**

**PROPOSED  
HIGHWAY PLANS**

**F.A.P. 353 / U.S. 30 (LINCOLN HWY.)  
1) ELSNER RD. TO ELM ST.  
2) 80TH AVE. TO WEST OF ILL 43  
RESURFACING (MAINTENANCE)  
SECTION: (12 & 13) RS-12  
WILL COUNTY  
C-91-303-07**

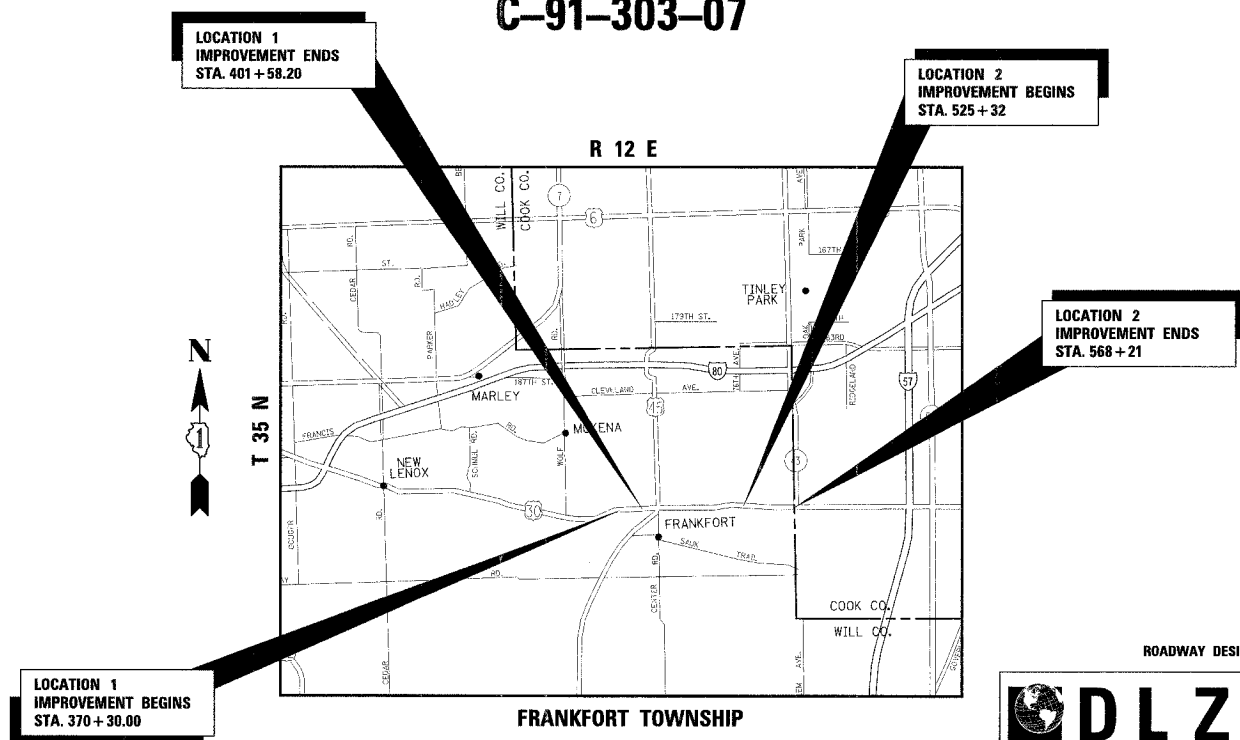

**LOCATION 1  
IMPROVEMENT BEGINS  
STA. 370+30.00**

**LOCATION 1  
IMPROVEMENT ENDS  
STA. 401+58.20**

**LOCATION 2  
IMPROVEMENT BEGINS  
STA. 525+32**

**LOCATION 2  
IMPROVEMENT ENDS  
STA. 568+21**

**LOCATION 1: GROSS LENGTH PROJECT = 3128.2 FEET = 0.592 MILES  
NET LENGTH PROJECT = 3128.2 FEET = 0.592 MILES  
LOCATION 2: GROSS LENGTH PROJECT = 4289 FEET = 0.812 MILES  
NET LENGTH PROJECT = 4289 FEET = 0.812 MILES**

ROADWAY DESIGNED BY

**DLZ** 85 W. ALGONQUIN, SUITE 220  
ARLINGTON HEIGHTS, IL 60005  
(847) 640-0840

STATE OF ILLINOIS  
Gregory R. Brumm  
049218  
REGISTERED PROFESSIONAL ENGINEER

SIGNATURE: *Gregory R. Brumm*

SEAL  
11-30-07  
EXPIRES

STATE OF ILLINOIS  
DEPARTMENT OF TRANSPORTATION  
DIVISION OF HIGHWAYS

SUBMITTED April 18 2007

*Diane O'Keefe* DISTRICT ENGINEER

May 11, 2007  
*Eric E. Haran* INTERIM ENGINEER OF DESIGN AND ENVIRONMENT

May 11, 2007  
*Milton P. Seay, P.E.* DIRECTOR, DIVISION OF HIGHWAYS

**PRINTED BY THE AUTHORITY  
OF THE STATE OF ILLINOIS**

CONSULTANT SERVICES SECTION DISTRICT ONE - DESIGN / JOSE DOMINGUEZ (847) 705 - 4385