

CONTRACT NO. 60D08				
F.A.P. RTE.	SECTION	COUNTY	TOTAL SHEETS	SHEET NO.
353 (12&13)	RS-12	WILL	17	7
STA. 374+00		TO STA. 404+00		
FED. ROAD DIST. NO.	ILLINOIS	FED. AID PROJECT		

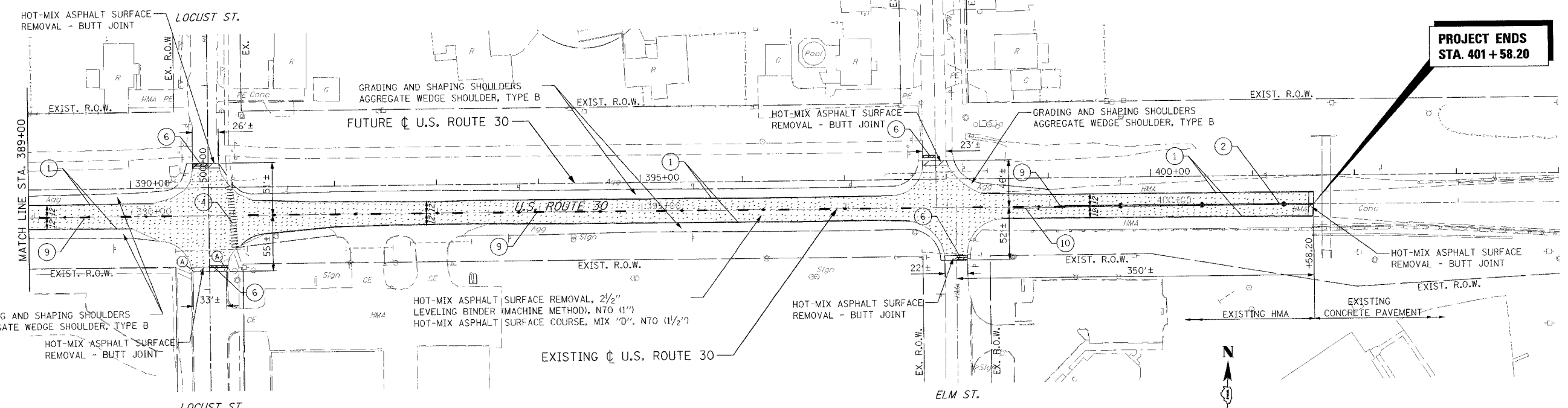
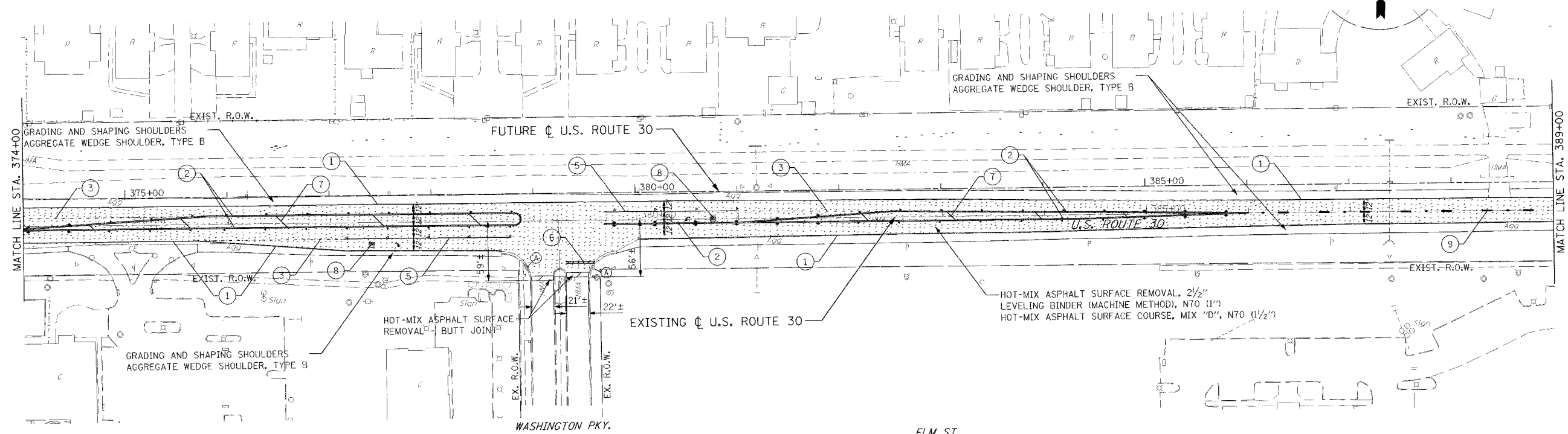

- LEGEND**
- HOT-MIX ASPHALT SURFACE REMOVAL - BUTT JOINT
 - HOT-MIX ASPHALT SURFACE REMOVAL, 2 1/2"
 - TWO-WAY AMBER RAISED REFLECTIVE PAVEMENT MARKER
 - ONE-WAY AMBER RAISED REFLECTIVE PAVEMENT MARKER
 - ONE-WAY CRYSTAL RAISED REFLECTIVE PAVEMENT MARKER
 - FRAMES AND LIDS TO BE ADJUSTED (SPECIAL)

- PAVEMENT MARKING LEGEND**
- ① 4" SINGLE SOLID LINE (Y)
 - ② 4" DOUBLE SOLID LINE (Y) (11" C-C)
 - ③ 6" DOTTED LINE (W) (2' LINE - 6' SPACE)
 - ④ 12" SOLID LINES CROSSWALK (W)
 - ⑤ 6" SOLID LINE (W)
 - ⑥ 24" SOLID STOP BAR (W)
 - ⑦ 12" SOLID LINE (Y) (DIAGONALS)
 - ⑧ LETTERS AND SYMBOLS
 - ⑨ 4" CENTERLINE (Y) (10' LINE - 30' SPACE)
 - ⑩ 4" SOLID NO PASSING ZONE LINE (Y)
 - ⑪ 12" SOLID LINES CROSSWALK (W) (DIAGONALS)

REVISIONS	
NAME	DATE

ILLINOIS DEPARTMENT OF TRANSPORTATION
ROADWAY PLANS & PAVEMENT MARKING
U.S. RTE. 30 (LINCOLN HIGHWAY)
STA. 374+00 TO STA. 404+00
SCALE: 1" = 50' DRAWN BY: BAE
DATE: / / CHECKED BY:

