

F.A.P. RTE.	SECTION	COUNTY	TOTAL SHEETS	SHEET NO.
326	107RS-2	KANE	31	18
STA.		TO STA.		
FED. ROAD DIST. NO. 7		ILLINOIS FED. AID PROJECT		

CONTRACT NO.: 62751

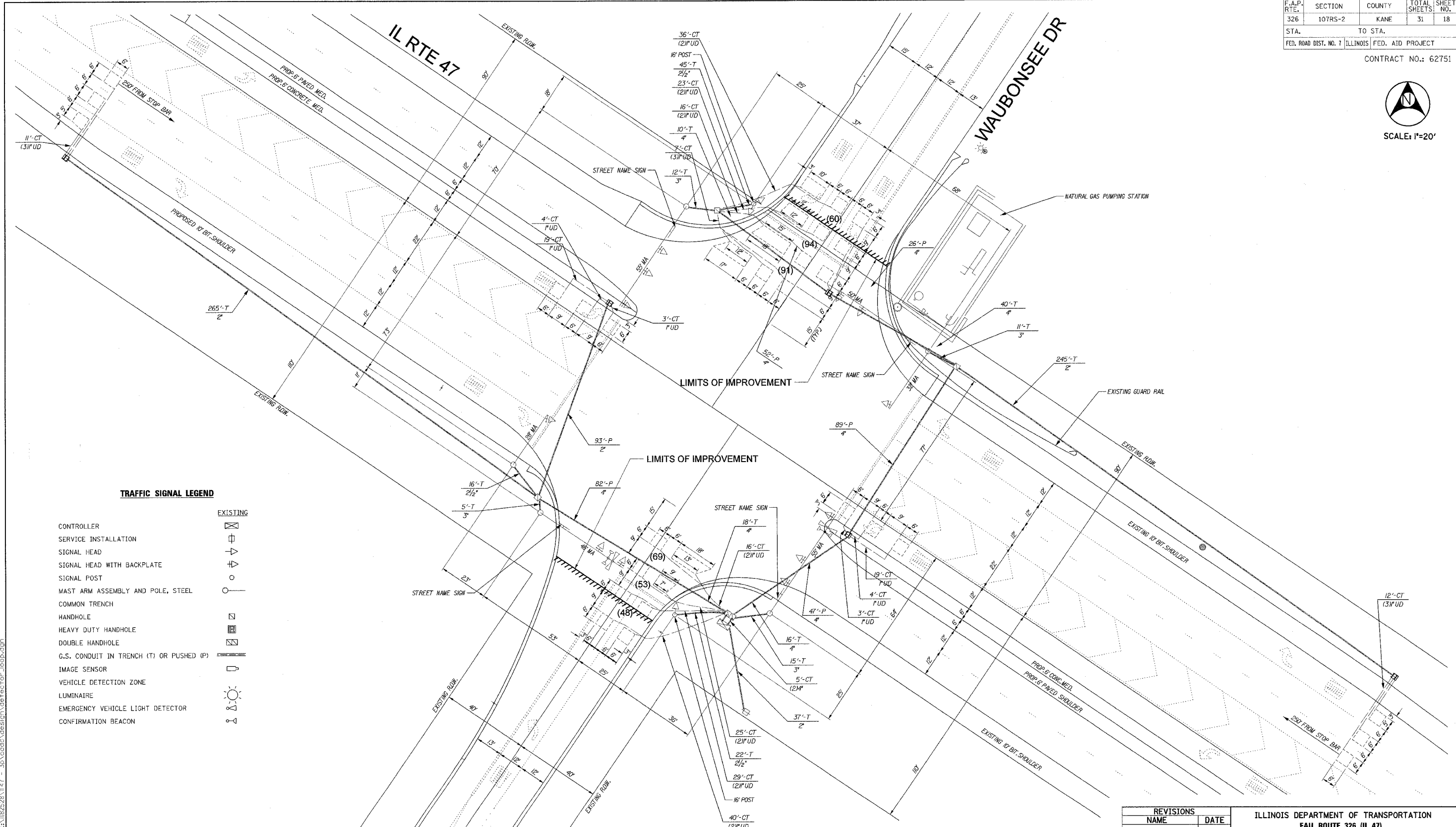

SCALE: 1"=20'



**TRAFFIC SIGNAL LEGEND**

CONTROLLER		EXISTING
SERVICE INSTALLATION		
SIGNAL HEAD		
SIGNAL HEAD WITH BACKPLATE		
SIGNAL POST		
MAST ARM ASSEMBLY AND POLE, STEEL		
COMMON TRENCH		
HANDHOLE		
HEAVY DUTY HANDHOLE		
DOUBLE HANDHOLE		
G.S. CONDUIT IN TRENCH (T) OR PUSHED (P)		
IMAGE SENSOR		
VEHICLE DETECTION ZONE		
LUMINAIRE		
EMERGENCY VEHICLE LIGHT DETECTOR		
CONFIRMATION BEACON		

**REPLACE ALL DETECTOR LOOPS AS SHOWN**

(WITHIN THE RESURFACING LIMITS)

CODE NO.	QUANTITY	UNIT	ITEM
86600600	415	FOOT	DETECTOR LOOP REPLACEMENT

**NOTE:**

THIS PLAN IS FOR THE PURPOSE OF REPLACING THE DETECTOR LOOPS ONLY. ALL OTHER INFORMATION SHOWN IS NOT RELATED AND WILL BE DISREGARDED.

REVISIONS	
NAME	DATE

ILLINOIS DEPARTMENT OF TRANSPORTATION  
 FAU ROUTE 326 (IL 47)  
 GALENA BLVD TO SEAVEY RD  
**DETECTOR LOOP REPLACEMENT**  
**IL RTE. 47 - WAUBONSEE DR.**

SCALE: VERT.  
 HORIZ.  
 DATE: March 23, 2007

DRAWN BY  
 CHECKED BY

3/23/2007 10:52:33 AM k:\1182528\1147 - 30\code\design\detector\_loop.dgn