

F.A.U. RTE.	SECTION	COUNTY	TOTAL SHEETS	SHEET NO.
2946	3368 A-N	COOK	74	20
STA. 209+22		TO STA. 219+00		
FED. ROAD DIST. NO.		ILLINOIS FED. AID PROJECT		

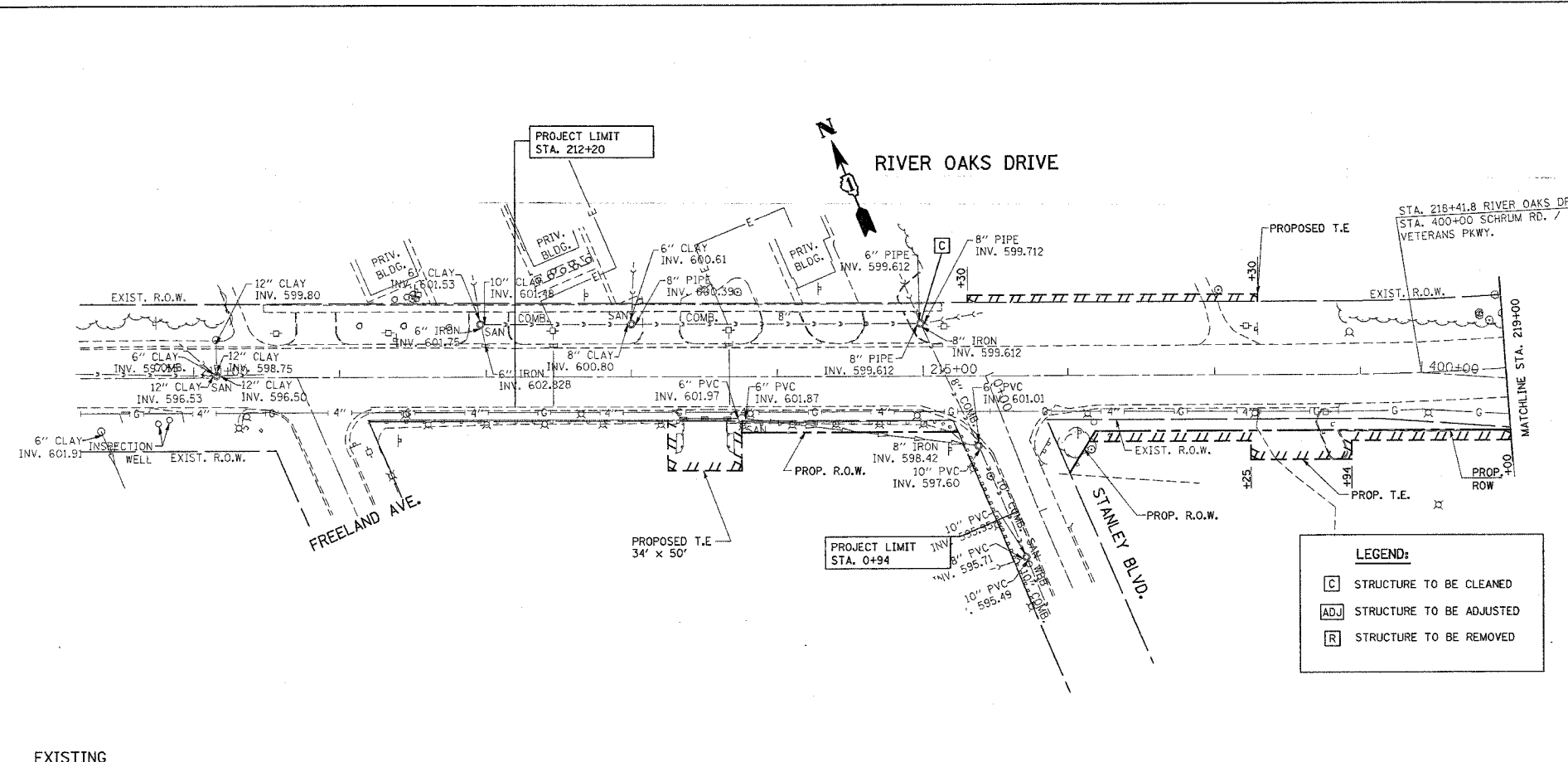

EXISTING

PROPOSED

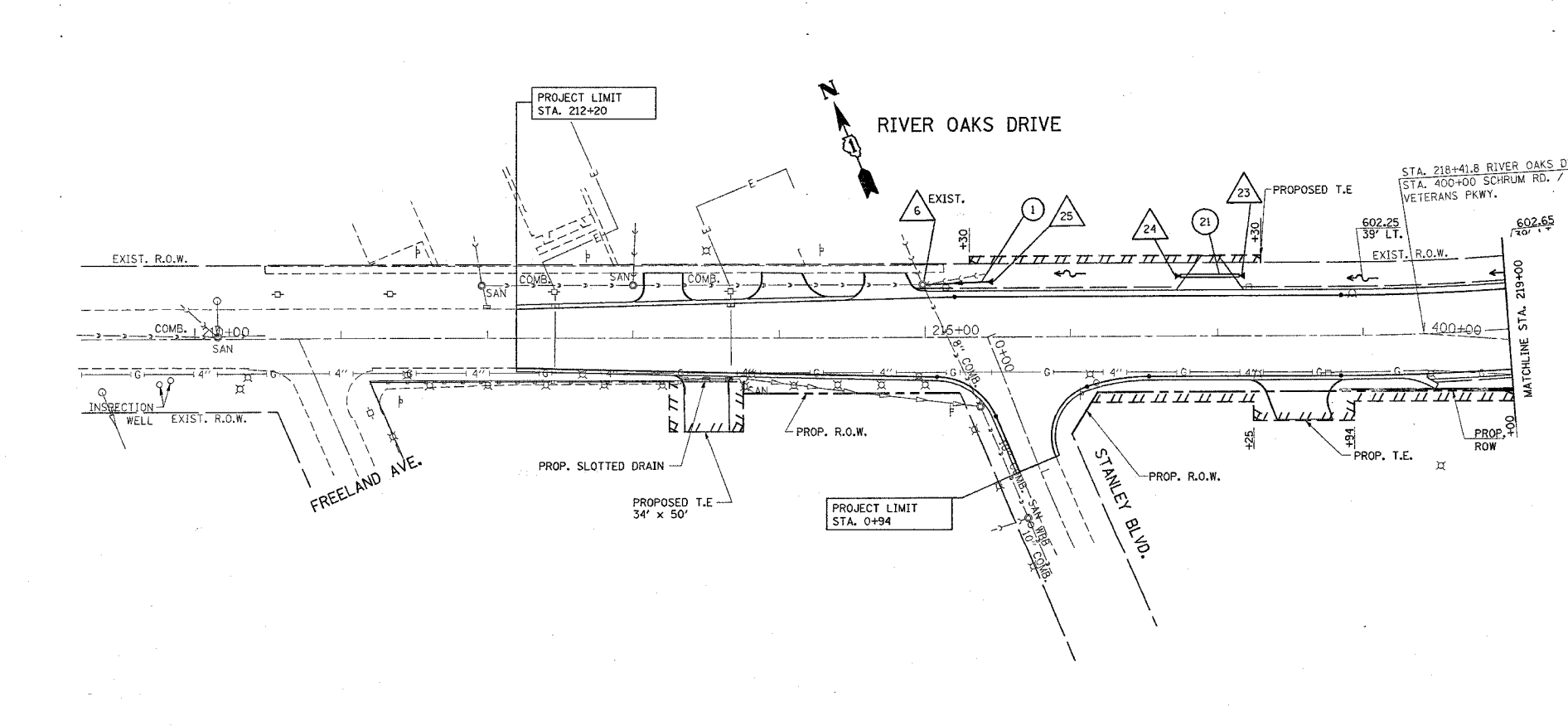

PROPOSED

NO.	STATION	OFFSET (FT)	STRUCTURE TYPE			DIA.	FRAME	TOP OF GRATE	INVERT	INVERT	INVERT	INVERT
			MH	CB	FES							
1	313+25	36 W	TA			4'	T1 CL	605.00	597.82(W)	597.72(S)		
** 2	312+01	26 E	TA *			5'	T1 CL	603.90	596.31(NE)	596.21(SW)		
3	312+20	35 E	TA *			6'	T1 CL	604.00	596.71(NW)	596.71(N)	596.61(S)	
4	228+71	35 S	TA *			4'	T1 CL	603.50	599.96(W)	600.06(E)	600.78(NE)	
5	311+61	0 W	EXIST.				EXIST. NEW T1 CL	604.00	595.58(NE)			
6	214+99	36 N	EXIST.				EXIST. EXIST.	605.40	599.73(E)			
7	312+45	35 W	TA *			4'	T1 CL	604.15	597.30(N)	597.20(SE)	601.90(NE)	
8	315+42	41 E	TA *			4'	T1 CL	605.00	601.10(S)	601.20(W)	601.92(N)	
9	224+96	37 S	TA *			8'	T1 CL	604.90	597.84(S)	597.94(E)	597.94(N)	601.64(SW)
10	314+78	36 E	TA *			6'	T1 CL	605.00	598.63(S)	600.41(N)	602.43(SE)	
11	312+18	25 E	EXIST.				EXIST. NEW T1 CL	603.90	602.18(W)			
12	230+44	23 S	TC			2'	T23 F&G	603.20	601.15			
13	228+76	27 S	TC			2'	T23 F&G	603.20	600.87			
14	226+67	36 S	TA *			5'	T1 CL	604.20	599.00(E)	598.90(W)	600.44(N)	
15	226+72	28 S	TC			2'	T23 F&G	603.40	600.53			
16	230+38	35 S	TA *			4'	T1 CL	603.90	600.95(E)	600.85(W)	601.05(N)	
17	313+34	28 E	TC			2'	T23 F&G	604.90	601.86(NE)			
18	231+00	32 S			FES	12"		603.30	601.23			
19	315+57	41 E			FES	12"			602.18			
20	314+41	51 E	TC			2'	T23 F&G	605.00	602.80			
21	315+42	37 W			FES	12"			602.23			
22	314+36	145 W			FES	15"			599.57			
23	216+75	41 N			FES	24"			601.95			
24	217+15	41 N			FES	24"			601.79			
25	215+41	37 N			FES	12"			601.15			
26	312+54	26 W	TC			2'	T23 F&G	604.3	602.05			

\* FLAT SLAB TOP  
 \*\* MANHOLE WITH RESTRICTOR PLATE, SEE DIST. DETAIL, BD-12

NO.	STATION - STATION	TYPE	DIA. (IN.)	LIN. FT.	TB CU. YD.	FL. END SECTION EACH	SLOPE FT./FT.
1	214+99 - 215+41	1	12"	42		1	0.03
2	313+18 - 314+36	1	15"	155	36	1	0.011
3	312+52 - 313+18	1	15"	76			0.006
4	312+20 - 312+45	1	15"	70	68.5		0.007
5	311+61 - 312+01	1	24"	43	58.5		0.015
* 6	315+33(E) - 315+33(W)	1	12"	76	14	1	0.014
7	314+78 - 315+42	1	15"	59			0.012
8	313+61 - 314+78	1	36"	110	108		0.006
9	312+20 - 313+61	1	36"	134	161		0.008
10	312+01 - 312+20	1	24"	19	24		0.016
11	224+96 - 226+67	1	24"	165			0.006
12	226+67 - 228+71	1	15"	193	23		0.005
13	228+71 - 228+76	1	12"	6			0.015
14	226+67 - 226+72	1	12"	6			0.015
15	228+71 - 230+38	1	15"	158			0.005
16	230+38 - 230+44	1	12"	10			0.01
17	313+34 - 313+61	1	12"	22			0.01
18	230+38 - 231+00	1	12"	55		1	0.005
19	315+33 - 315+50	1	12"	17		1	0.015
20	314+41 - 314+78	1	12"	37			0.01
** 21	216+75 - 217+15	1	24"	40	10	2	0.004
22	312+45 - 312+61	1	12"	13			0.011

\* STORM SEWER WATER MAIN REQUIREMENT  
 \*\* PIPE CULVERT CLASS A, TYPE 1

NO.	NAME	DATE

ILLINOIS DEPARTMENT OF TRANSPORTATION  
**RIVER OAKS DRIVE  
 EXISTING & PROPOSED  
 DRAINAGE & UTILITY PLAN**  
 SCALE: VERT. 1"=50'  
 HORIZ. 1"=50'  
 DATE 3/27/2007  
 DRAWN BY  
 CHECKED BY

PLOT DATE = 3/27/2007  
 FILE NAME = c:\projects\62915\rd\62915.dwg  
 USER NAME = ltscherf