

F.A.P. RTE.	SECTION	COUNTY	TOTAL SHEETS	SHEET NO.
734	(4MFT)R	WINNEBAGO	353	90
STA.		TO STA.		
FED. ROAD DIST. NO.		ILLINOIS FED. AID PROJECT		

STAGE 2

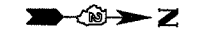

PLACED AS DIRECTED BY ENGINEER

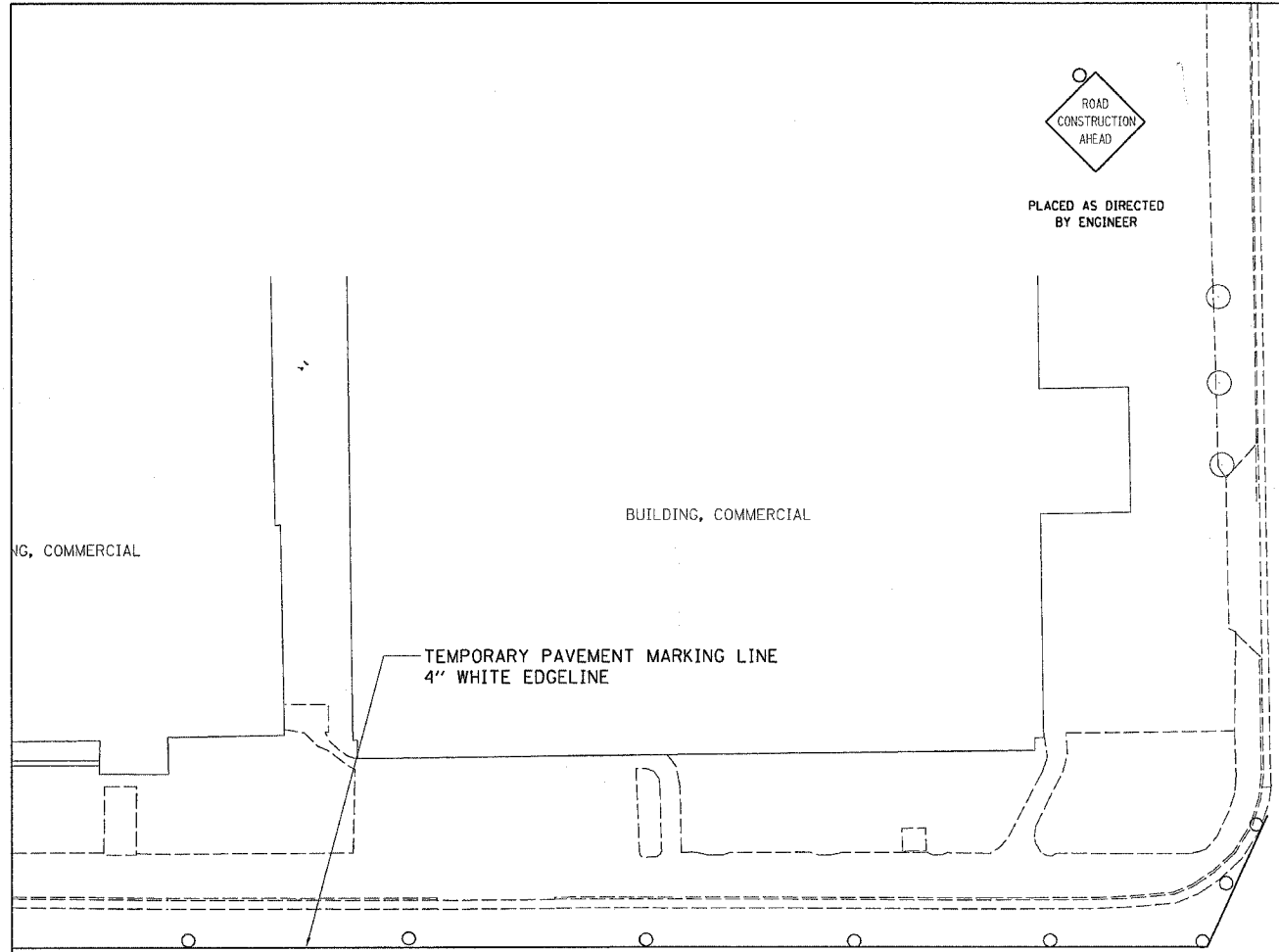

414 | 415+00 | 416 | 417

18TH ST

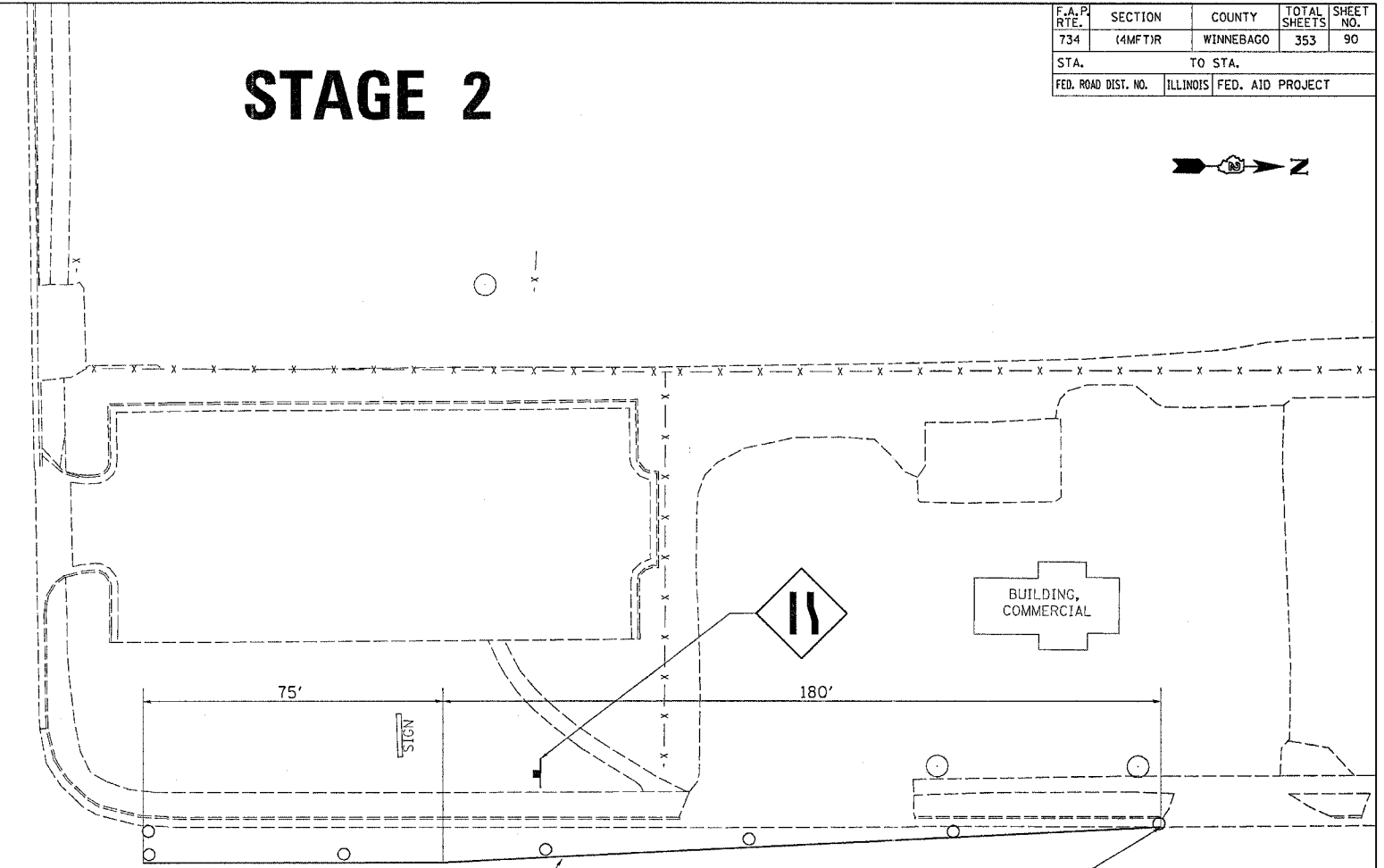

418 | 419 | 420+00

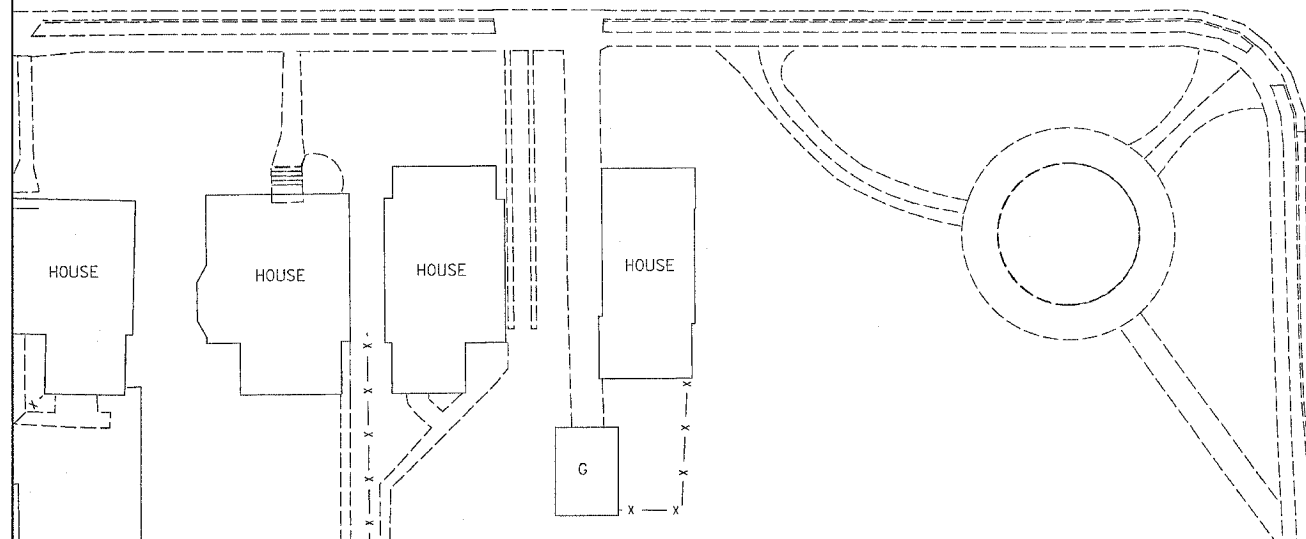

LEGEND

- FLEXIBLE DELINATOR
- ⊠ STAGE 2 CONSTRUCTION
- ⌄ VERTICAL PANEL
- ➡ ARROW BOARD
- ↔ DIRECTION OF TRAFFIC
- DRUM OR BARRICADE W/ STEADY BURN LIGHT SIGN
- ⊠ TYPE III BARRICADE W/ FLASHING LIGHTS
- ◇ SIGN FLAG

18TH ST

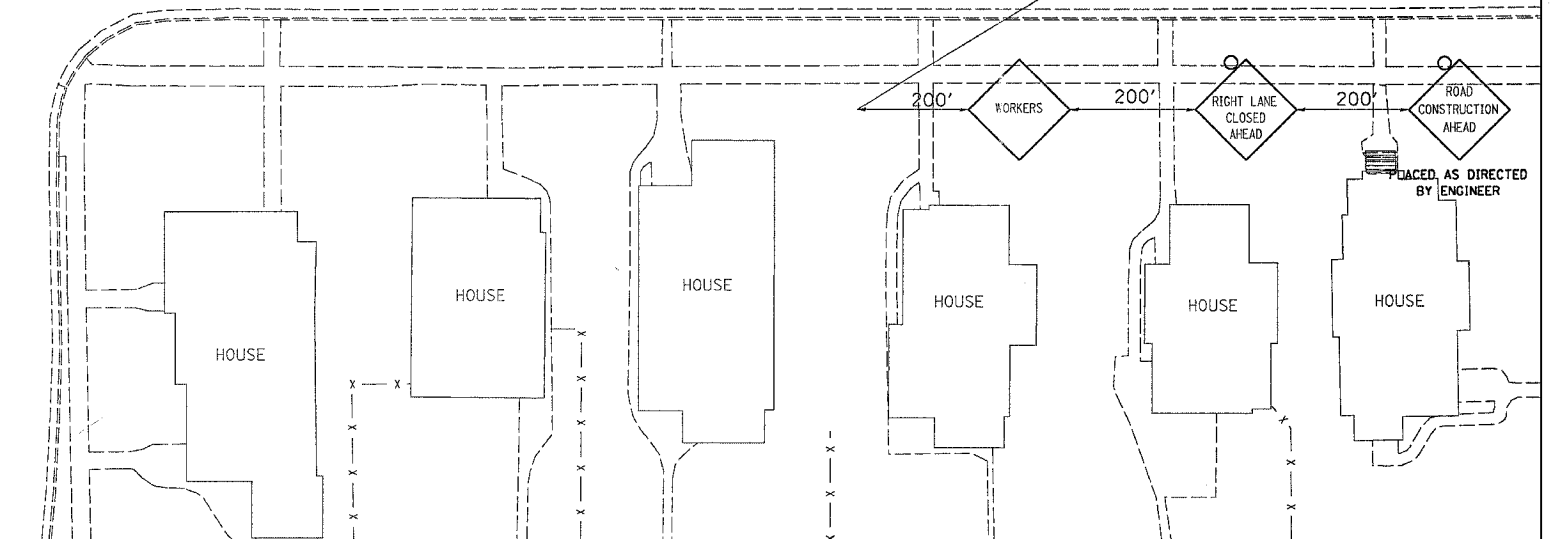

USE TRAFFIC CONTROL AND PROTECTION STD 94.2 FOR TURN BAYS

USE TRAFFIC CONTROL AND PROTECTION STD 701606 FOR LANE CLOSURE.

PLOT DATE = Fri Apr 27 16:38:46 2007
 FILE NAME = c:\prowork\121699\121699.dwg
 USER = jg
 PLOT SCALE = 1"=200'