

F.A.P. RTE.	SECTION	COUNTY	TOTAL SHEETS	SHEET NO.
734	(4MFT)R	WINNEBAGO	353	235
STA.		TO STA.		
FED. ROAD DIST. NO.		ILLINOIS	FED. AID PROJECT	

SUGGESTED TEMPORARY SIGNALS KISHWAUKEE AT HARRISON

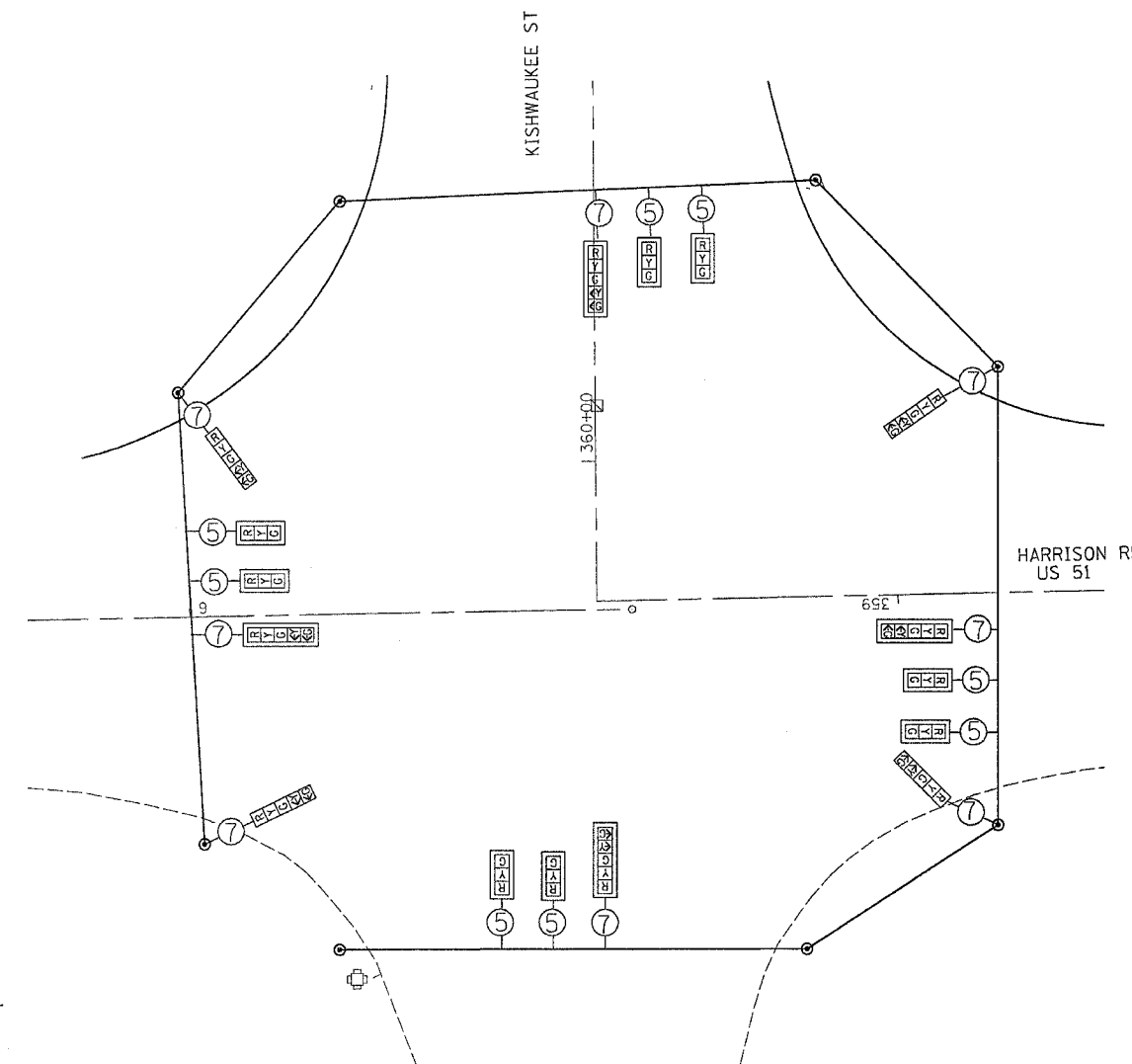

PHASE DESIGNATION DIAGRAM

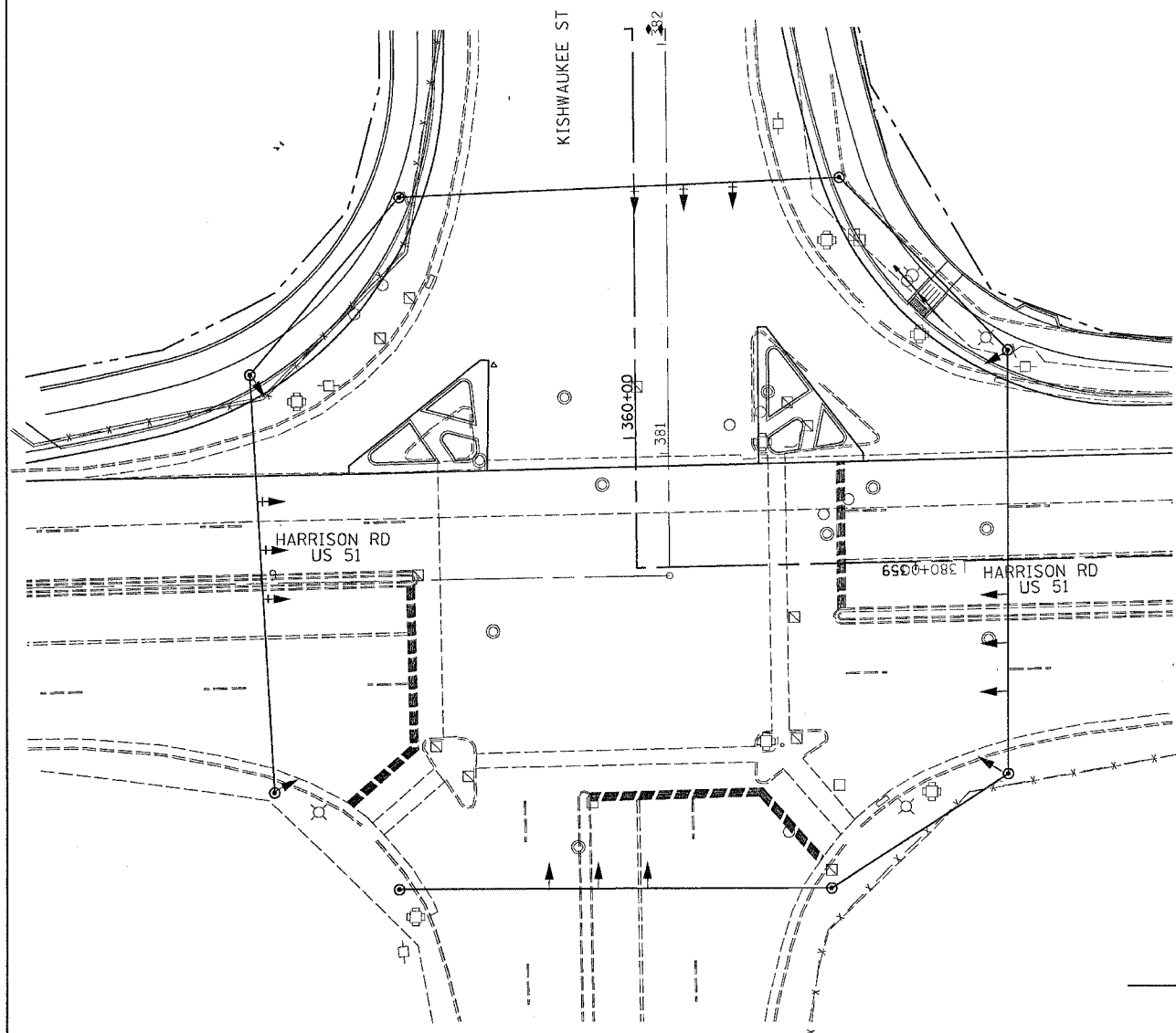
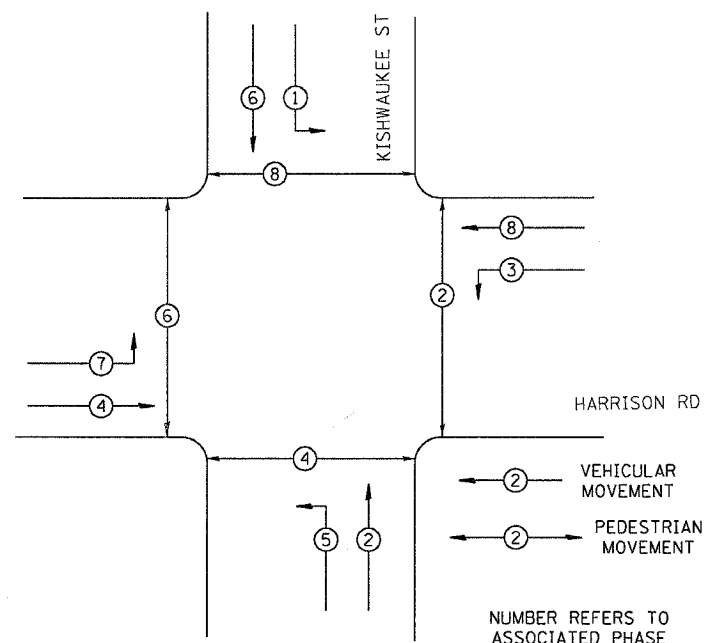

REFER TO STANDARD 857001

NOTE:
STAGING OF TEMPORARY SIGNAL INSTALLATION SHALL BE APPROVED BY THE RESIDENT ENGINEER.

PLT DATE = Mon Apr 30 10:38:46 2007
FILE NAME = c:\projects\14210399\vol188\sig.dgn
PLT SCALE = 20.0000 / IN.
USER NAME = grandpa

REVISIONS		ILLINOIS DEPARTMENT OF TRANSPORTATION
NAME	DATE	
		SCALE: VERT. HORIZ. DATE