

F.A.P. RTE.	SECTION	COUNTY	TOTAL SHEETS	SHEET NO.
*	**	CARROLL	548	94
STA. TO STA.		ILLINOIS FED. AID PROJECT		
FED. ROAD DIST. NO.		* ROUTE 17 (US 52 / IL 64)		
		** (1-2RS & 3-1RS-1)		
JAMES MANNING				

DATE	
BY	
PLAN	
REVIEWED	
PLOTTED	
NOTE BOOK	
NO.	

DATE-TIME*	
UDN-SPEC*	
REF	
REF	
REF	
REF	

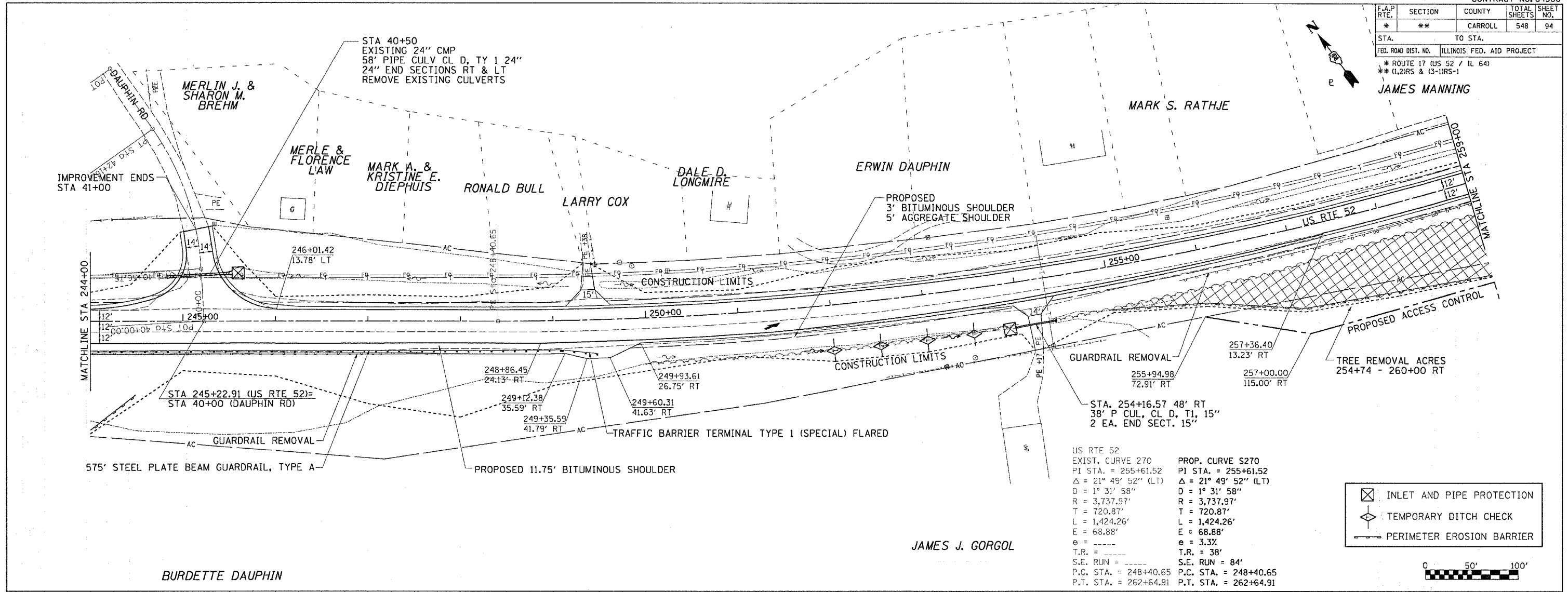

US RTE 52 EXIST. CURVE 270 PI STA. = 255+61.52 Δ = 21° 49' 52" (LT) D = 1° 31' 58" R = 3,737.97' T = 720.87' L = 1,424.26' E = 68.88' e = ---- T.R. = ---- S.E. RUN = ----	<td>PROP. CURVE S270 PI STA. = 255+61.52 Δ = 21° 49' 52" (LT) D = 1° 31' 58" R = 3,737.97' T = 720.87' L = 1,424.26' E = 68.88' e = 3.3% T.R. = 38' S.E. RUN = 84'</td>	PROP. CURVE S270 PI STA. = 255+61.52 Δ = 21° 49' 52" (LT) D = 1° 31' 58" R = 3,737.97' T = 720.87' L = 1,424.26' E = 68.88' e = 3.3% T.R. = 38' S.E. RUN = 84'
P.C. STA. = 248+40.65	P.C. STA. = 248+40.65	
P.T. STA. = 262+64.91	P.T. STA. = 262+64.91	

- ⊠ INLET AND PIPE PROTECTION
- ◇ TEMPORARY DITCH CHECK
- PERIMETER EROSION BARRIER

