

F.A.P. RTE.	SECTION	COUNTY	TOTAL SHEETS	SHEET NO.
*	**	CARROLL	548	113
STA.		TO STA.		
FED. ROAD DIST. NO.		ILLINOIS	FED. AID PROJECT	
* ROUTE 17 (US 52 / IL 64)				
** (1,2)RS & (3-1)RS-1				

LYLE H. & ROBERT J. HARTMAN

DR. RICHARD NG

OLD 52 W
 EXIST. CURVE 1270
 PI STA. = 1200+79.21
 $\Delta = 20^\circ 39' 11''$ (RT)
 $D = 29^\circ 04' 18''$
 $R = 197.09'$
 $T = 35.91'$
 $L = 71.04'$
 $E = 3.24'$
 $\theta = \text{---}$
 $T.R. = \text{---}$
 $S.E. RUN = \text{---}$
 $P.C. STA. = 1200+43.30$
 $P.T. STA. = 1201+14.34$

PROP. CURVE 52260
 PI STA. = 1202+01.70
 $\Delta = 25^\circ 18' 49''$ (RT)
 $D = 18^\circ 47' 08''$
 $R = 305.00'$
 $T = 68.49'$
 $L = 134.75'$
 $E = 7.60'$
 $\theta = \text{---}$
 $T.R. = \text{---}$
 $S.E. RUN = \text{---}$
 $P.C. STA. = 1201+33.20$
 $P.T. STA. = 1202+67.95$

IMPROVEMENT ENDS
STA 1202+67.95

STA. 1200+43
 41" PIPE CULVERT, CL D. TY 1, 24"
 24" END SECTIONS RT & LT
 1 EA. REMOVE EXISTING CULVERT

DATE	
BY	
PLAN	
DATE	
BY	
PROFILE	
DATE	
BY	

DATE	
BY	
PROFILE	
DATE	
BY	

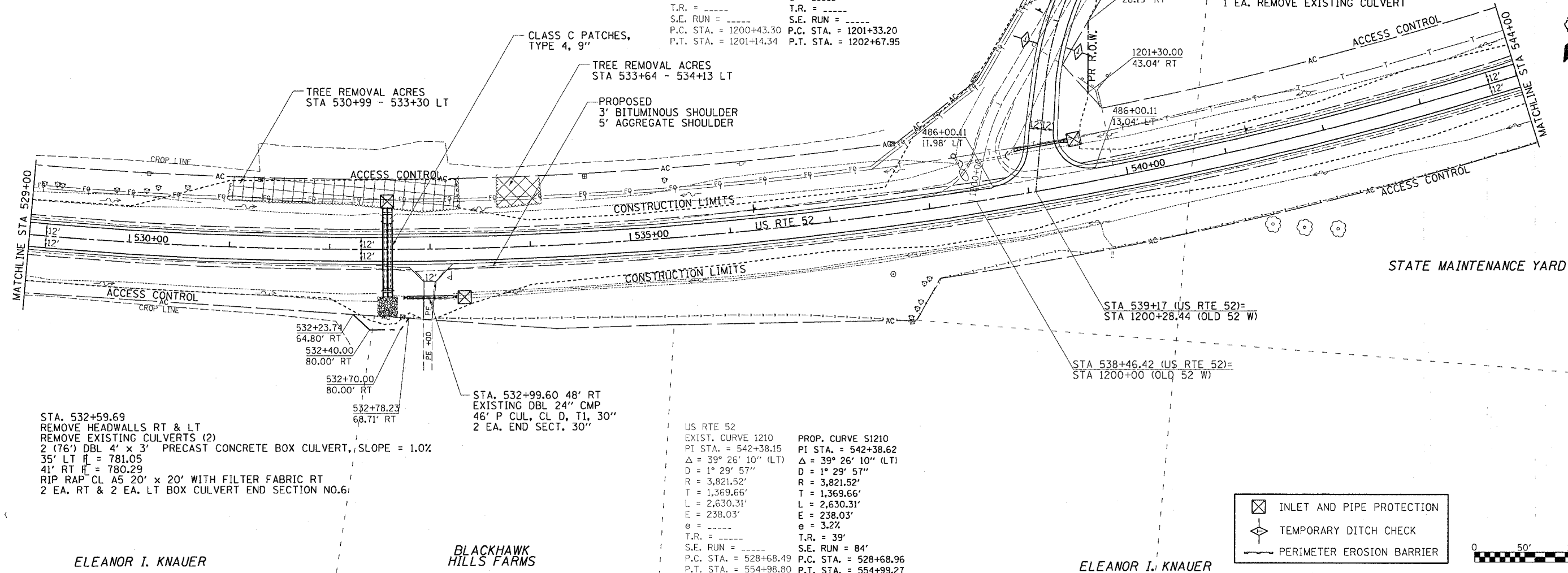

STA. 532+59.69
 REMOVE HEADWALLS RT & LT
 REMOVE EXISTING CULVERTS (2)
 2 (76") DBL 4' x 3' PRECAST CONCRETE BOX CULVERT, SLOPE = 1.0%
 35' LT $H = 781.05$
 41' RT $H = 780.29$
 RIP RAP CL A5 20' x 20' WITH FILTER FABRIC RT
 2 EA. RT & 2 EA. LT BOX CULVERT END SECTION NO.6

STA. 532+99.60 48' RT
 EXISTING DBL 24" CMP
 46' P CUL, CL D, T1, 30"
 2 EA. END SECT. 30"

US RTE 52
 EXIST. CURVE 1210
 PI STA. = 542+38.15
 $\Delta = 39^\circ 26' 10''$ (LT)
 $D = 1^\circ 29' 57''$
 $R = 3,821.52'$
 $T = 1,369.66'$
 $L = 2,630.31'$
 $E = 238.03'$
 $\theta = \text{---}$
 $T.R. = \text{---}$
 $S.E. RUN = \text{---}$
 $P.C. STA. = 528+68.49$
 $P.T. STA. = 554+98.80$

PROP. CURVE S1210
 PI STA. = 542+38.62
 $\Delta = 39^\circ 26' 10''$ (LT)
 $D = 1^\circ 29' 57''$
 $R = 3,821.52'$
 $T = 1,369.66'$
 $L = 2,630.31'$
 $E = 238.03'$
 $\theta = 3.2\%$
 $T.R. = 39'$
 $S.E. RUN = 84'$
 $P.C. STA. = 528+68.96$
 $P.T. STA. = 554+99.27$

ELEANOR I. KNAUER

BLACKHAWK HILLS FARMS

ELEANOR I. KNAUER

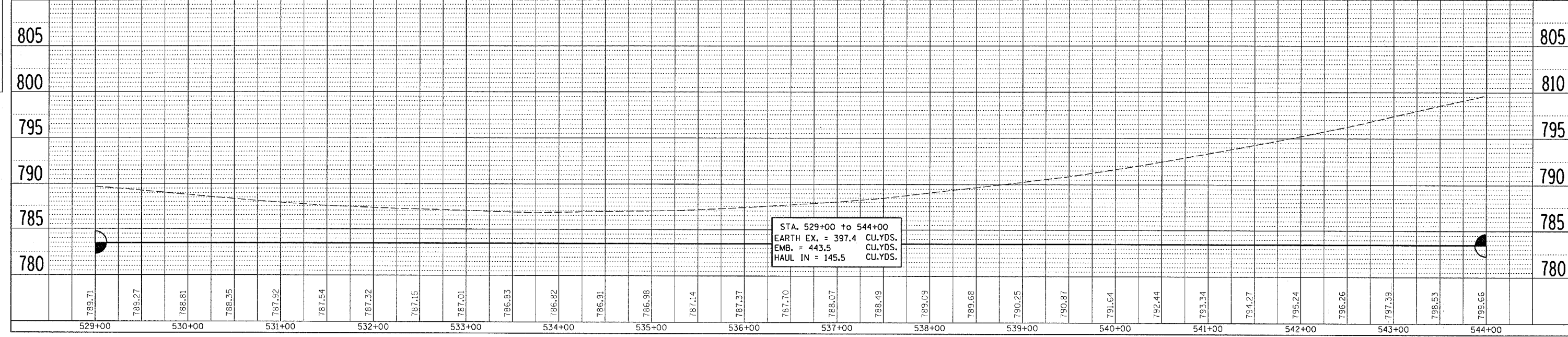
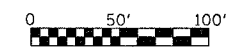
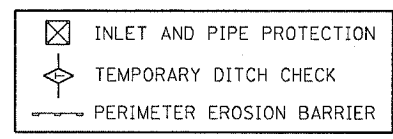

DATE TIME
 REF SPEC
 REF
 REF
 REF