

F.A.P. RTE.	SECTION	COUNTY	TOTAL SHEETS	SHEET NO.
*	**	CARROLL	548	114

STA.	TO STA.
FED. ROAD DIST. NO.	ILLINOIS FED. AID PROJECT
C558+00.47	* ROUTE 17 (US 52 / IL 64)
70.00' LT	** (1-2RS & (3-1RS-1)

DR. RICHARD NG

RUDOLF & BERTA LENKEIT

RICHARD & CAROL FREY

PLAN	DATE
NO.	
BY	
REVISIONS	
NO.	DESCRIPTION
1	ALIGNMENT CHECKED
2	PLANNING CHECKED
3	CONSTRUCTION CHECKED
4	AS-BUILT CHECKED

PROFILE	DATE
NO.	
BY	
REVISIONS	
NO.	DESCRIPTION
1	GRADES CHECKED
2	STRUCTURE NOTATIONS CHECKED

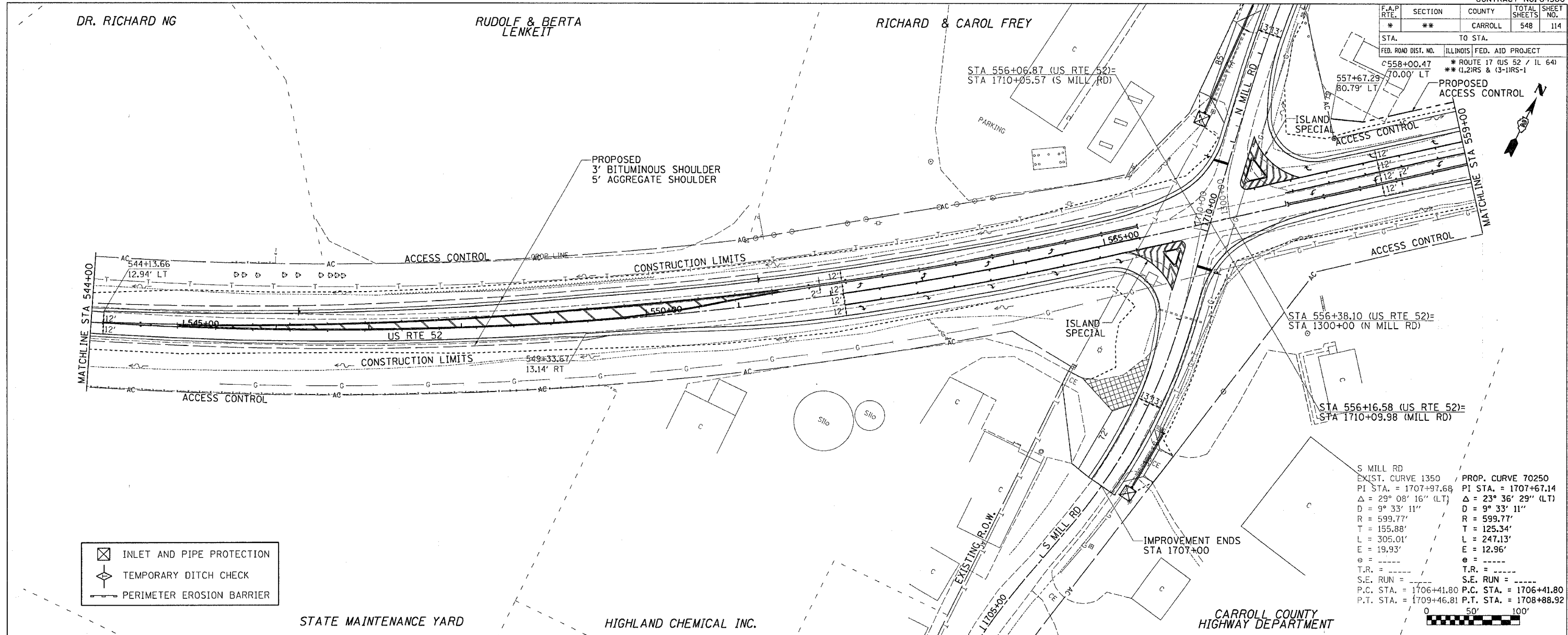

- INLET AND PIPE PROTECTION
- TEMPORARY DITCH CHECK
- PERIMETER EROSION BARRIER

S MILL RD  
 EXIST. CURVE 1350 / PROP. CURVE 70250  
 PI STA. = 1707+97.68 / PI STA. = 1707+67.14  
 $\Delta = 29^\circ 08' 16''$  (LT) /  $\Delta = 23^\circ 36' 29''$  (LT)  
 D = 9' 33' 11" / D = 9' 33' 11"  
 R = 599.77' / R = 599.77'  
 T = 155.88' / T = 125.34'  
 L = 305.01' / L = 247.13'  
 E = 19.93' / E = 12.96'  
 e = - / e = -  
 T.R. = - / T.R. = -  
 S.E. RUN = - / S.E. RUN = -  
 P.C. STA. = 1706+41.80 / P.C. STA. = 1706+41.80  
 P.T. STA. = 1709+46.81 / P.T. STA. = 1708+88.92

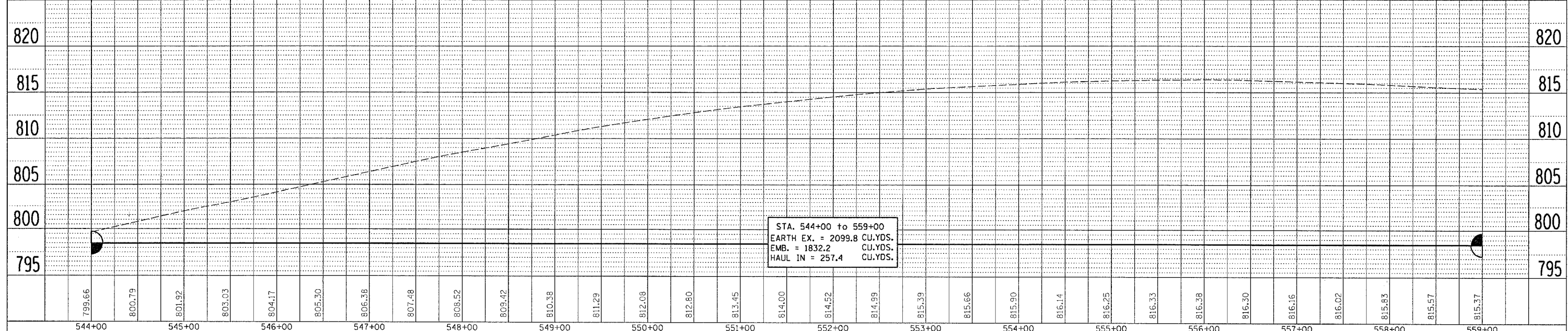

DATE-TIME\*  
 \*NON-SPEC\*  
 REF  
 REF  
 REF