

| F.A.P. RTE. | SECTION | COUNTY  | TOTAL SHEETS | SHEET NO. |
|-------------|---------|---------|--------------|-----------|
| **          | **      | CARROLL | 548          | 116       |

STA. TO STA.  
FED. ROAD DIST. NO. ILLINOIS FED. AID PROJECT  
\* ROUTE 17 (US 52 / IL 64)  
\*\* 1,2,IRS & 13-1,RS-1

PENNY L. COLLINS

LYLE LAW

CARROLL CO. FARM BUREAU

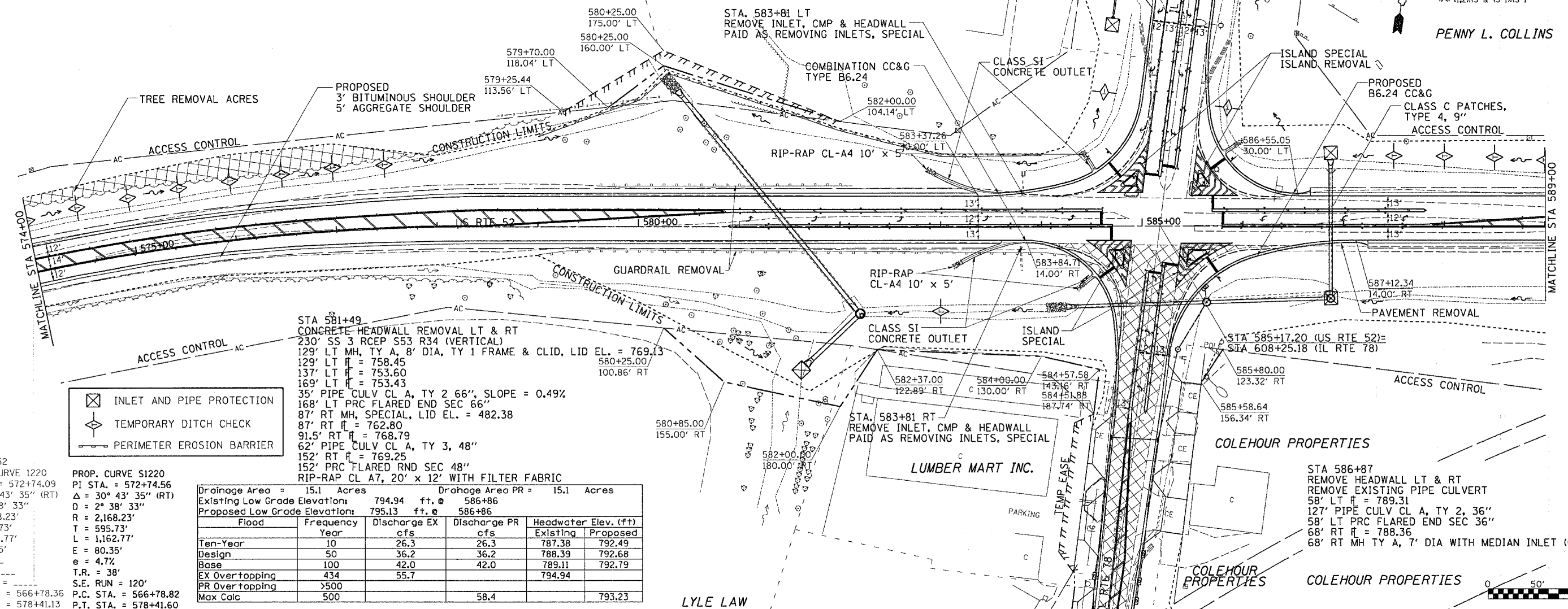

- INLET AND PIPE PROTECTION
- TEMPORARY DITCH CHECK
- PERIMETER EROSION BARRIER

US RTE 52  
EXIST. CURVE 1220  
PI STA. = 572+74.09  
Δ = 30° 43' 35" (RT)  
D = 2° 38' 33"  
R = 2,168.23'  
T = 595.73'  
L = 1,162.77'  
E = 80.35'  
e = 4.7%  
T.R. = 38'  
S.E. RUN = 120'  
P.C. STA. = 566+78.36  
P.T. STA. = 578+41.60

PROP. CURVE S1220  
PI STA. = 572+74.56  
Δ = 30° 43' 35" (RT)  
D = 2° 38' 33"  
R = 2,168.23'  
T = 595.73'  
L = 1,162.77'  
E = 80.35'  
e = 4.7%  
T.R. = 38'  
S.E. RUN = 120'  
P.C. STA. = 566+78.82  
P.T. STA. = 578+41.60

| Drainage Area = 15.1 Acres                 |           | Drainage Area PR = 15.1 Acres |                  |                               |          |
|--|-----------|-------------------------------|------------------|-------------------------------|----------|
| Existing Low Grade Elevation: 794.94 ft. @ |           | 586+86                        |                  |                               |          |
| Proposed Low Grade Elevation: 795.13 ft. @ |           | 586+86                        |                  |                               |          |
| Flood Year                                 | Frequency | Discharge EX cfs              | Discharge PR cfs | Headwater Elev. (ft) Existing | Proposed |
| Ten-Year                                   | 10        | 26.3                          | 26.3             | 787.38                        | 792.49   |
| Design                                     | 50        | 36.2                          | 36.2             | 788.39                        | 792.68   |
| Base                                       | 100       | 42.0                          | 42.0             | 789.11                        | 792.79   |
| EX Overtopping                             | 434       | 55.7                          |                  | 794.94                        |          |
| PR Overtopping                             | 500       |                               | 58.4             |                               | 793.23   |
| Max Calc                                   | 500       |                               |                  |                               |          |

STA. 574+00 to 589+00  
EARTH EX. = 2687.4 CU.YDS.  
EMB. = 18890.7 CU.YDS.  
HAUL IN = 16875.2 CU.YDS.

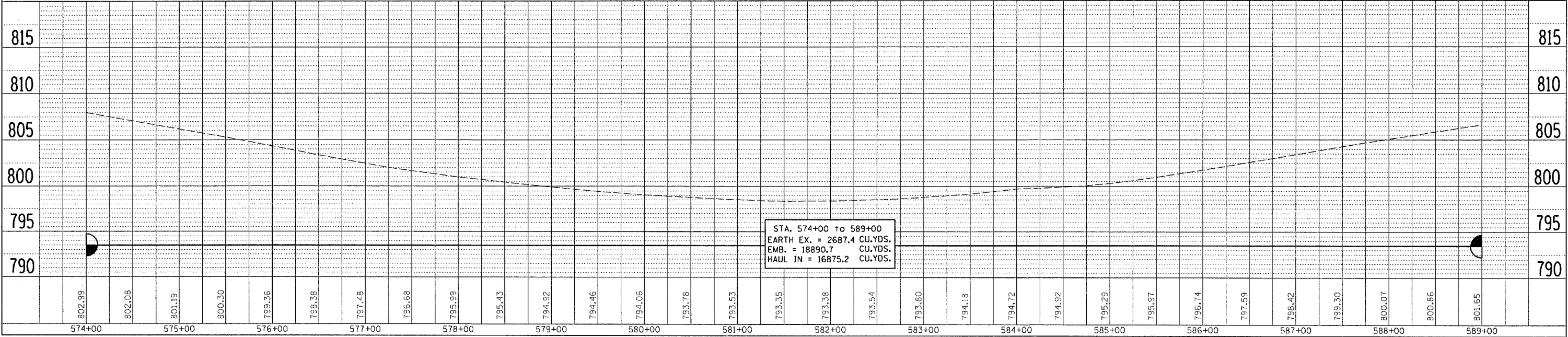

| DATE | BY | REVISION |
|------|----|----------|
|      |    |          |

| DATE | BY | REVISION |
|------|----|----------|
|      |    |          |

DATE TIME  
DWM-SEC  
REF  
REF  
REF