

F.A.P. RTE.	SECTION	COUNTY	TOTAL SHEETS	SHEET NO.
*	**	CARROLL	548	124

STA. TO STA.  
 FED. ROAD DIST. NO. ILLINOIS FED. AID PROJECT  
 \* ROUTE 17 (US 52 / IL 64)  
 \*\* (1,2)RS & (3-1)RS-1

# JACOBSTOWN RD

# BECKER RD

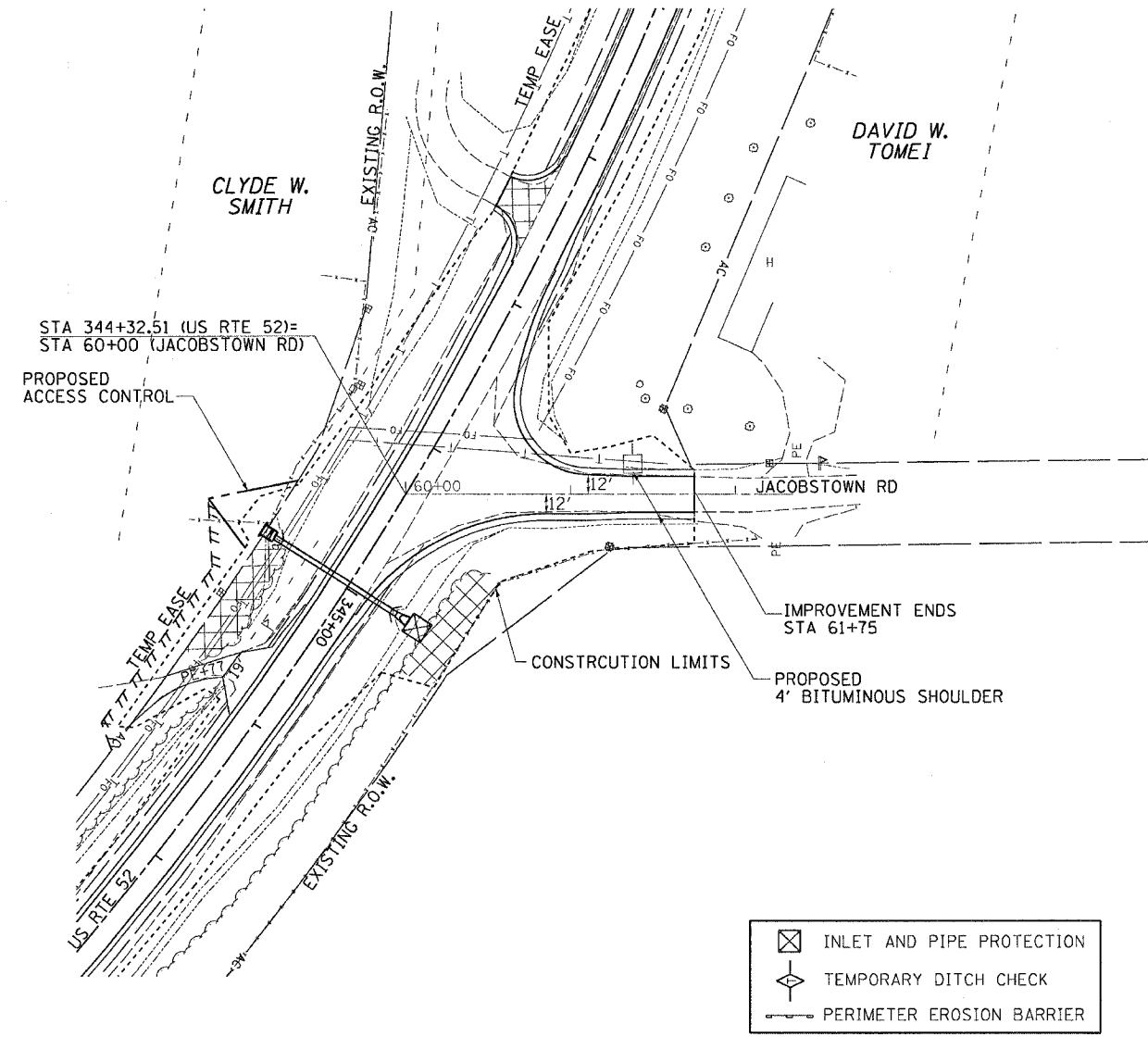

EXIST. CURVE 50260  
 PI STA. = 69+34.46  
 $\Delta = 36^\circ 58' 39''$  (LT)  
 $D = 163^\circ 42' 08''$   
 $R = 35.00'$   
 $T = 11.70'$   
 $L = 22.59'$   
 $E = 1.90'$   
 $e = \text{---}$   
 $T.R. = \text{---}$   
 $S.E. \text{ RUN} = \text{---}$   
 $P.C. \text{ STA.} = 69+22.76$   
 $P.T. \text{ STA.} = 69+45.35$

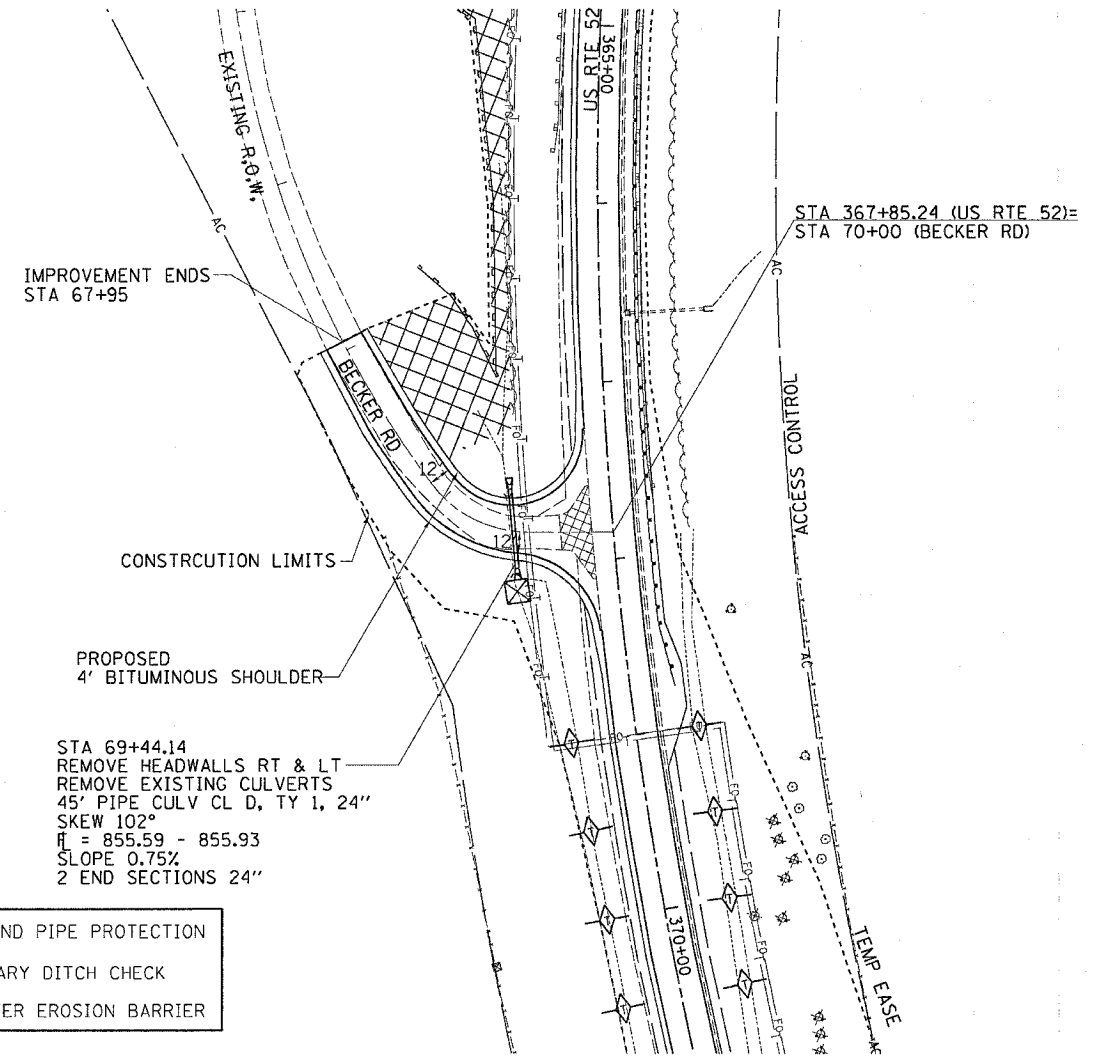

- INLET AND PIPE PROTECTION
- TEMPORARY DITCH CHECK
- PERIMETER EROSION BARRIER

- INLET AND PIPE PROTECTION
- TEMPORARY DITCH CHECK
- PERIMETER EROSION BARRIER

PLAN

DATE	
BY	
CHECKED	
APPROVED	

PROFILE

DATE	
BY	
CHECKED	
APPROVED	

