

F.A.P. RTE.	SECTION	COUNTY	TOTAL SHEETS	SHEET NO.
*	**	CARROLL	548	132
STA. TO STA.		FED. AID PROJECT		
FED. ROAD DIST. NO.		ILLINOIS		
* ROUTE 17 (US 52 / IL 64)				
** (1,2)RS & (3-1)RS-1				

JACKSON ST

EAST ST

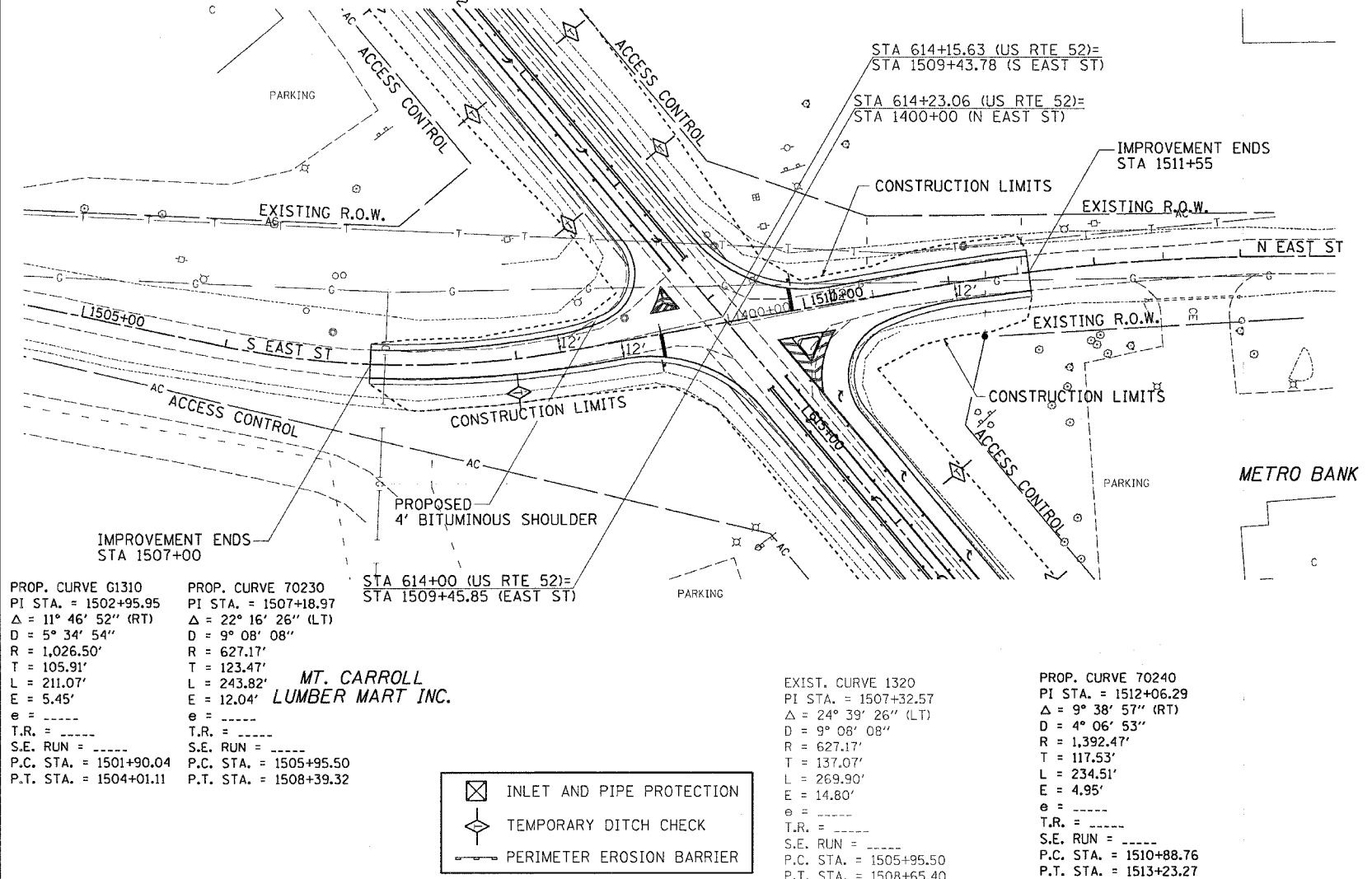
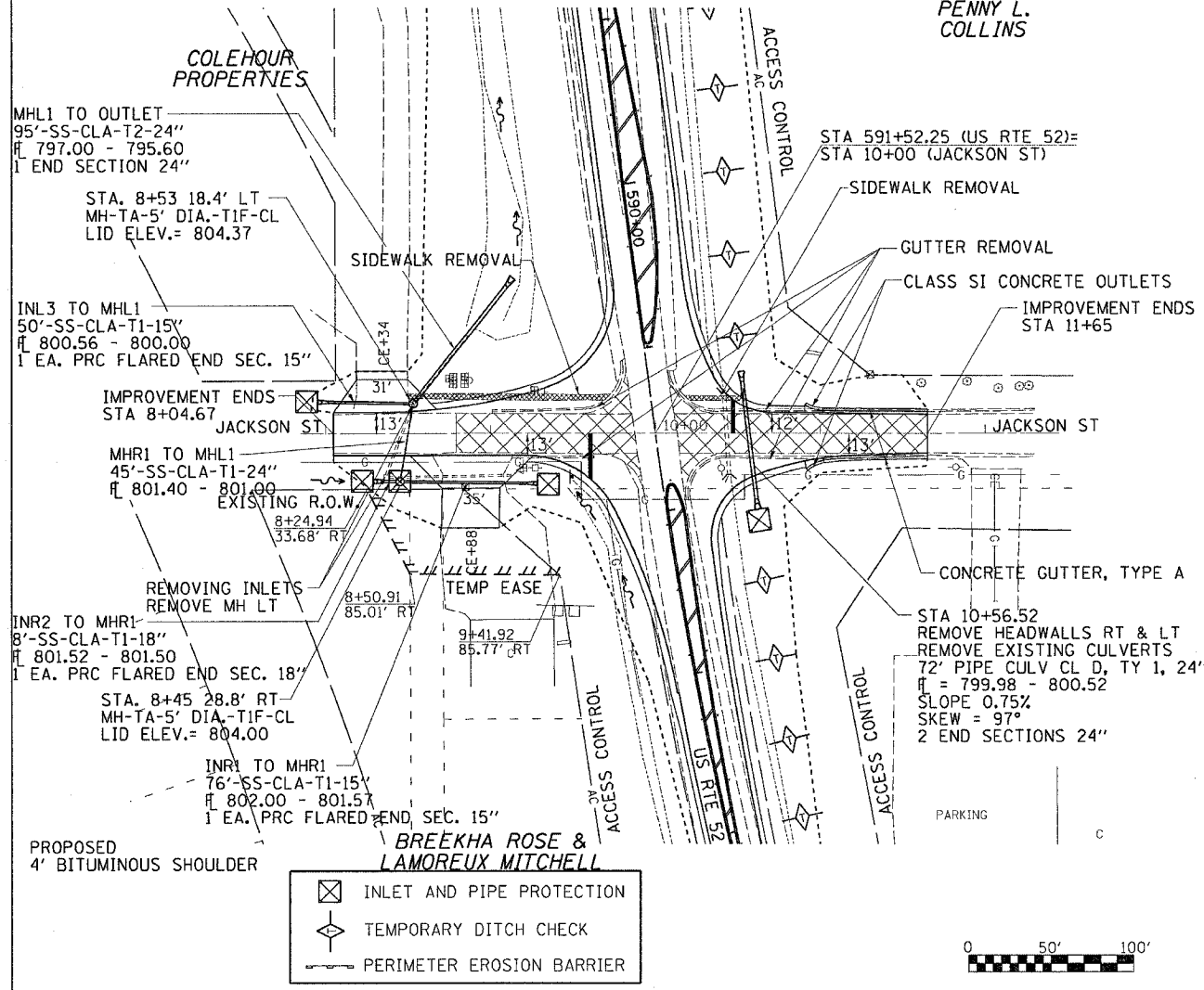

<p>PROP. CURVE G1310 PI STA. = 1502+95.95 $\Delta = 11^\circ 46' 52''$ (RT) D = 5' 34' 54" R = 1,026.50' T = 105.91' L = 211.07' E = 5.45' T.R. = ----- S.E. RUN = ----- P.C. STA. = 1501+90.04 P.T. STA. = 1504+01.11</p>	<p>PROP. CURVE 70230 PI STA. = 1507+18.97 $\Delta = 22^\circ 16' 26''$ (LT) D = 9' 08' 08" R = 627.17' T = 123.47' L = 243.82' E = 12.04' T.R. = ----- S.E. RUN = ----- P.C. STA. = 1505+95.50 P.T. STA. = 1508+39.32</p>	<p>EXIST. CURVE 1320 PI STA. = 1507+32.57 $\Delta = 24^\circ 39' 26''$ (LT) D = 9' 08' 08" R = 627.17' T = 137.07' L = 269.90' E = 14.80' T.R. = ----- S.E. RUN = ----- P.C. STA. = 1505+95.50 P.T. STA. = 1508+65.40</p>	<p>PROP. CURVE 70240 PI STA. = 1512+06.29 $\Delta = 9^\circ 38' 57''$ (RT) D = 4' 06' 53" R = 1,392.47' T = 117.53' L = 234.51' E = 4.95' T.R. = ----- S.E. RUN = ----- P.C. STA. = 1510+88.76 P.T. STA. = 1513+23.27</p>
---	--	--	--

- INLET AND PIPE PROTECTION
- TEMPORARY DITCH CHECK
- PERIMETER EROSION BARRIER

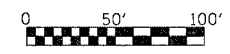

PLAN	SURVEYED	DATE
	DESIGNED	
	CHECKED	
	NOTED	
	BY	
	DATE	

PROFILE	SURVEYED	DATE
	DESIGNED	
	CHECKED	
	NOTED	
	BY	
	DATE	

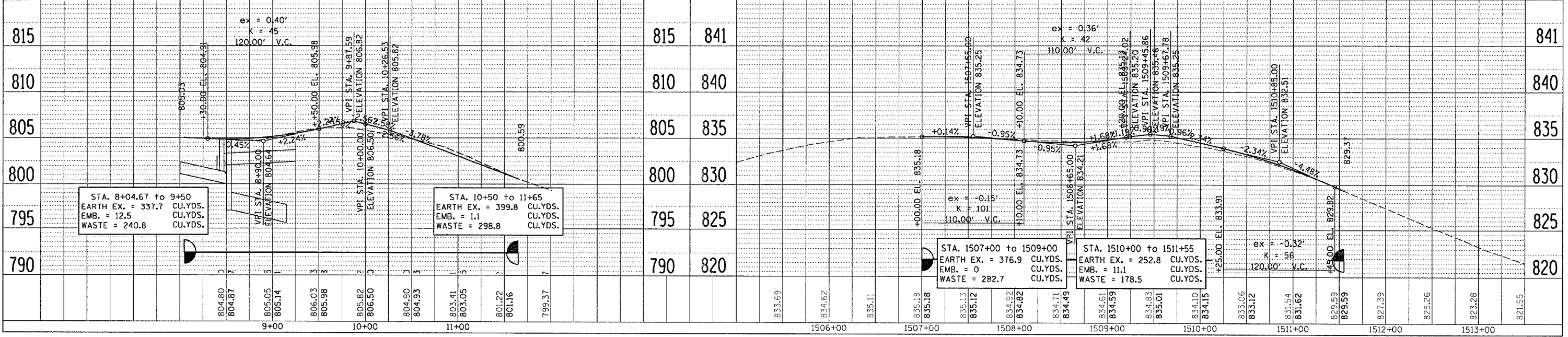

STA. 8+04.67 to 9+50
EARTH EX. = 337.7 CU.YDS.
EMB. = 12.5 CU.YDS.
WASTE = 240.8 CU.YDS.

STA. 10+50 to 11+65
EARTH EX. = 399.8 CU.YDS.
EMB. = 1.1 CU.YDS.
WASTE = 298.8 CU.YDS.

STA. 1507+00 to 1509+00
EARTH EX. = 376.9 CU.YDS.
EMB. = 0 CU.YDS.
WASTE = 282.7 CU.YDS.

STA. 1510+00 to 1511+55
EARTH EX. = 252.8 CU.YDS.
EMB. = 11.1 CU.YDS.
WASTE = 178.5 CU.YDS.