

STAGING 5A

1. RELOCATE BARRIER WALL USING STANDARD 701201-02.
2. SET UP STANDARD 701321-08.
3. REMOVE ANY PAVEMENT MARKING THAT CONFLICTS WITH STAGING.
4. REMOVE PAVEMENT FROM STA. 532+35 TO 532+79.
5. REMOVE EXISTING CMP AND HEADWALL FROM CENTER LINE TO END.
6. PLACE DOUBLE BOX CULVERT FROM CENTER LINE TO END.
7. PLACE BOX CULVERT END SECTION, CULVERT NO. 3 (2)
8. PLACE BACKFILL AND COMP.
9. POUR 9" CLASS C PATCH OVER BACKFILL FROM STA. 532+35 TO STA. 532+79.
10. REPLACE SHOULDER REMOVED FOR STAGE 1A.
11. DO SOME TEMP. SHAPING AND TEMP. SEEDING (PRICE INCLUDED IN PIPE CULVERT).
12. REMOVE STANDARD 701321-08.
13. PLACE TEMP. PAVEMENT MARKINGS FROM STA. 529+00 TO 536+00.

LYLE H. & ROBERT J. HARTMAN

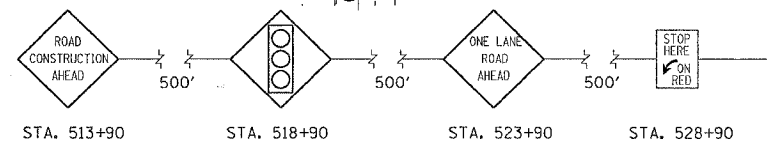
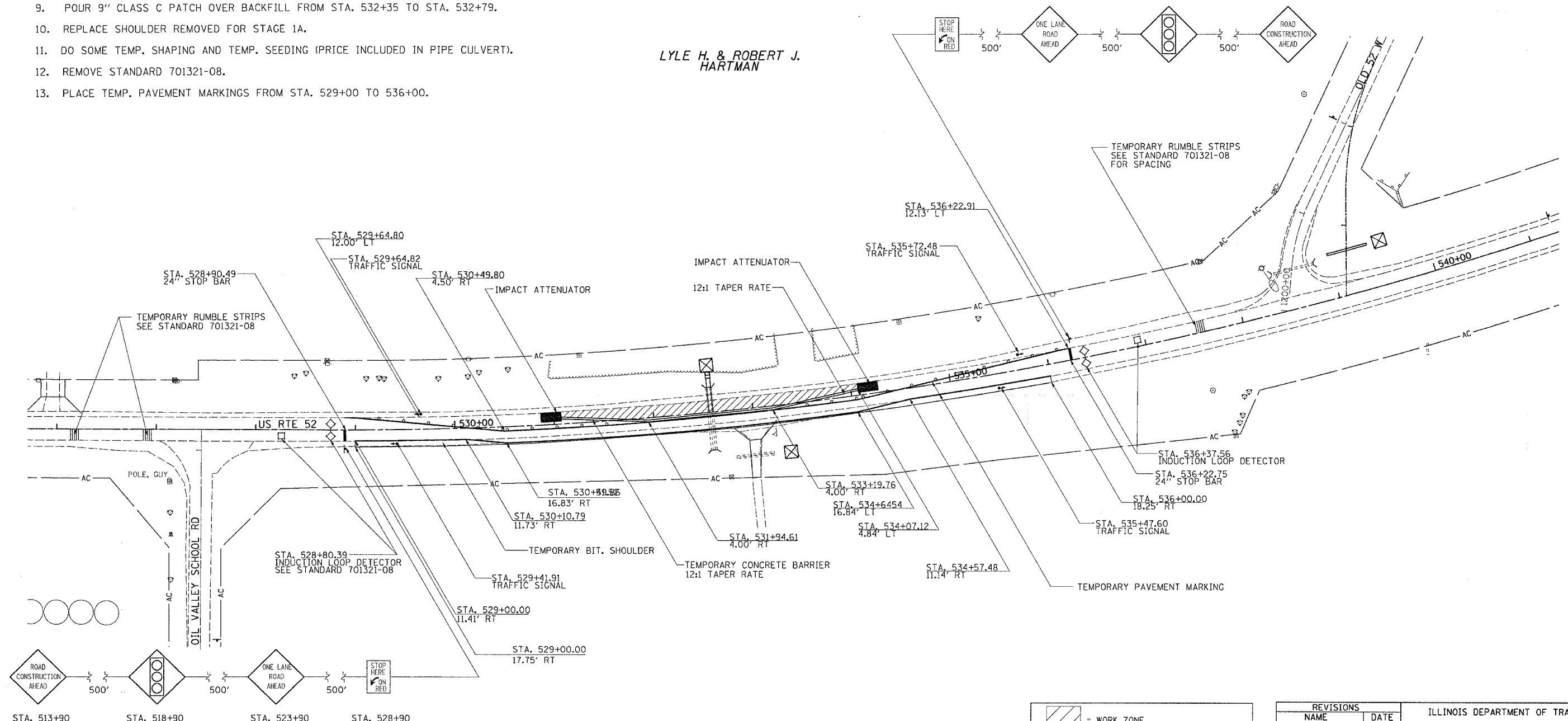

NOTE:
THIS TRAFFIC CONTROL AND PROTECTION SHALL BE SET UP AND PAID FOR ACCORDING TO STANDARD 701321-08

| | |
|--|---|
| | = WORK ZONE |
| | = TRAFFIC SIGNAL |
| | = INDUCTION LOOP DETECTOR |
| | = IMPACT ATTENUATORS, TEMPORARY (NON-REDIRECTIVE), TEST LEVEL 3 |

| REVISIONS | |
|-----------|------|
| NAME | DATE |
| | |
| | |
| | |
| | |
| | |
| | |
| | |
| | |
| | |
| | |

ILLINOIS DEPARTMENT OF TRANSPORTATION

SCALE: VERT. / HORIZ. / DATE

DRAWN BY / CHECKED BY

PLOT DATE = Fri Mar 23 09:41:18 2007
 FILE NAME = C:\projects\64560\staging\staging.dgn
 USER NAME = harsco

STAGING DETAILS