

F.A.P. RTE.	SECTION	COUNTY	TOTAL SHEETS	SHEET NO.
17	**	CARROLL	548	167

STA.	TO STA.
FED. ROAD DIST. NO.	ILLINOIS FED. AID PROJECT

* ROUTE 17 (US 52 / IL 64)
 ** (1,2)RS & (3-1)RS-1

STAGING 6

1. USE STANDARD 701201 TO SET UP ROAD CLOSURE.
- a. REMOVE ANY CONFLICTING PAVEMENT MARKING.
2. REMOVE PAVEMENT FROM STA. 1804+50 TO STA. 1807+40.
3. PLACE 1' OF SUB. GRAN. MATERIAL TYPE A AND FABRIC FILTER.
4. PLACE 3" OF INCIDENTAL HOT-MIX ASPHALT SURFACING (2 LIFTS).
5. DO SOME TEMP. STRIPING.
6. GO TO STAGE 6A.

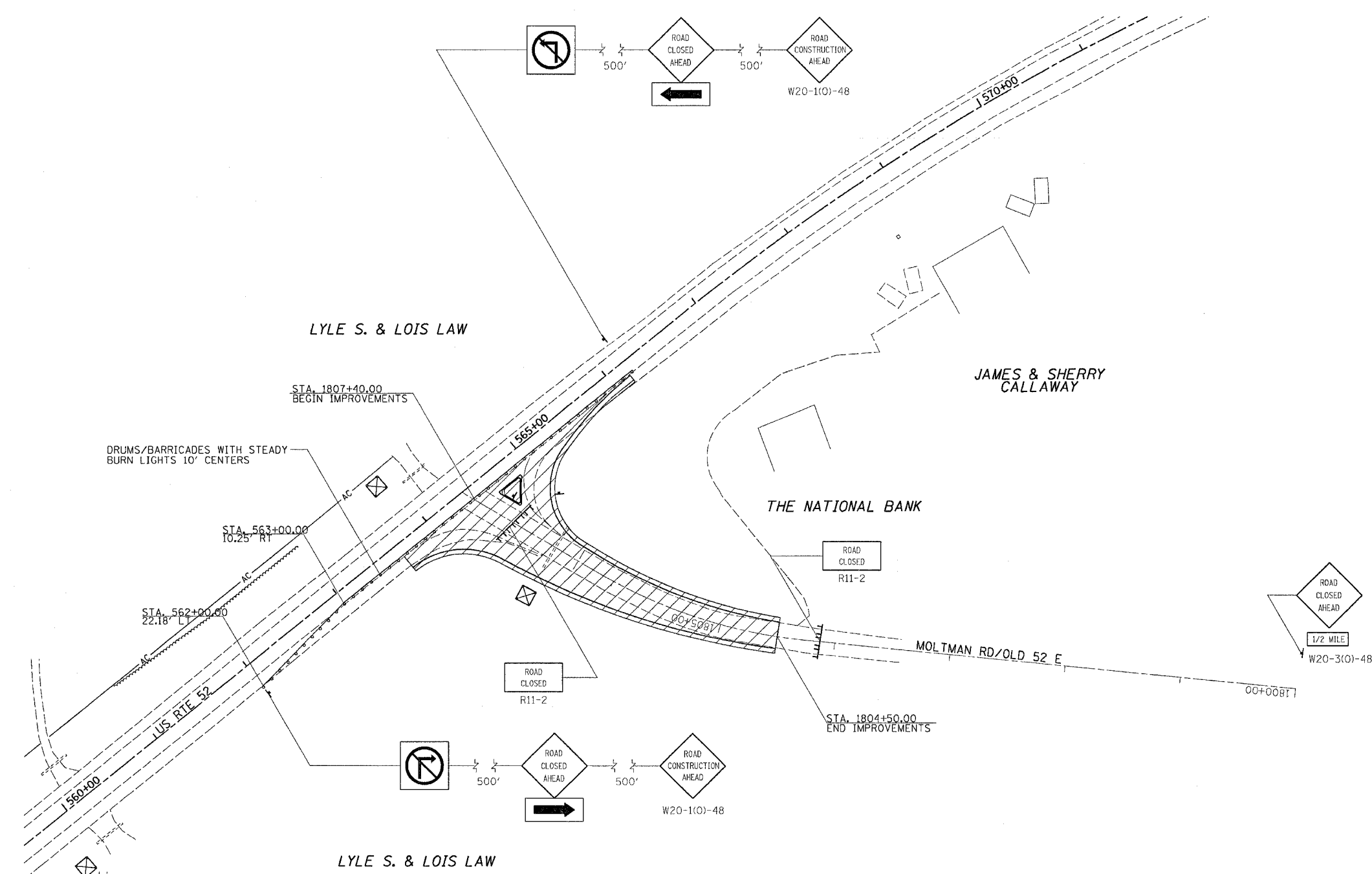

	= WORK ZONE
	= TYPE III BARRICADE WITH FLASHING LIGHTS
	= SIGN
	= BARRICADE, OR DRUM WITH STEADY BURNING LIGHTS

REVISIONS	
NAME	DATE

ILLINOIS DEPARTMENT OF TRANSPORTATION

SCALE: VERT. _____
 HORIZ. _____
 DATE _____

DRAWN BY _____
 CHECKED BY _____

PLOT DATE * Fri Mar 23 09:04:14 2007
 FILE NAME * C:\projects\2074200\0871008a.dgn
 PLOT SCALE * 5/8"=1'-0"
 USER NAME * harsanika