

F.A.P. RTE.	SECTION	COUNTY	TOTAL SHEETS	SHEET NO.
*	**	CARROLL	548	190
STA.		TO STA.		
FED. ROAD DIST. NO.		ILLINOIS FED. AID PROJECT		

\* ROUTE 17 (US 52 / IL 64)  
 \*\* (1,2)RS & (3,1)RS-1

# STAGE II



SIGNING ACCORDING TO STANDARD 701321

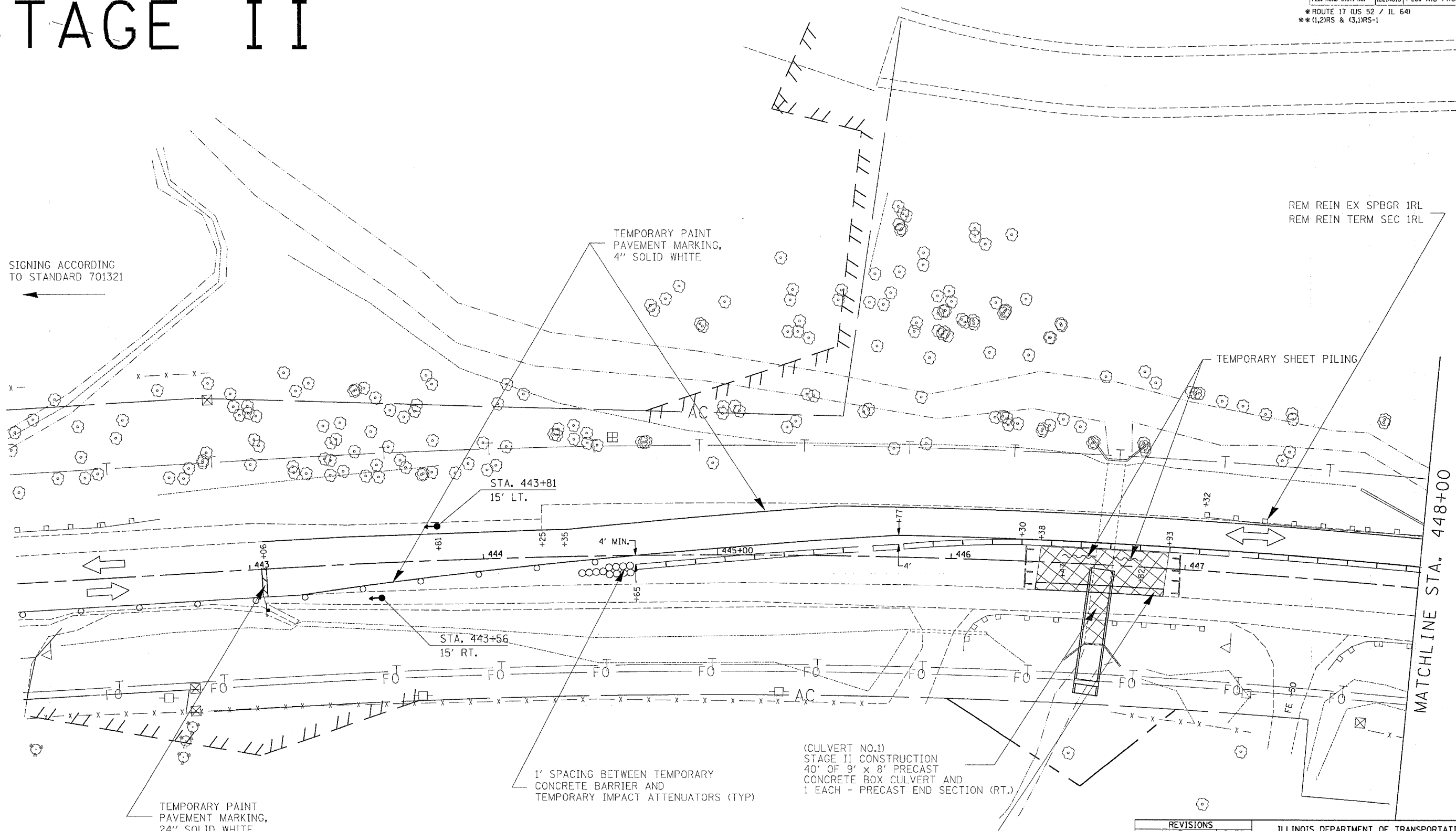

REM REIN EX SPBGR 1RL  
 REM REIN TERM SEC 1RL

TEMPORARY SHEET PILING

MATCHLINE STA. 448+00

(CULVERT NO.1)  
 STAGE II CONSTRUCTION  
 40' OF 9' x 8' PRECAST  
 CONCRETE BOX CULVERT AND  
 1 EACH - PRECAST END SECTION (RT.)

1' SPACING BETWEEN TEMPORARY  
 CONCRETE BARRIER AND  
 TEMPORARY IMPACT ATTENUATORS (TYP)

CLASS B PATCH, TYPE III, 10"  
 RT. STA. 446+38 TO RT. STA. 446+93

TEMPORARY PAINT  
 PAVEMENT MARKING,  
 24" SOLID WHITE

REVISIONS	
NAME	DATE

ILLINOIS DEPARTMENT OF TRANSPORTATION  
 MAINTENANCE OF TRAFFIC  
 STAGE II  
 SHEET 1 OF 2

SCALE: VERT. \_\_\_\_\_  
 HORIZ. \_\_\_\_\_  
 DATE \_\_\_\_\_  
 DRAWN BY \_\_\_\_\_  
 CHECKED BY \_\_\_\_\_

PLOT DATE = Fri, Mar 23, 2012 9:07:28 AM  
 FILE NAME = c:\p\projects\2012\1486\107\102\102.dgn  
 PLOT SCALE = 20.0000' / IN.  
 USER NAME = csharkey