

* ROUTE 17 (US 52 / IL 64)
 ** (1,2)RS & (3,1)RS-1 CONTRACT NO. 64560

F.A.P. RTE.	SECTION	COUNTY	TOTAL SHEETS	SHEET NO.
**	**	CARROLL	548	280
STA. 232+98.38		TO STA. 232+98.38		
FED. ROAD DIST. NO.	ILLINOIS	FED. AID PROJECT		

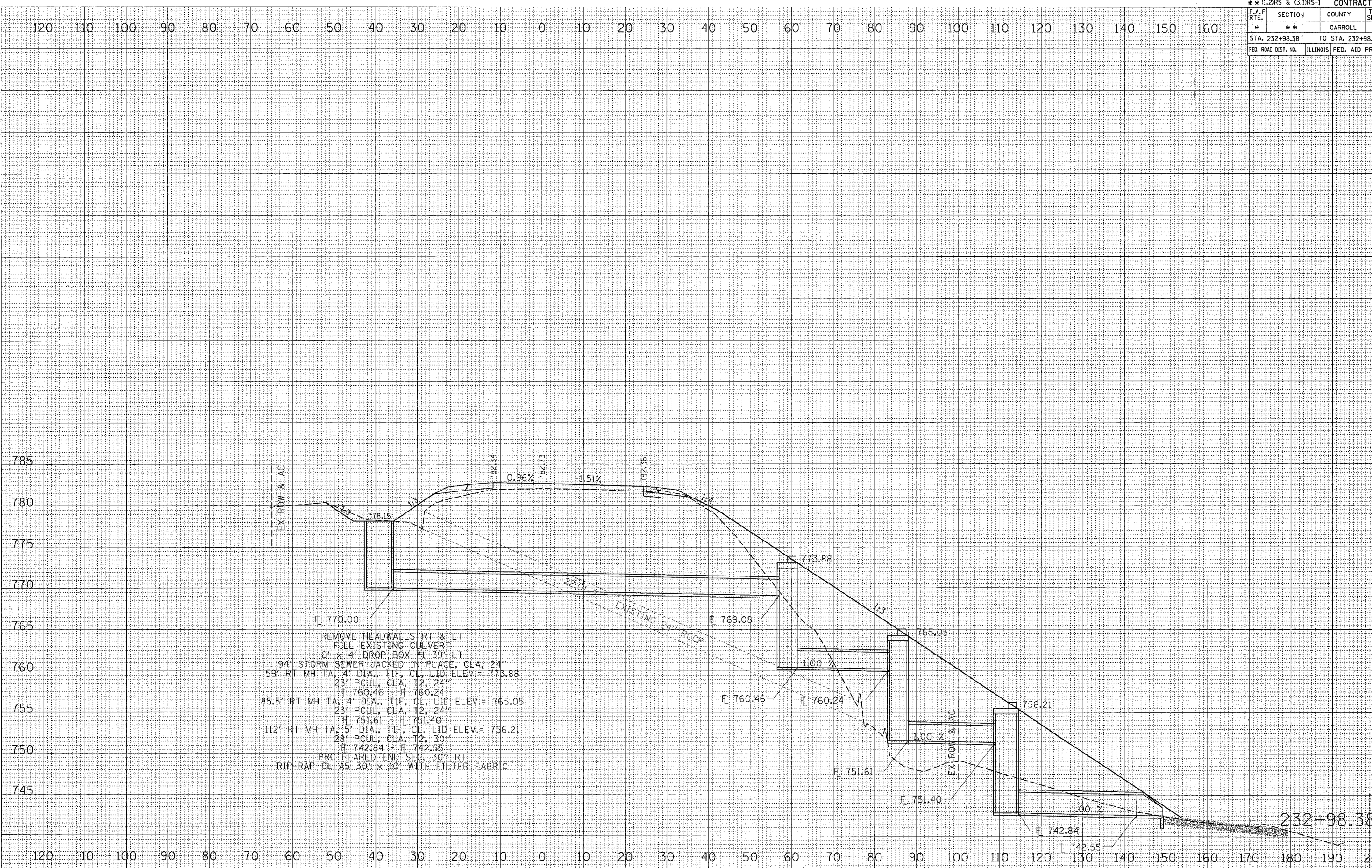

REMOVE HEADWALLS RT & LT
 FILL EXISTING CULVERT
 6' x 4' DROP BOX F1 39' LI
 94' STORM SEWER JACKED IN PLACE, CLA. 24"
 59' RT MH TA, 4' DIA., TIF, CL, LID ELEV.= 773.88
 23' PCUL, CLA, T2, 24"
 F 760.46 - F 760.24
 85.5' RT MH TA, 4' DIA., TIF, CL, LID ELEV.= 765.05
 23' PCUL, CLA, T2, 24"
 F 751.61 - F 751.40
 112' RT MH TA, 5' DIA., TIF, CL, LID ELEV.= 756.21
 28' PCUL, CLA, T2, 30"
 F 742.84 - F 742.55
 PRO FLARED END SEC. 30" RT
 RIP-RAP CL AS 30' x 10' WITH FILTER FABRIC

FINAL SURVEY

DATE	
BY	
SURVEYED	
PLOTTED	
NOTE BOOK	
AREAS CHECKED	
NO.	

ORIGINAL SURVEY

DATE	
BY	
SURVEYED	
PLOTTED	
NOTE BOOK	
AREAS CHECKED	
NO.	

PLOT DATE = Thu Mar 22 14:41:49 2007
 FILE NAME = c:\pcc\pccs207\680_387\880.mxd
 PLOT SCALE = 10.0000 / IN.
 USER NAME = harscoke