

F.A.U. RTE.	SECTION	COUNTY	TOTAL SHEETS	SHEET NO.
5789	(33&40)-1-FR	ROCK ISLAND	30	23
STA.		TO STA.		
FED. ROAD DIST. NO.	ILLINOIS	FED. AID PROJECT		

TEMPORARY SIGNALS

PHASE DESIGNATION DIAGRAM

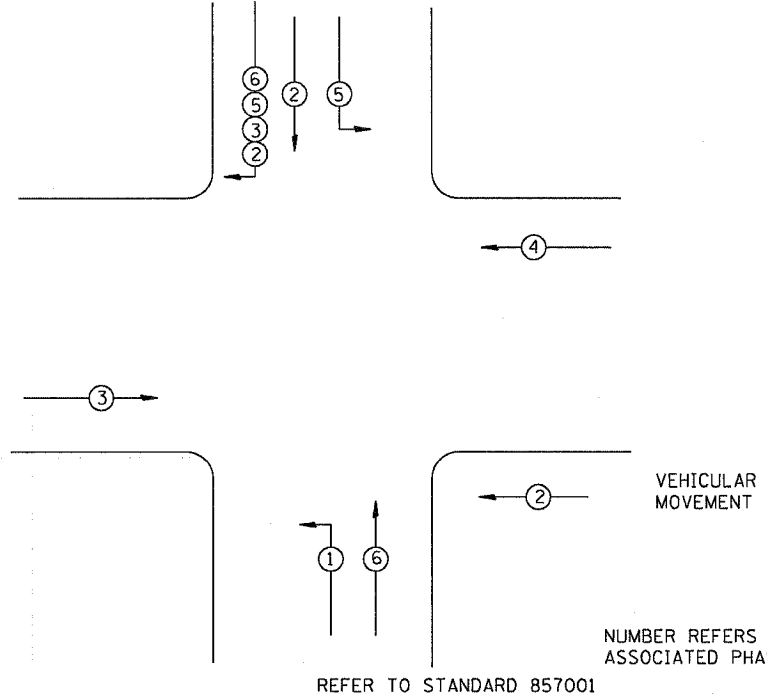
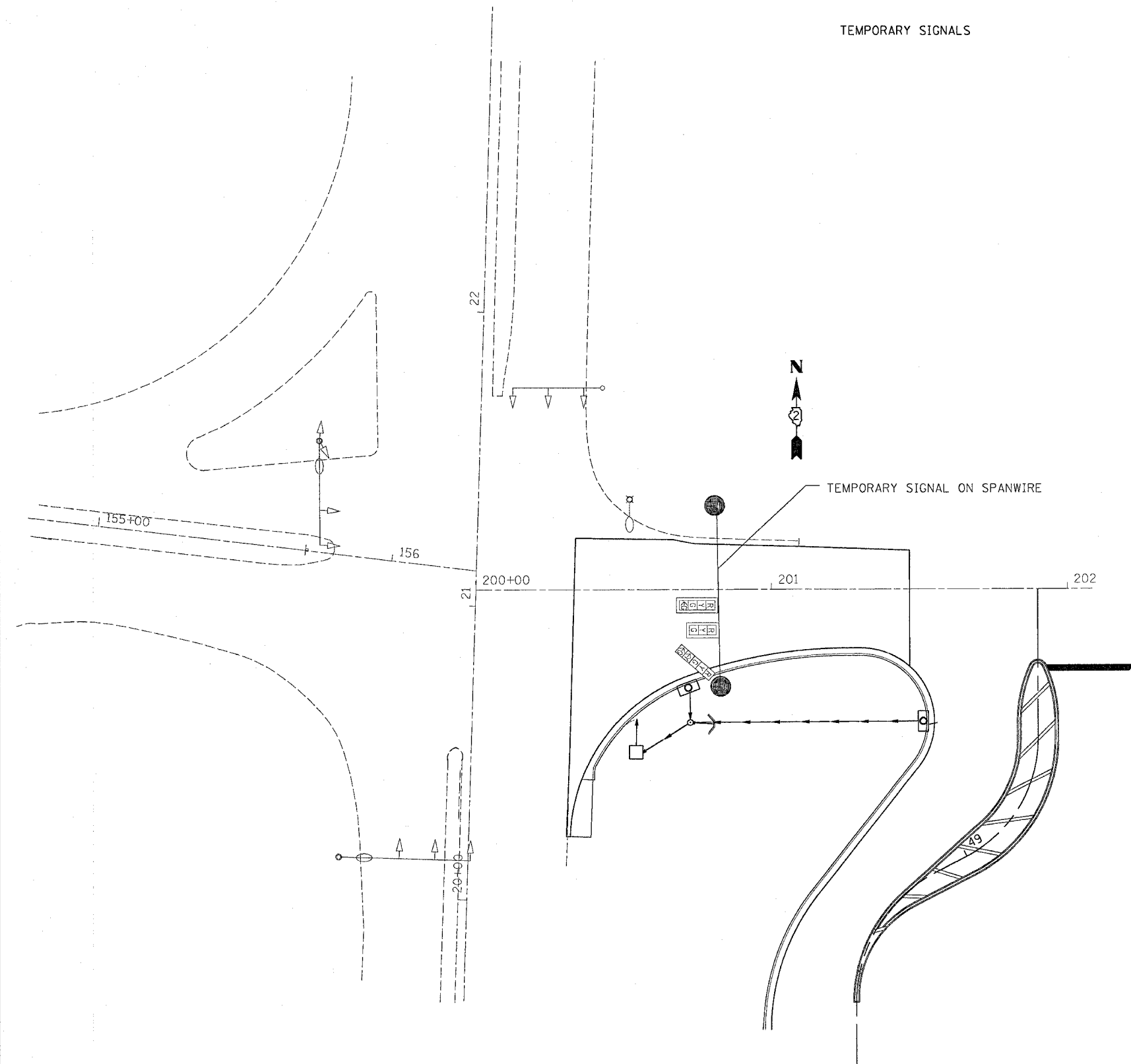

REFER TO STANDARD 857001

NOTE:
 ONLY ONE MAST ARM WILL BE REPLACE IN A NEW LOCATION WHICH WILL REQUIRE TEMPORARY SIGNAL INSTALLATION. THE CONTRACTOR SHALL BE RESPONSIBLE FOR TEMPORARY WIRE TO THE EXISTING SIGNALS PRIOR THE SWITCHOVER TO THE PROPOSED CONTROLLER CABINET AND NEW MAST- ARM ASSEMBLY.

PLOT DATE = Wed Mar 21 09:24:37 2007
 FILE NAME = c:\p\proj\33&40\2064385\064385.dgn
 PLOT SCALE = 28.0000 / 1 IN.
 USER NAME = mgj11J

REVISIONS	
NAME	DATE

ILLINOIS DEPARTMENT OF TRANSPORTATION

SCALE: VERT. DRAWN BY
 HORIZ. CHECKED BY
 DATE