

ALLAN R. &
LISA A. HEILMAN

LEGEND

- SEEDING, CLASS 1
- SEEDING, CLASS 2A
- SEEDING, CLASS 4
- AGGREGATE DITCH, 12" OR STONE DUMPED RIPRAP, CLASS A4 OR STONE RIPRAP, CLASS A3

REMOVAL LEGEND

- TREE REMOVAL, UNIT
- TREE REMOVAL, ACRE
- TYPE III BARRICADE

RUTH ANN &
HUTCHISON BATES



F.A.P. RTE.	SECTION	COUNTY	TOTAL SHEETS	SHEET NO.
505	110RS-1, 111RS-3	STEPHENSON	174	26
STA. 10205+00		TO STA. 10220+00		
FED. ROAD DIST. NO.	ILLINOIS	FED. AID PROJECT		CONTRACT NO. 64C32

PLAN	SURVEYED	BY	DATE
	PLOTTED		
	CHECKED		
	DATE		

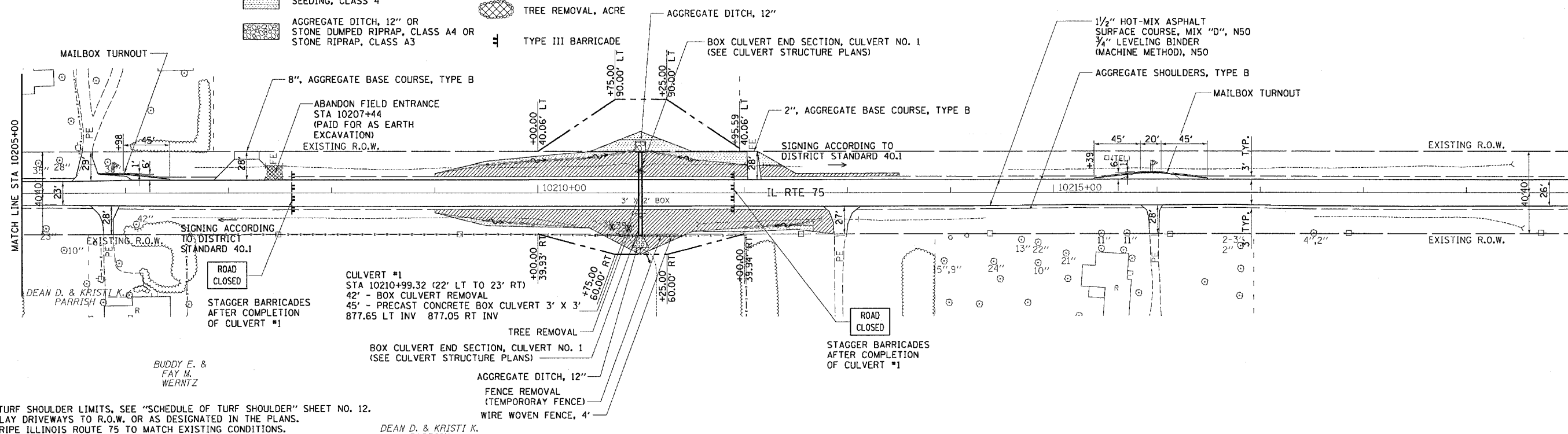

- NOTES:
- FOR TURF SHOULDER LIMITS, SEE "SCHEDULE OF TURF SHOULDER" SHEET NO. 12.
 - OVERLAY DRIVEWAYS TO R.O.W. OR AS DESIGNATED IN THE PLANS.
 - RESTRIPE ILLINOIS ROUTE 75 TO MATCH EXISTING CONDITIONS.
 - REMOVE ALL EXISTING RAISED REFLECTIVE PAVEMENT MARKINGS.

BUDDY E. &
FAY M.
WERNTZ

DEAN D. & KRISTI K.
PARRISH

GENEVIEVE BORCHERS

DUANE O. & MARCIA P.
HEIDENREICH

GENEVIEVE BORCHERS

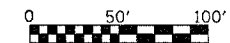

PROFILE	SURVEYED	BY	DATE
	PLOTTED		
	CHECKED		
	DATE		

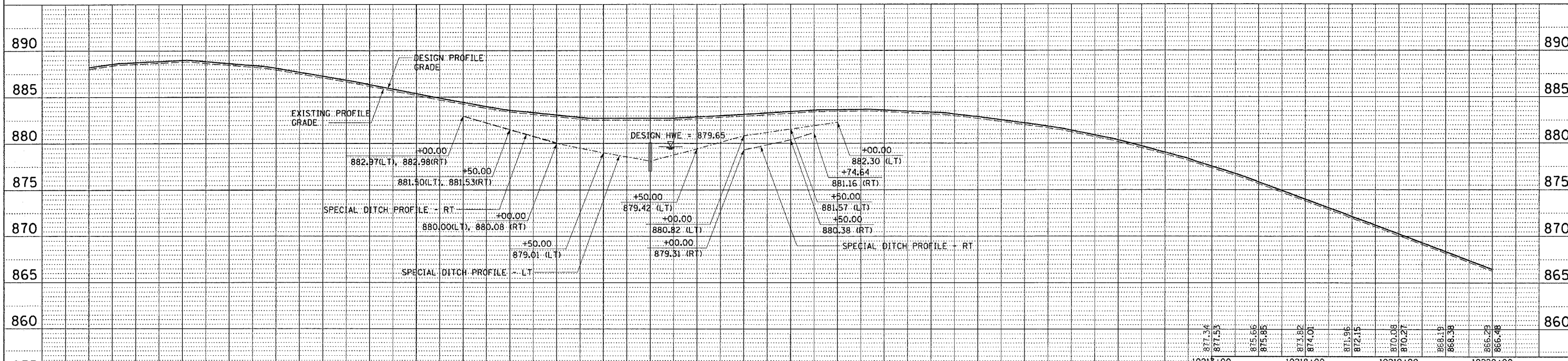

REVISIONS	
NAME	DATE

ILLINOIS DEPARTMENT OF TRANSPORTATION
F.A.P. ROUTE 505 (IL 75)
ILLINOIS ROUTE 75
PLAN & PROFILE
STA 10205+00 TO 10220+00

SCALE: VERT. 1"=50'
HORIZ. 1"=50'
DATE: 12/20/06

DRAWN BY JMC
CHECKED BY DWB

Tue Mar 28 10:55:55 2006