

WILLIAM B. &  
JOANN C. MOTTER

F.A.P. RTE.	SECTION	COUNTY	TOTAL SHEETS	SHEET NO.
505	110RS-1, 111RS-3	STEPHENSON	174	36
STA. 10355+00		TO STA. 10370+00		
FED. ROAD DIST. NO.	ILLINOIS	FED. AID PROJECT		
CONTRACT NO. 64C32				

PLAN	SURVEYED	DATE
NOTE BOOK	BY	
NO.	BY	
	DATE	

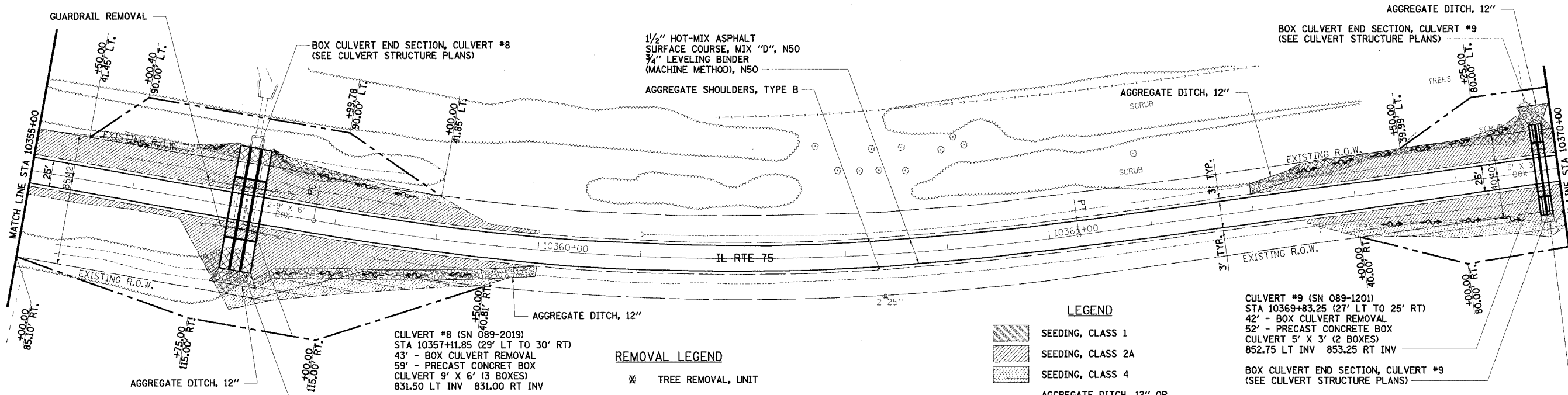

- NOTES:
1. FOR TURF SHOULDER LIMITS, SEE "SCHEDULE OF TURF SHOULDER" SHEET NO. 12.
  2. OVERLAY DRIVEWAYS TO R.O.W. OR AS DESIGNATED IN THE PLANS.
  3. RESTRIPE ILLINOIS ROUTE 75 TO MATCH EXISTING CONDITIONS.
  4. REMOVE ALL EXISTING RAISED REFLECTIVE PAVEMENT MARKINGS.

**REMOVAL LEGEND**

- ✕ TREE REMOVAL, UNIT
- ⊗ TREE REMOVAL, ACRE

**LEGEND**

- SEEDING, CLASS 1
- SEEDING, CLASS 2A
- SEEDING, CLASS 4
- AGGREGATE DITCH, 12" OR STONE DUMPED RIPRAP, CLASS A4 OR STONE RIPRAP, CLASS A3

KENNETH D. & DORIS  
SHOEMAKER



PROFILE	SURVEYED	DATE
NOTE BOOK	BY	
NO.	BY	
	DATE	

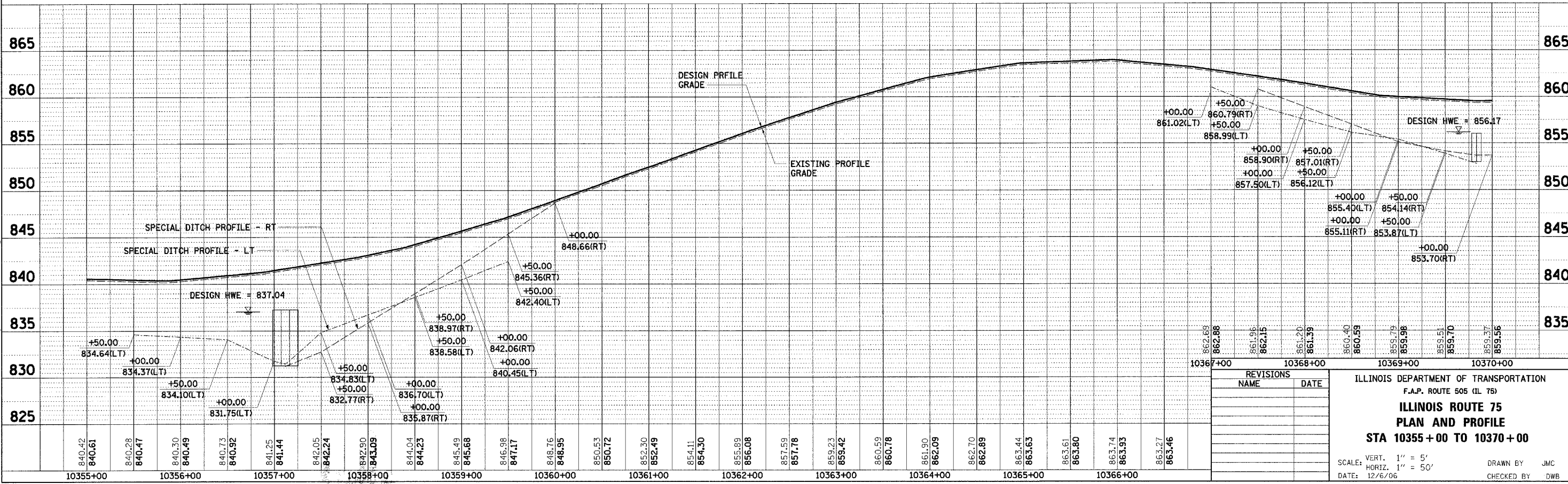

REVISIONS	
NAME	DATE

ILLINOIS DEPARTMENT OF TRANSPORTATION  
F.A.P. ROUTE 505 (IL 75)  
**ILLINOIS ROUTE 75**  
**PLAN AND PROFILE**  
**STA 10355 + 00 TO 10370 + 00**

SCALE: VERT. 1" = 5'  
HORIZ. 1" = 50'  
DATE: 12/6/06

DRAWN BY JMC  
CHECKED BY DWB

12/7/2006 9:40:24 AM ka:\109800\1175\_3p\cadd\DESIGN\PLAN.dgn