

F.A.P. RTE.	SECTION	COUNTY	TOTAL SHEETS	SHEET NO.
505	110RS-1, 11RS-3	STEPHENSON	174	50
STA.	10138+30	TO STA.	10160+00	
FED. ROAD DIST. NO.	ILLINOIS	FED. AID PROJECT		
CONTRACT NO. 64C32				

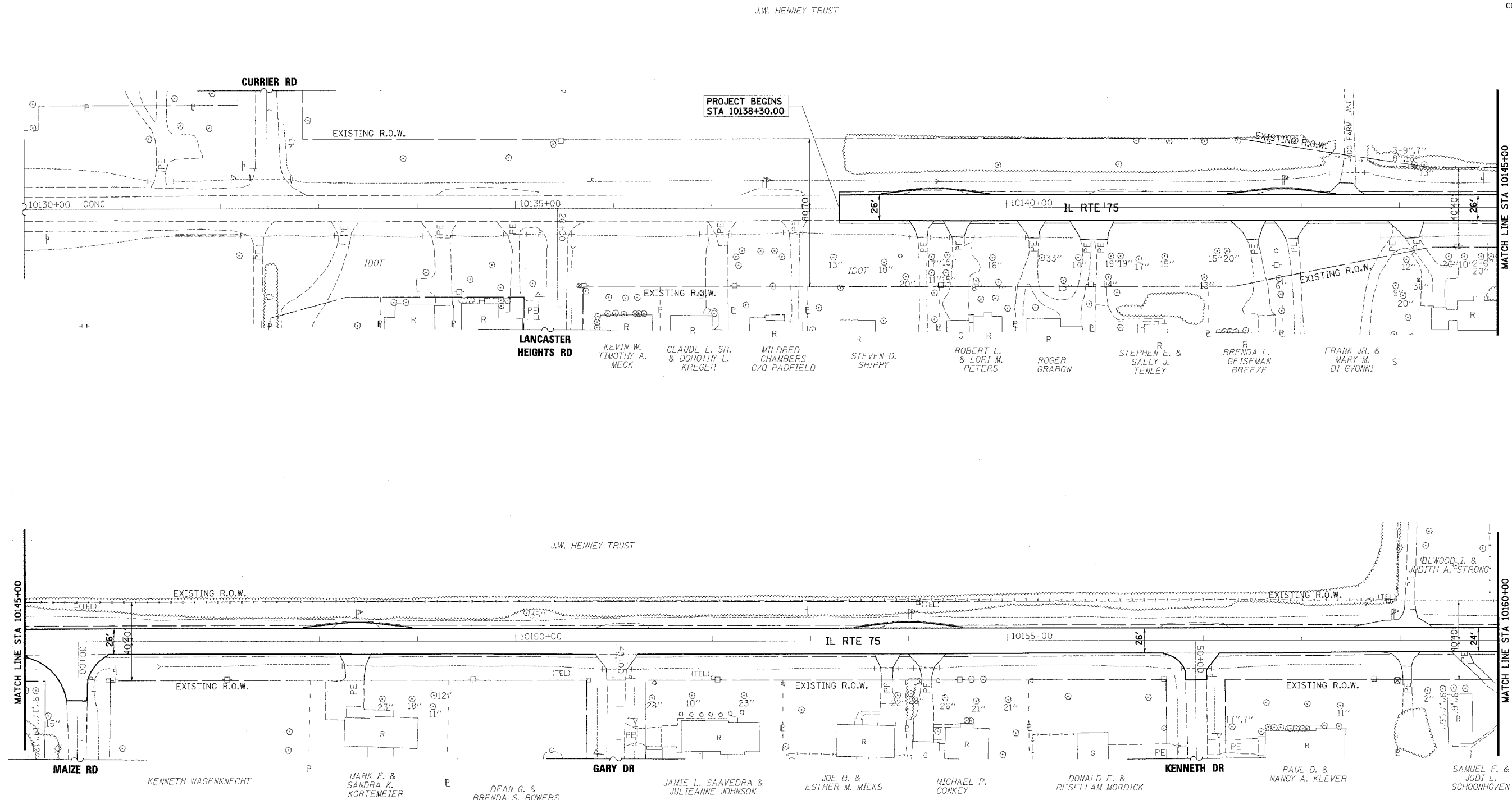

- LEGEND**
- ◆ TEMPORARY DITCH CHECK
  - ⊕ INLET AND PIPE PROTECTION
  - PERIMETER EROSION BARRIER
  - ▨ AGGREGATE DITCH, 12" OR STONE DUMPED RIPRAP, CLASS A4 OR STONE RIPRAP, CLASS A3

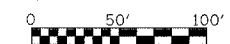

REVISIONS	
NAME	DATE

ILLINOIS DEPARTMENT OF TRANSPORTATION  
 F.A.P. ROUTE 505 (IL 75)  
**ILLINOIS ROUTE 75**  
**EROSION CONTROL PLAN**  
**STA 10138+30 TO STA 10160+00**

SCALE: VERT. 1" = 50'  
 HORIZ. 1" = 50'  
 DATE: 12/6/06  
 DRAWN BY JMC  
 CHECKED BY DWB

2/7/2006 9:42:25 AM k:\1195800\1175\_3p\acadd\design\erosion\_3p\_01.dgn