

CONTRACT NO. 64D02

F.A.I. RTE.	SECTION	COUNTY	TOTAL SHEETS	SHEET NO.
88	(195-1HB-2)M	WHITESIDE	17	5
STA. 44+17		TO STA. 55+10		
FED. ROAD DIST. NO.		ILLINOIS FED. AID PROJECT		

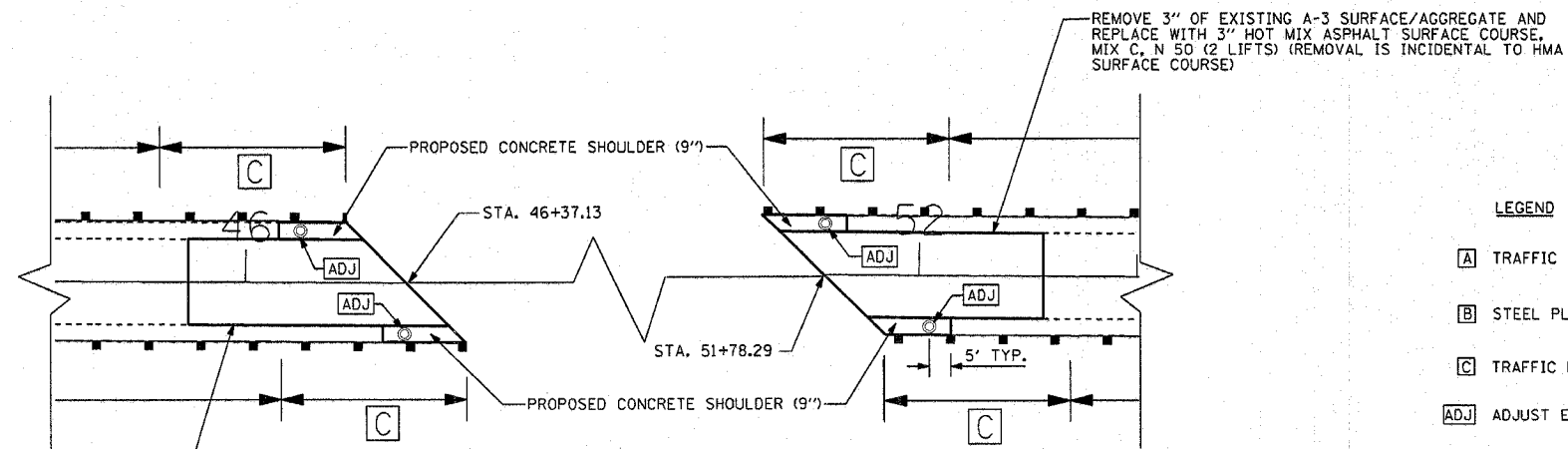
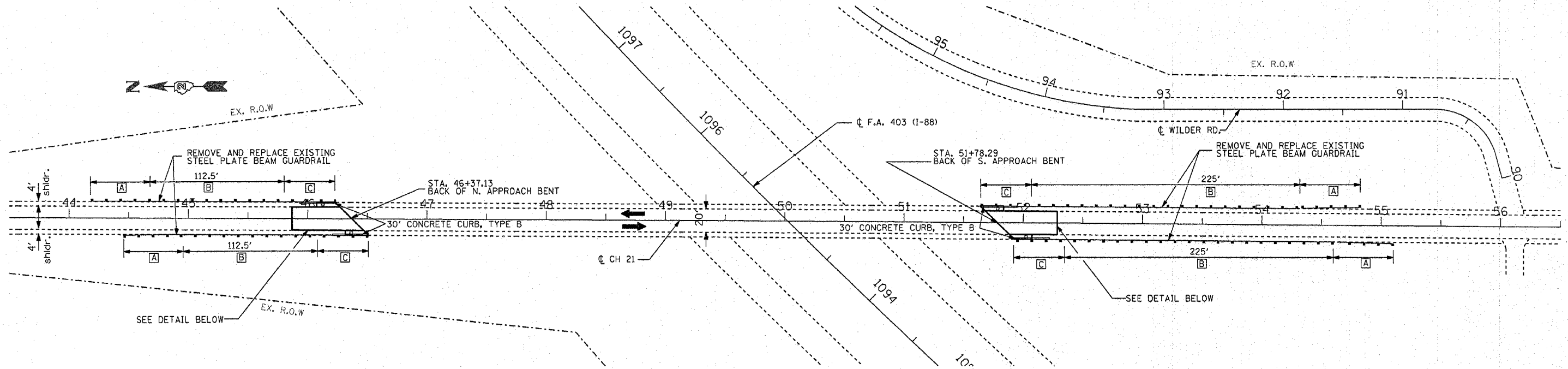

REMOVE 3" OF EXISTING A-3 SURFACE/AGGREGATE AND REPLACE WITH 3" HOT MIX ASPHALT SURFACE COURSE, MIX C, N 50 (2 LIFTS) (REMOVAL IS INCIDENTAL TO HMA SURFACE COURSE)

BRIDGE APPROACH DETAIL  
SCALE: 1"=20'

LEGEND

- [A] TRAFFIC BARRIER TERMINAL, TYPE 1 SPECIAL (TANGENT)
- [B] STEEL PLATE BEAM GUARDRAIL, TYPE A
- [C] TRAFFIC BARRIER TERMINAL, TYPE 6
- [ADJ] ADJUST EXISTING DRAINS TO GRADE

REVISIONS	
NAME	DATE

ILLINOIS DEPARTMENT OF TRANSPORTATION  
 SAND ROAD (CH 21) BRIDGE OVER I-88  
 STRUCTURE NO: 098-0056  
 SECTION: (195-1HB-2)M  
 BRIDGE REHABILITATION  
 PROPOSED PLAN  
 SCALE: 1"=40'  
 DATE 2/7/07  
 DRAWN BY LT  
 CHECKED BY PJ