

F. A. & R.E.	SECTION	COUNTY	TOTAL SHEETS	SHEET NO.
1279	*	LASALLE	43	11
STA.		TO STA.		
FED. ROAD DIST. NO.		BLMMS	FED. AID PROJECT	

*1-RS, (106,107)RS-2, 108 RS-1 & I

**PROJECT BEGINS SOUTH
OF INTERSECTION WITH IL 71
AT STA. 1001 + 29.02**

STA. 1000+00 ILL RTE. 178 =
STA. 20+00 ILL RTE. 71

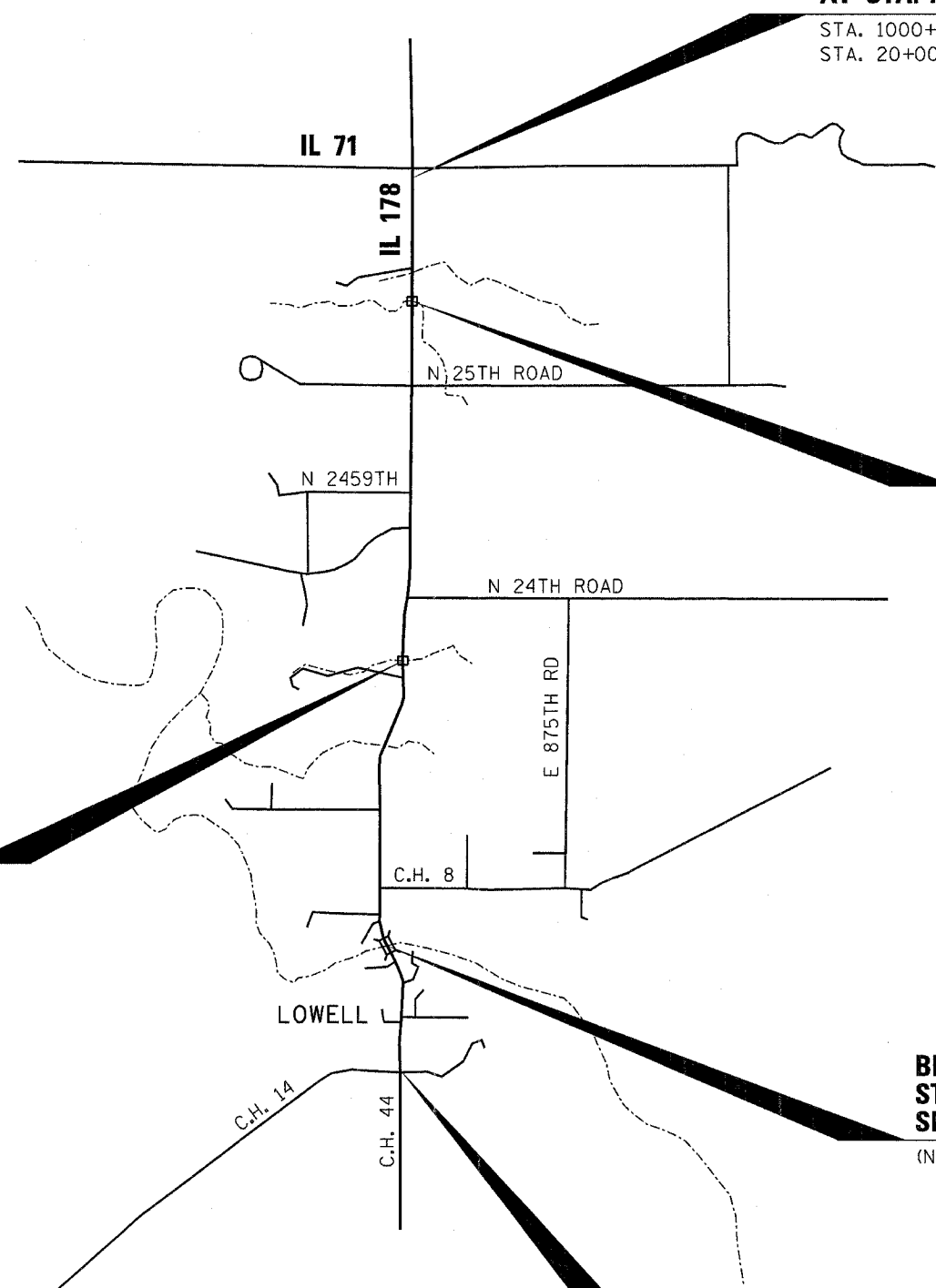

**STA. 1032 + 49.18
PROPOSED SN 050-2041
EXISTING SN 050-0153**

SECTION 1071
STRUCTURE NO. 050-2041
(EXISTING S.N. 050-0153)
10'x6' PRECAST CONCRETE
DOUBLE BOX CULVERT
60' IN LENGTH WITH TWO
CAST-IN-PLACE HEADWALLS

**STA. 1120 + 02.38
PROPOSED SN 050-2040
EXISTING SN 050-0154**

SECTION 1071
STRUCTURE NO. 050-2040
(EXISTING S.N. 050-0154)
12'x8' PRECAST CONCRETE
DOUBLE BOX CULVERT
72' IN LENGTH WITH TWO
CAST-IN-PLACE HEADWALLS
15° SKEW

**BRIDGE OMISSION
STA. 1194 + 63.75 TO STA. 1198 + 95.75
SN 050-0096**

(NO WORK REQUIRED)

**PROJECT ENDS SOUTH
OF INTERSECTION WITH C.H. 14
AT STA. 1229 + 01.85**

STA. 1227+98.35 ILL RTE. 178 =
STA. 15+03.03 C.H. 14

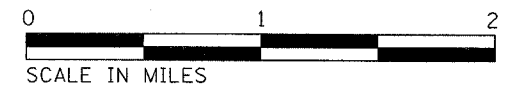

REVISIONS	
NAME	DATE

ILLINOIS DEPARTMENT OF TRANSPORTATION

LOCATION MAP

SCALE: VERT.
HORIZ.
DATE

DRAWN BY
CHECKED BY

DATE: TIME: c:\projects\ep02001\defat1.s.dgn