

FAS RTE	SECTION	COUNTY	TOTAL SHEETS	SHEET NO.
1279	1071	LaSALLE	43	17
STA. 1029+00		TO STA. 1036+00		
FED. ROAD DIST. NO.	ILLINOIS	FED. AID PROJECT AID		

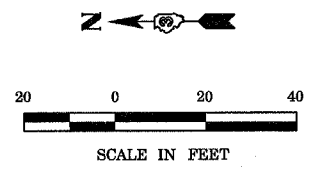

**SCHEDULE OF QUANTITIES**

RELOCATE TEMPORARY CONCRETE BARRIER	STATION TO	STATION	FEET
	1030+90	1034+10	320
			TOTAL 320

IMPACT ATTENUATORS, RELOCATE (NON-REDIRECTIVE), TEST LEVEL 3 - 2 EACH

**GENERAL NOTES**

1. TRAFFIC CONTROL SHALL BE ERECTED AS SHOWN AND ACCORDING TO "TRAFFIC CONTROL AND PROTECTION, STANDARD 701321."
2. SEE SPECIAL PROVISIONS FOR ADDITIONAL TRAFFIC CONTROL REQUIREMENTS.
3. COORDINATE LOCATION OF SIGNALS WITH FINAL WORK AS DIRECTED BY THE ENGINEER.

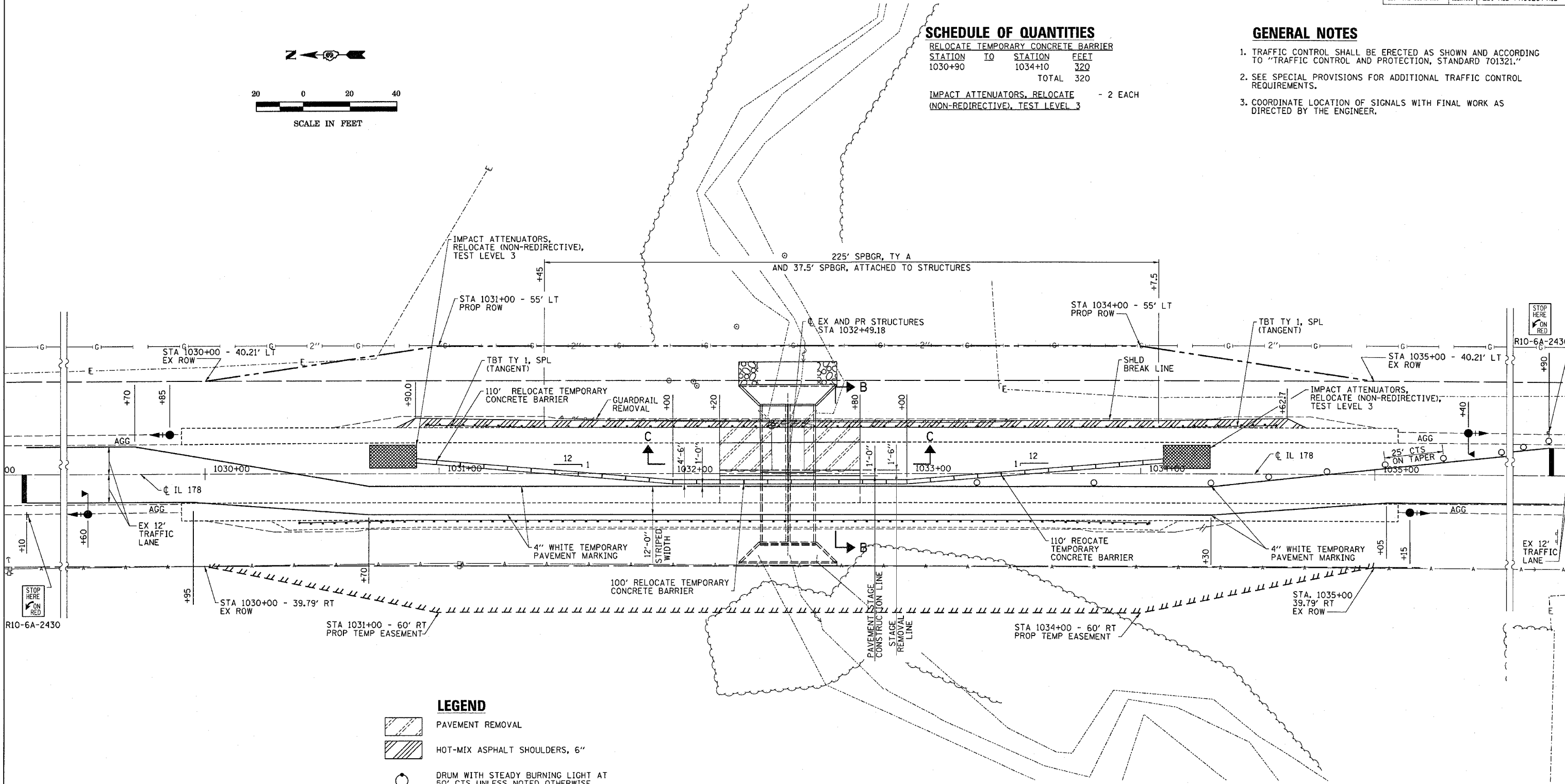

**LEGEND**

- PAVEMENT REMOVAL
- HOT-MIX ASPHALT SHOULDERS, 6"
- DRUM WITH STEADY BURNING LIGHT AT 50' CTS UNLESS NOTED OTHERWISE
- TRAFFIC SIGNAL WITH BACKPLATE, SIGNAL DIRECTION INDICATED
- TC 26B MICROWAVE ON ARM

**ESCA**  
CONSULTANTS, INC.

DESIGNED BY:	MTD	01/06
DRAWN BY:	HAG	01/06
CHECKED BY:	MTD	05/06
APPROVED BY:	RDP	05/06

**STAGE II**  
**CONSTRUCTION**  
FAS 1279 (IL 178)  
SECTION 1071  
LaSALLE COUNTY  
STATION 1032+49.18