

F.A.U. RTE.	SECTION	COUNTY	TOTAL SHEETS	SHEET NO.
5952	Q-BR	GRUNDY	86	14
STA.		TO STA.		
FED. ROAD DIST. NO. 7		ILLINOIS FED. AID PROJECT		

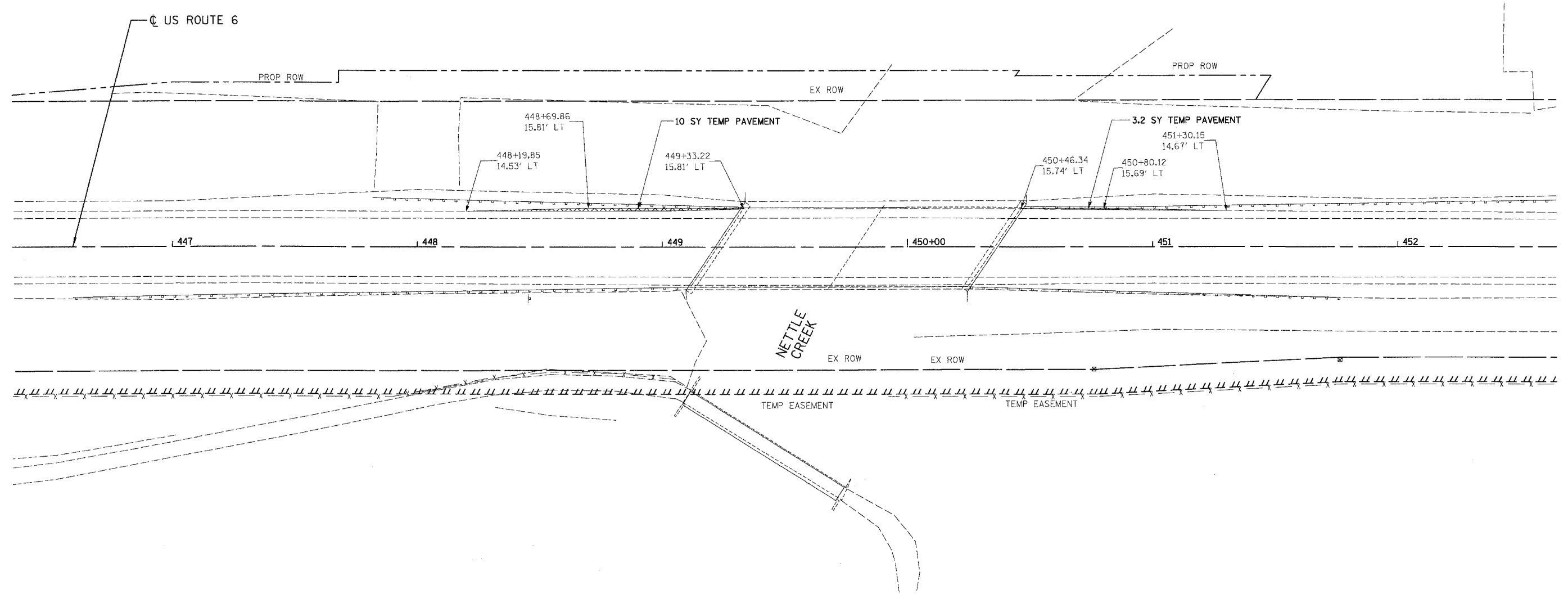

NOTE: TRAFFIC TO BE CONTROLLED USING STD 701326 DURING PRE-STAGE PAVEMENT WIDENING.

REVISIONS	
NAME	DATE

ILLINOIS DEPARTMENT OF TRANSPORTATION

U.S. ROUTE 6
MAINTENANCE OF TRAFFIC
PRE-STAGE

SCALE: VERT. 1" = 20'
HORIZ. 1" = 20'
DATE 3/19/07

DRAWN BY DDM
CHECKED BY JMD

BOWMAN, BARRETT
& ASSOCIATES INC.
CONSULTING ENGINEERS
130 E. RANDOLPH STREET
CHICAGO, ILLINOIS 60601
JOB NO. 541



N:\S\116000\civil\66594_Nettle_Creek\5Steps_Pref_Net.dgn 3/19/2007 4:49:09 PM
 default