

F.A.I.D. RTE.	SECTION	COUNTY	TOTAL SHEETS	SHEET NO.
5952	D-BR	GRUNDY	86	16
STA.		TO STA.		
FED. ROAD DIST. NO. 7		ILLINOIS FED. AID PROJECT		

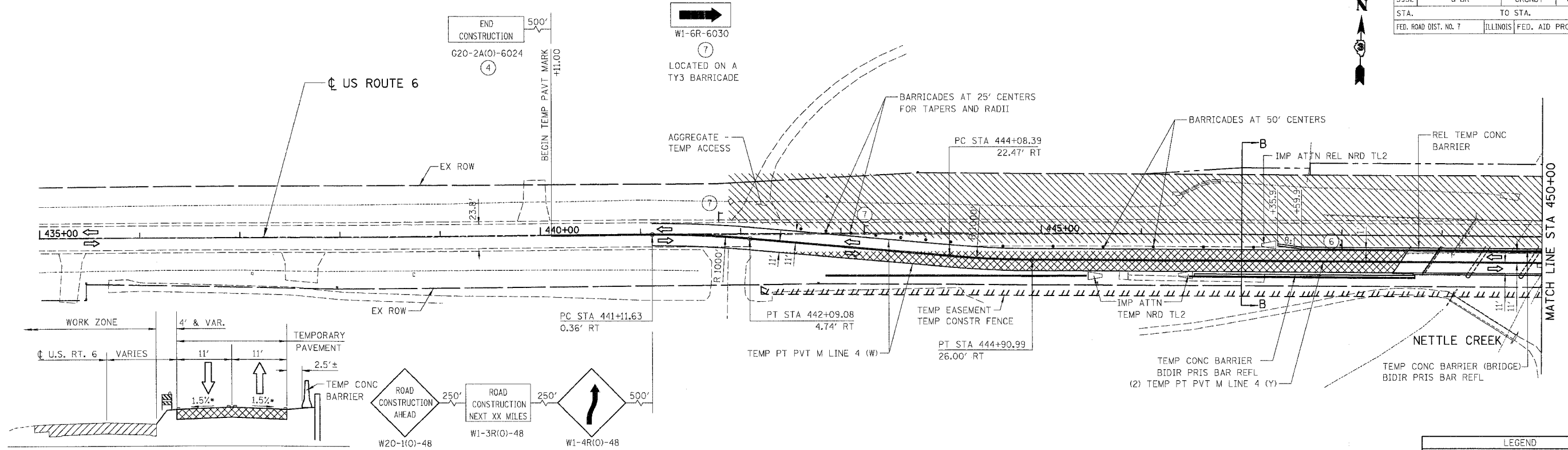

SECTION B-B
 * NOTE: CONSTRUCT TEMPORARY PAVEMENT FOLLOWING PROPOSED PROFILE; WARP CROSS SLOPE AS DIRECTED BY THE ENGINEER TO MEET EXISTING PAVEMENT AND PROPOSED BRIDGE APPROACH PAVEMENT.

NOTE: PAVT MARK TAPE T3 4 WILL BE USED ON BRIDGE AND BRIDGE APPROACHES

LEGEND	
	WORK ZONE
	TEMP. PAVEMENT (8.75")
	DRUM OR TYPE II BARRICADE
	TRAFFIC SIGN
	TRAFFIC FLOW DIRECTION
	TYPE III BARRICADE

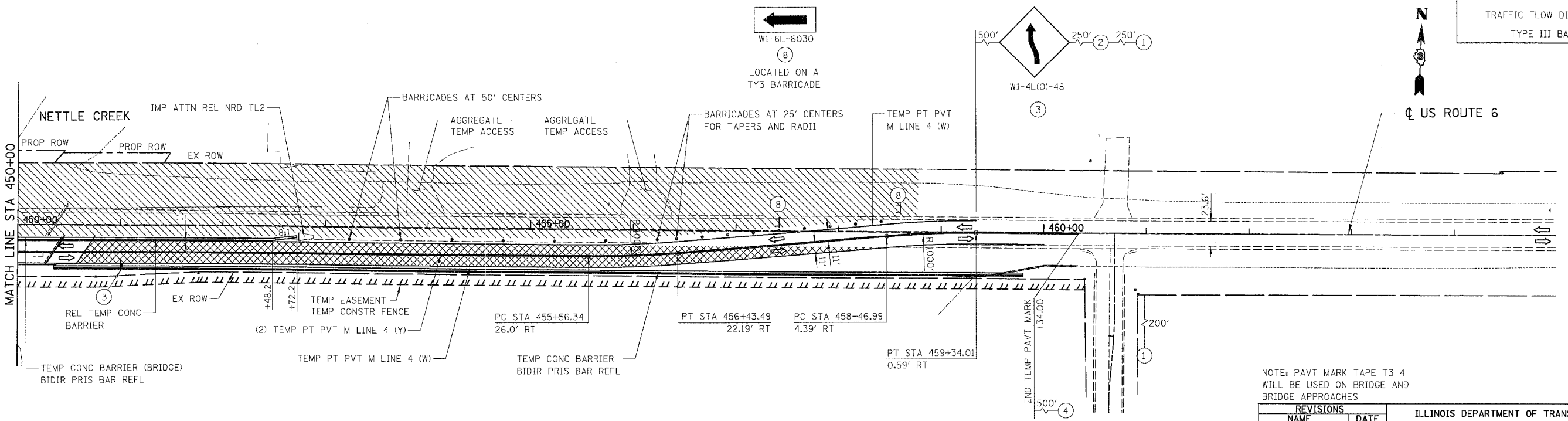

NOTE: PAVT MARK TAPE T3 4 WILL BE USED ON BRIDGE AND BRIDGE APPROACHES

REVISIONS	
NAME	DATE

ILLINOIS DEPARTMENT OF TRANSPORTATION

U.S. ROUTE 6
 MAINTENANCE OF TRAFFIC
 STAGE 2

SCALE: VERT. NTS
 HORIZ. 1" = 50'

DATE 3/19/07

DRAWN BY JAM
 CHECKED BY ODM

BOWMAN, BARRETT & ASSOCIATES INC.
 CONSULTING ENGINEERS
 130 E. RANDOLPH STREET
 CHICAGO, ILLINOIS 60601
 JOB NO. 541

N:\51\road\66594\66594 Nettle Creek\541nc122.nc.dgn 3/19/2007 4:50:06 PM default