

| F.A.U. RTE. | SECTION | COUNTY | TOTAL SHEETS | SHEET NO. |
|-----------------------|---------|---------------------------|--------------|-----------|
| 5952 | Q-BR | GRUNDY | 86 | 39 |
| STA. | | TO STA. | | |
| FED. ROAD DIST. NO. 7 | | ILLINOIS FED. AID PROJECT | | |

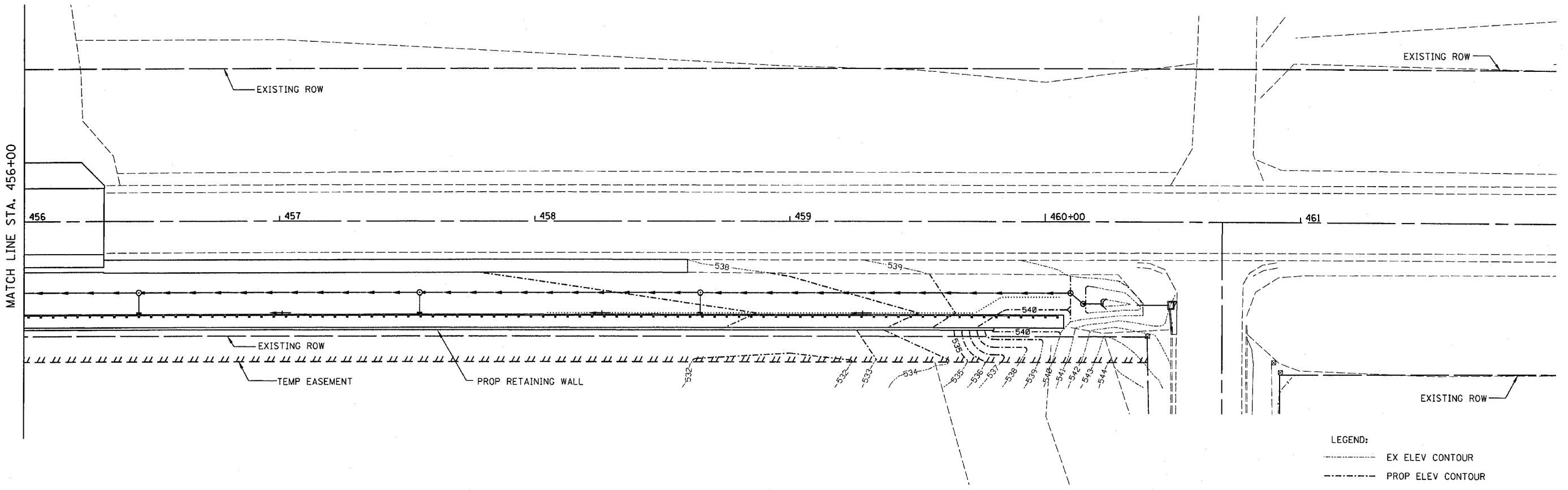

LEGEND:
 - - - - - EX ELEV CONTOUR
 - - - - - PROP ELEV CONTOUR
 PROP SWALE / DITCH INVERT
 SEE DRAINAGE PLANS FOR OTHER LEGEND ITEMS

NOTE: PROPOSED GRADING CONTOURS
 PROVIDED ONLY TO SUPPLEMENT CROSS
 SECTION DRAWINGS IN AREAS NOT CLEARLY
 SHOWN BY CROSS SECTIONS



MATCH LINE STA. 456+00

5/17/2007 8:15 AM duncanbd

BOWMAN, BARRETT & ASSOCIATES INC.
 CONSULTING ENGINEERS
 130 E. RANDOLPH STREET
 CHICAGO, ILLINOIS 60601
 JOB NO. 541



| REVISIONS | |
|-----------|--------|
| NAME | DATE |
| BDD | 5/1/07 |
| | |
| | |
| | |
| | |
| | |
| | |
| | |
| | |

ILLINOIS DEPARTMENT OF TRANSPORTATION
 U.S. ROUTE 6
 PROPOSED GRADING CONTOURS

SCALE: VERT. DRAWN BY DDM
 HORIZ. CHECKED BY JMD
 DATE *SDATE