

ROUTE NO.	SECTION	COUNTY	TOTAL SHEETS	SHEET NO.	SHEET NO. S16
FAU 5952	Q	GRUNDY	86	55	OF 526 SHEETS
FED. ROAD DIST. NO. 7	ILLINOIS	FED. AID PROJECT			

STATE OF ILLINOIS
DEPARTMENT OF TRANSPORTATION

***Alternate w/ v(E) bars and place parallel to beams

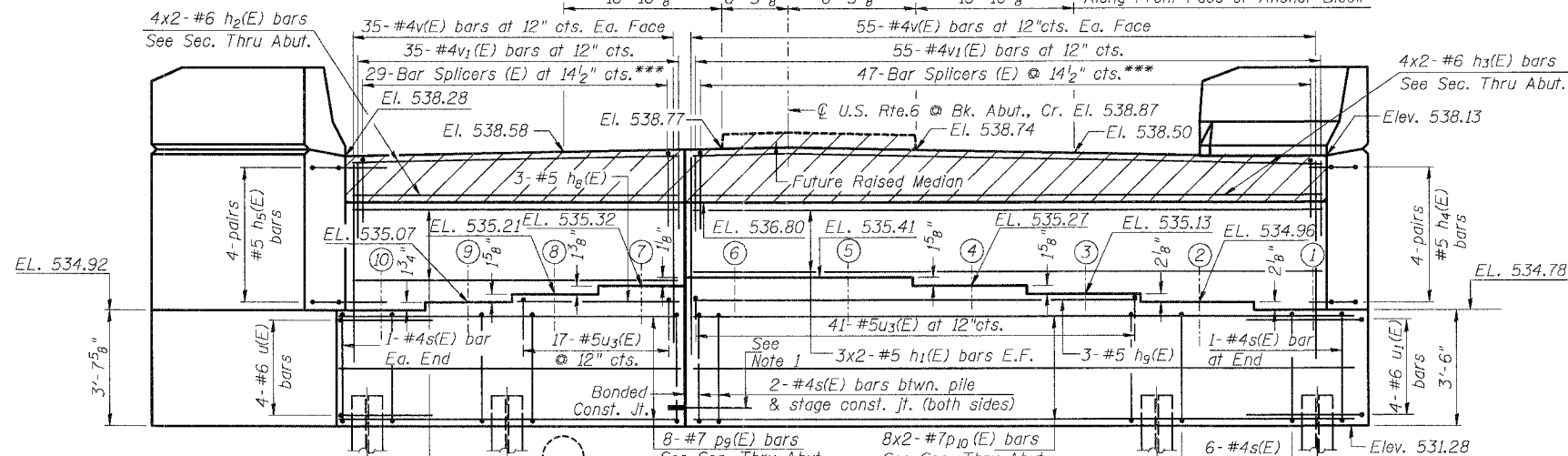

ELEVATION
(Looking West)

Notes:
1. Provide 8-Bar Splicers (E) for #7 p9(E) bars, 3-Bar Splicers (E) for #5 h8(E) bars, 6-Bar Splicers (E) for #5 h(E) bars and 4-Bar Splicers (E) for #6 h2(E) bars.

PILE DATA
Type & Size: Steel HP 10x42
Nominal Required Bearing: 330 kips
Allowable Resistance Available: 110 kips
Est. Length: 21'
No. Required: 22
No. of Test Piles: 1

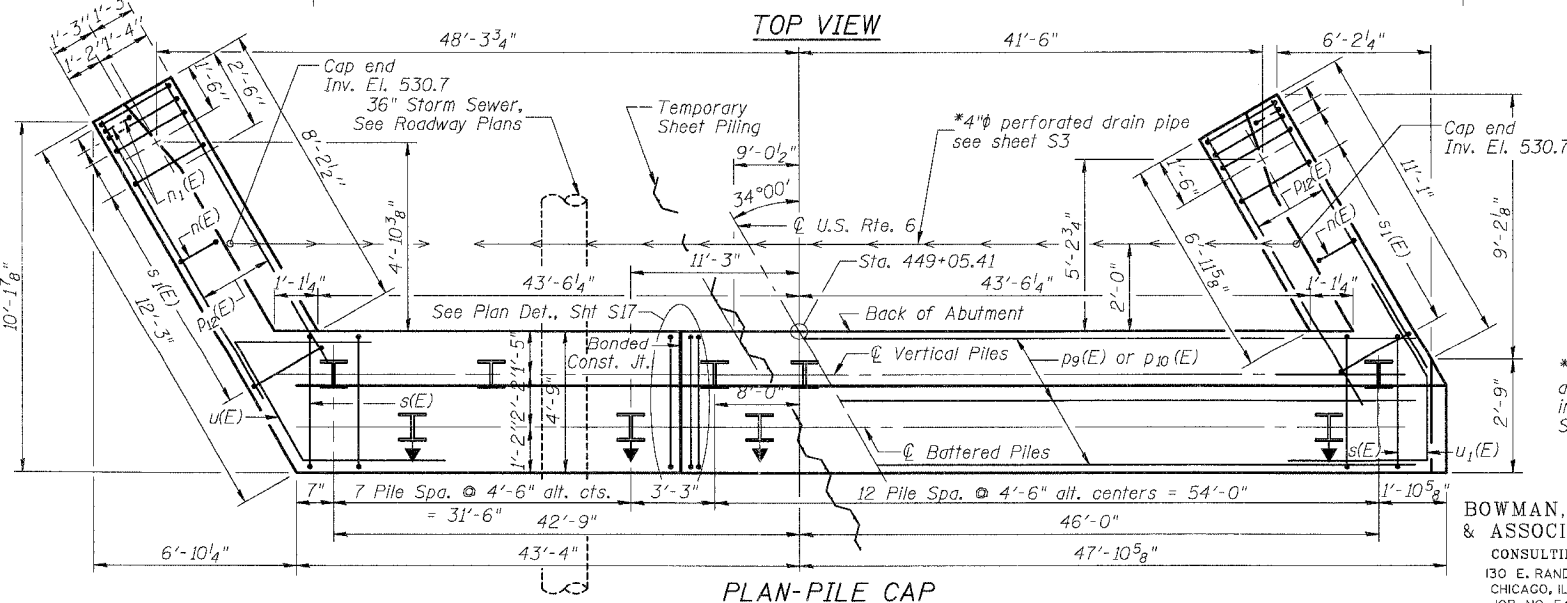

PLAN-PILE CAP

MIN. BAR LAP

#5	2'-2"
#6	2'-7"
#7	3'-5"

**WEST ABUTMENT
BILL OF MATERIAL**

Bar	No.	Size	Length	Shape
h(E)	12	#5	18'-5"	
h1(E)	12	#5	28'-8"	
h2(E)	8	#6	18'-5"	
h3(E)	8	#6	28'-8"	
h4(E)	8	#5	5'-2"	L
h5(E)	8	#5	6'-9"	L
h6(E)	16	#4	10'-9"	
h7(E)	16	#4	9'-9"	
h8(E)	3	#5	16'-1"	
h9(E)	3	#5	39'-6"	
n(E)	18	#6	11'-8"	
n1(E)	12	#6	5'-10"	
p9(E)	8	#7	33'-0"	
p10(E)	16	#7	30'-3"	
p12(E)	12	#7	10'-9"	
s(E)	120	#4	15'-11"	
s1(E)	28	#4	9'-5"	
u(E)	4	#6	13'-4"	L
u1(E)	4	#6	10'-2"	L
u3(E)	58	#5	8'-2"	
v(E)	180	#4	5'-0"	
v1(E)	90	#4	3'-4"	
v2(E)	90	#5	2'-0"	
v3(E)	16	#6	6'-2"	
v4(E)	22	#6	5'-10"	
v5(E)	6	#6	5'-4"	
Structure Excavation	Cu. Yd.		105	
Concrete Structures	Cu. Yd.		82.1	
Reinforcement Bars, Epoxy Coated	Pound		7330	
Furnishing Steel Piles	Foot		462	
HP10x42 Driving Piles	Foot		462	
Test Pile Steel	Each		1	
HP10x42 Pile Shoes	Each		23	
Geocomposite Wall Drain	Sq. Yd.		54	
Bar Splicers	Each		97	
Concrete Sealer	Sq. Ft.		255	

Reinforcement bars designated (E) shall be epoxy coated.
Bars indicated thus 8x2-#7 etc. indicate 8 lines of bars with 2 lengths per line.
For Detail A & B see sheet S17.
Space reinforcement in cap to miss anchor bolts.
Four steps monolithically with cap.
The test pile shall be driven to 110 percent of the Nominal Required Bearing indicated in the pile data information.
The steel H-piles shall be according to AASHTO M270 Grade 50.

**WEST ABUTMENT
U.S. ROUTE 6 OVER
NETTLE CREEK
FAU 5952-SEC. Q-BR
GRUNDY COUNTY
STATION 449+79.12
S.N. 032-0107**

BOWMAN, BARRETT & ASSOCIATES INC.
CONSULTING ENGINEERS
130 E. RANDOLPH STREET
CHICAGO, ILLINOIS 60601
JOB NO. 541

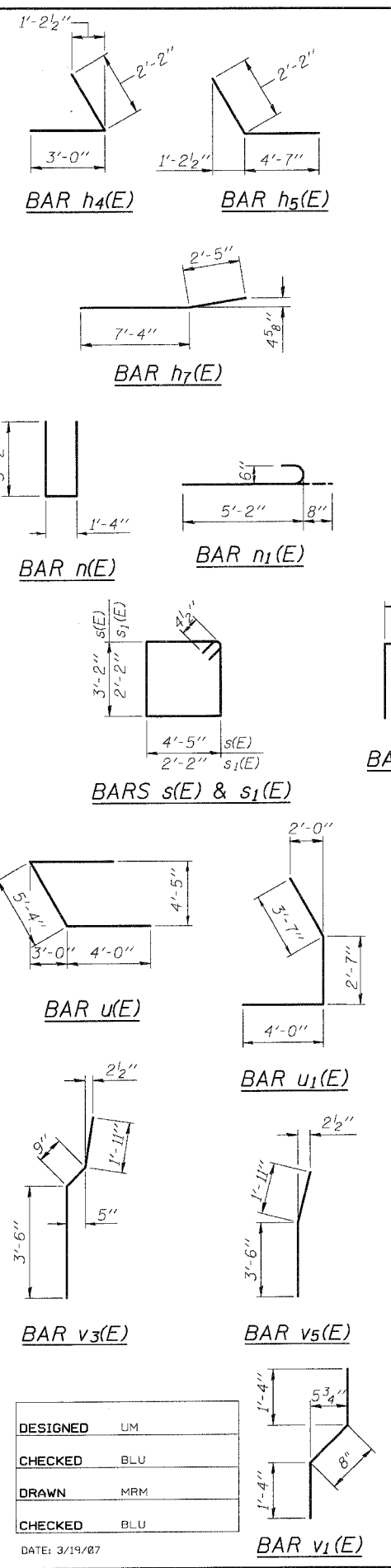

DESIGNED	UM
CHECKED	BLU
DRAWN	MRM
CHECKED	BLU

DATE: 3/19/87