

F.A.I. RTE.	SECTION	COUNTY	TOTAL SHEETS	SHEET NO.
39		LASALLE	16	11

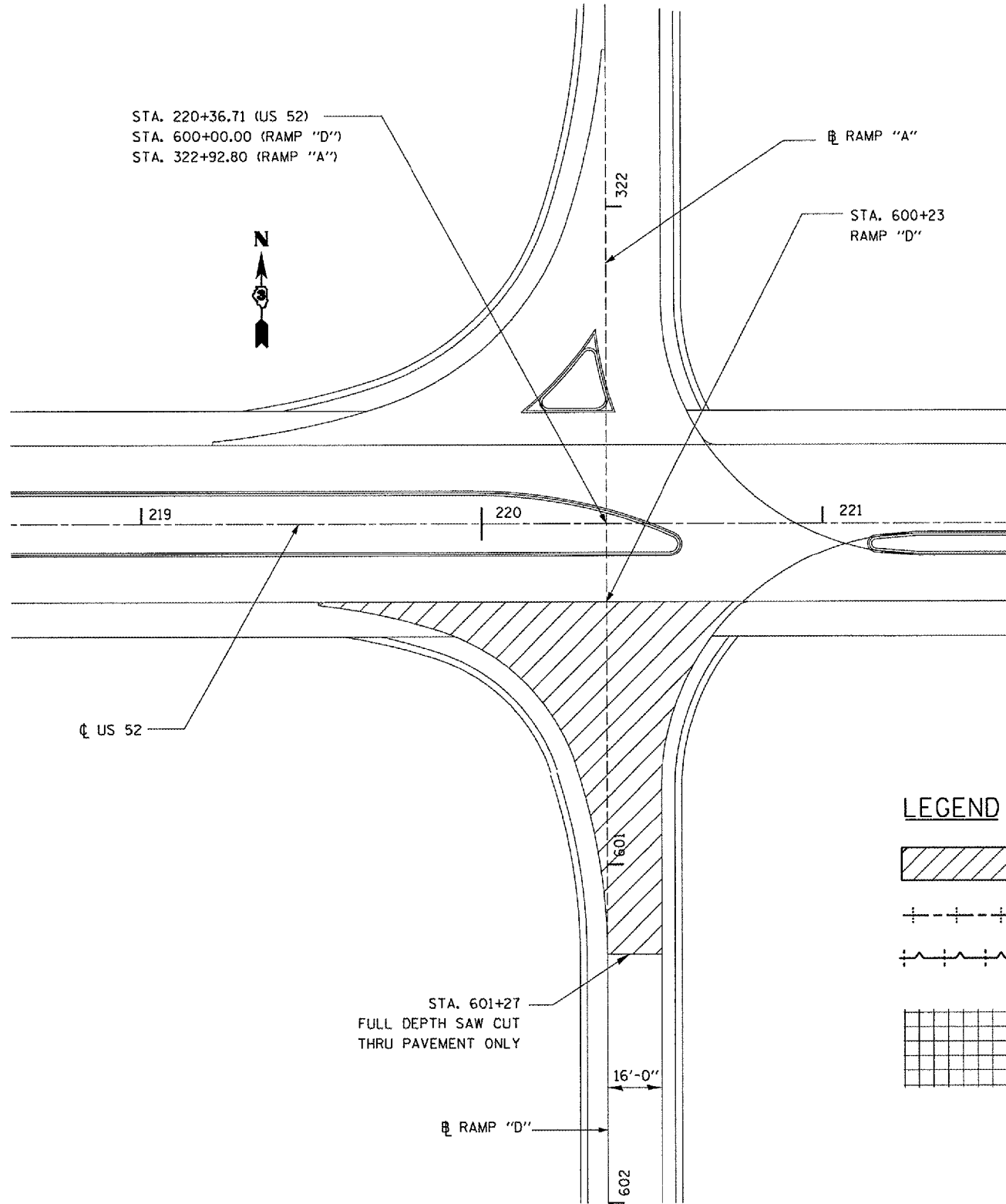

*50(1,2,3,4,5,6,7,8)PATCHING



STA. 220+36.71 (US 52)
 STA. 600+00.00 (RAMP "D")
 STA. 322+92.80 (RAMP "A")

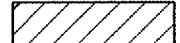
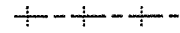

LEGEND

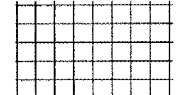
-  PAVEMENT REMOVAL
-  DOWEL BAR ASSEMBLIES
-  KEYED LONGITUDINAL JOINT W/TIE BARS
-  PAVEMENT FABRIC

STA. 601+27
 FULL DEPTH SAW CUT
 THRU PAVEMENT ONLY

EXISTING PAVEMENT DETAILS

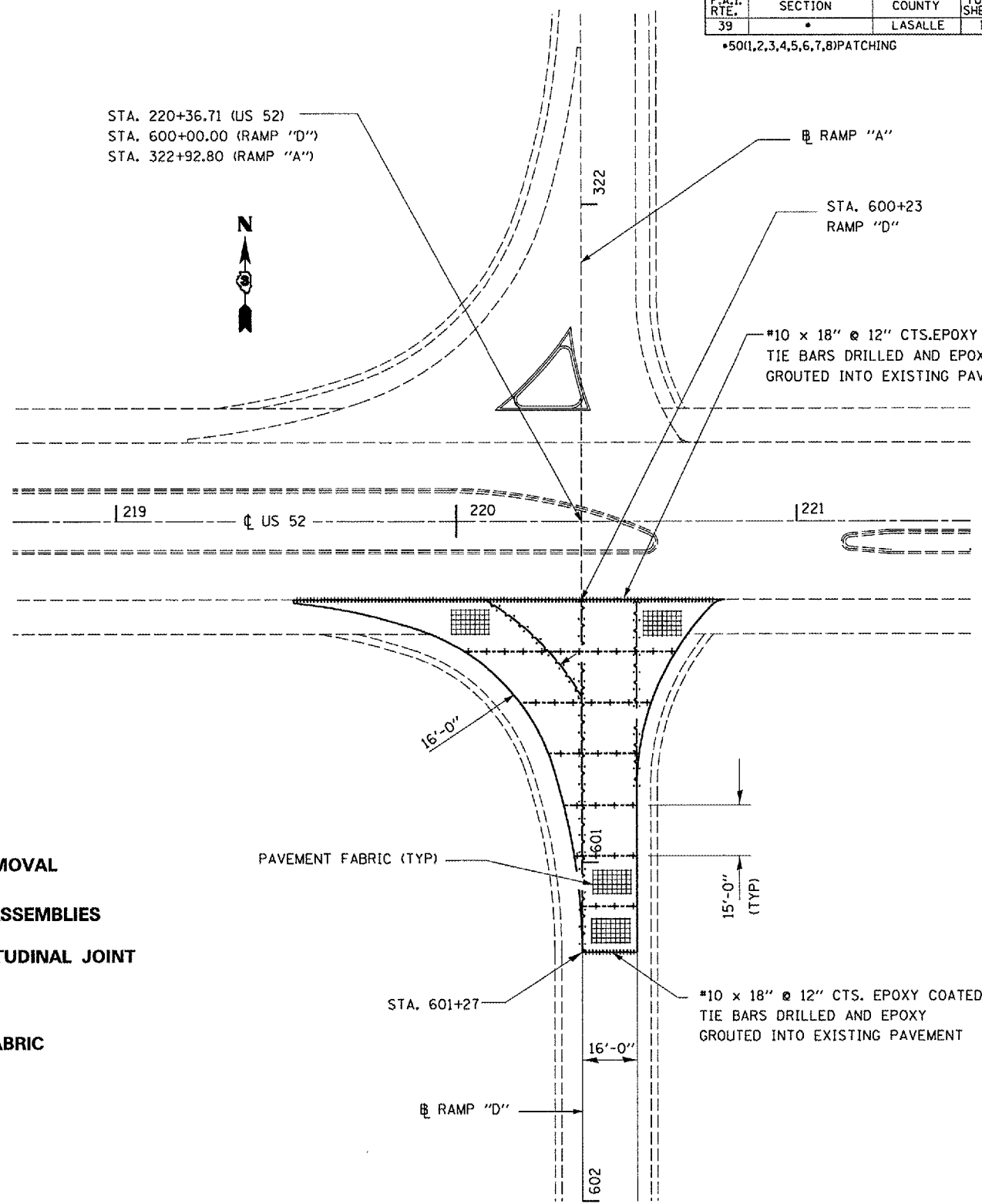

STA. 220+36.71 (US 52)
 STA. 600+00.00 (RAMP "D")
 STA. 322+92.80 (RAMP "A")



*10 x 18" @ 12" CTS. EPOXY COATED
 TIE BARS DRILLED AND EPOXY
 GROUTED INTO EXISTING PAVEMENT

*10 x 18" @ 12" CTS. EPOXY COATED
 TIE BARS DRILLED AND EPOXY
 GROUTED INTO EXISTING PAVEMENT

PROPOSED PAVEMENT DETAILS

REVISIONS	
NAME	DATE

ILLINOIS DEPARTMENT OF TRANSPORTATION
PAVEMENT DETAILS - RAMP "D"
 FAI ROUTE 39 (I-39)
 SECTION 50(1,2,3,4,5,6,7,8)PATCHING
 LASALLE COUNTY

Date: February 27, 2007
 c:\projects\main08\cm304\details.dgn