

F.A.I. RTE.	SECTION	COUNTY	TOTAL SHEETS	SHEET NO.
57	46(1,2,3)PATCHING	KANKAKEE	16	14

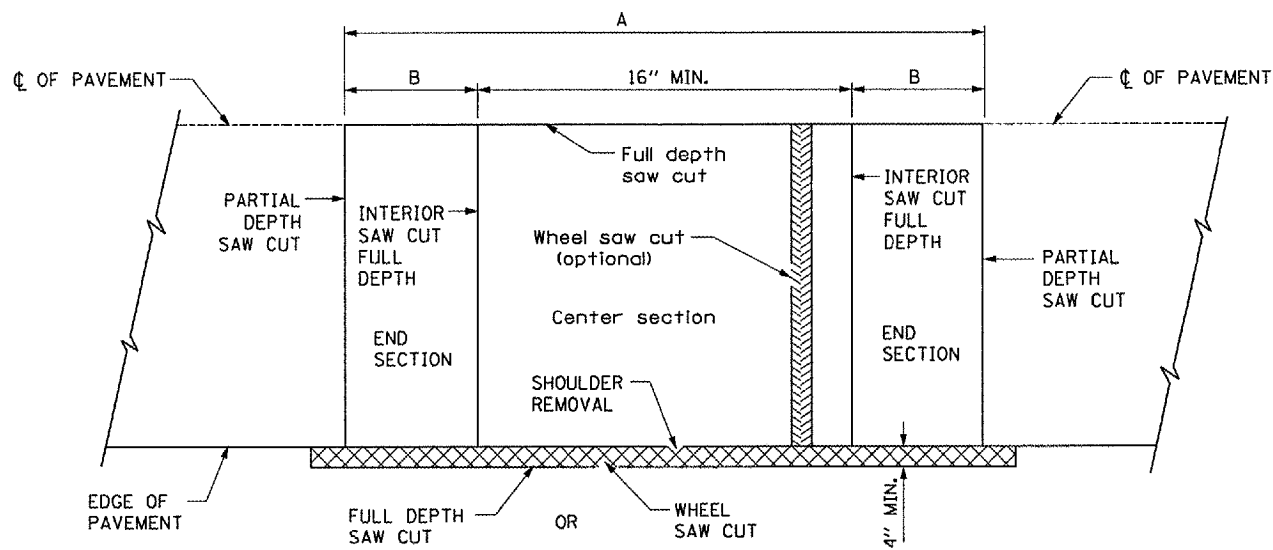

**EXISTING PAVEMENT SAWING DETAIL**  
(AGAINST BITUMINOUS SHOULDER)

EXISTING LONGITUDINAL REINFORCEMENT BARS	A (min.)	B (min.)	C (min.)
No. 6	6'-0"	24"	19"

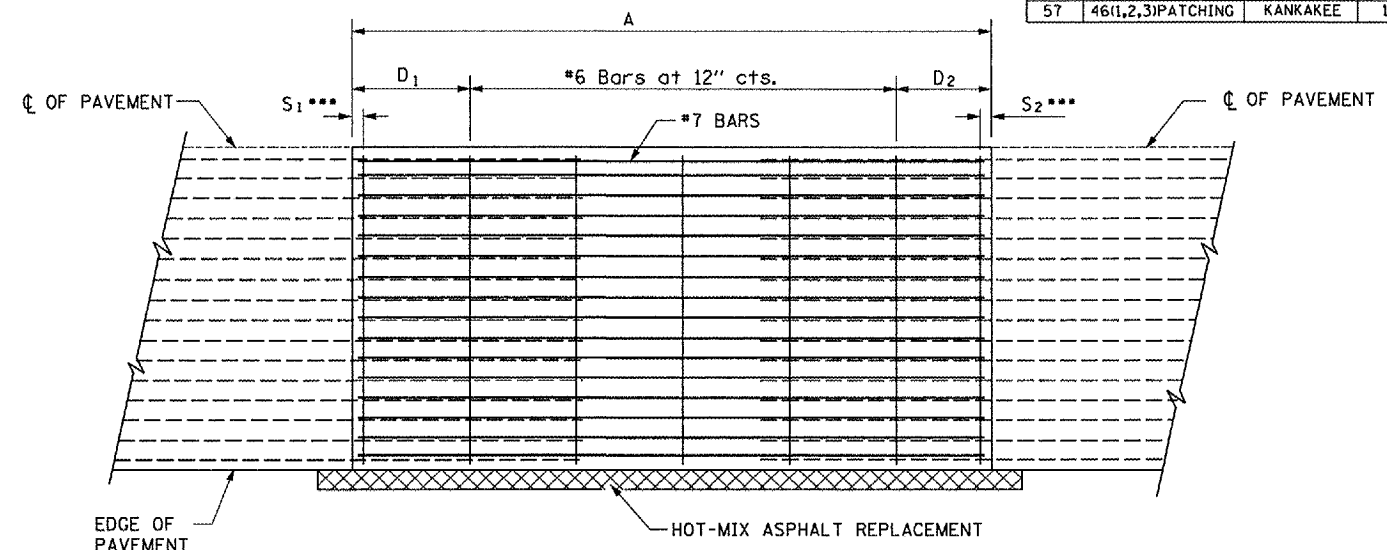

**PROPOSED PAVEMENT DETAIL**  
(AGAINST BITUMINOUS SHOULDER)

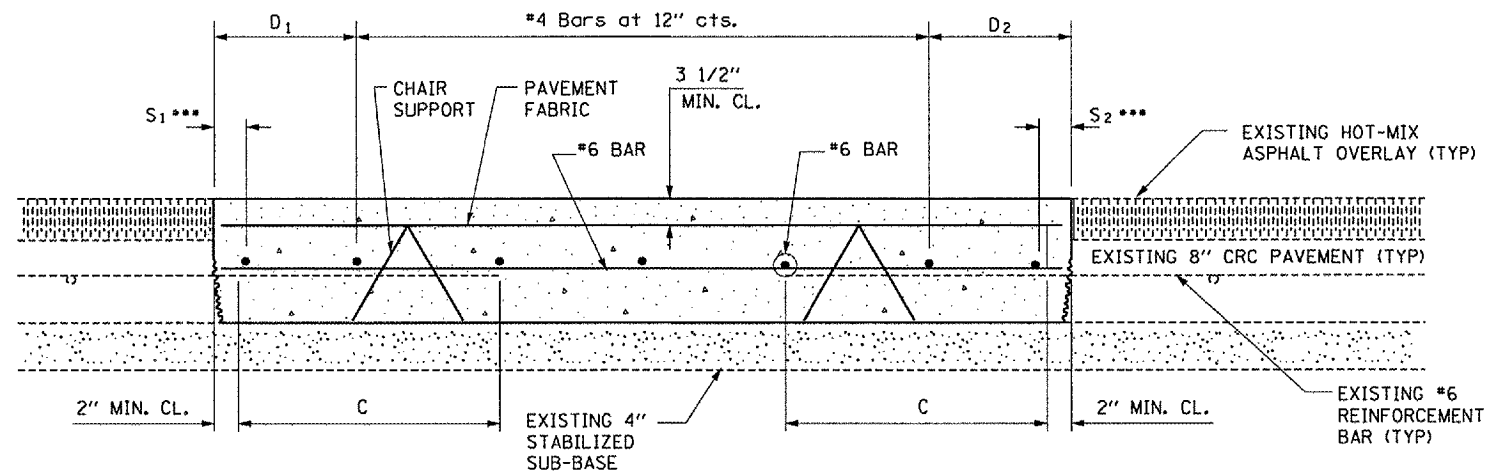

**PROPOSED CLASS A PATCHING DETAIL**

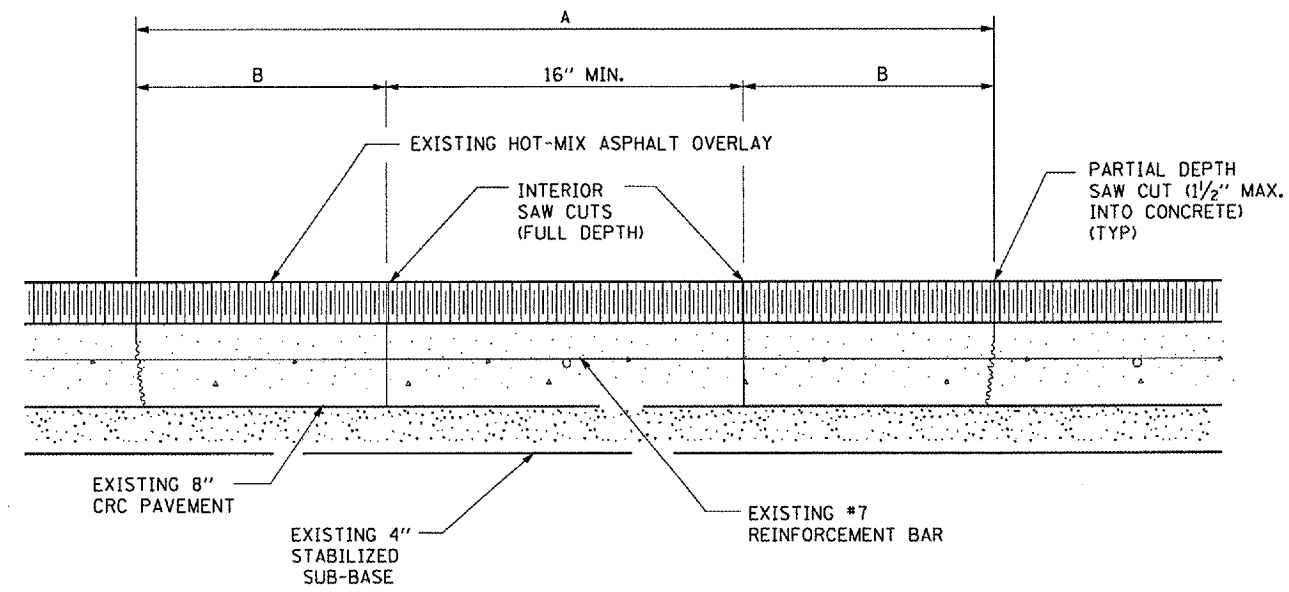

**EXISTING PAVEMENT SAW CUTTING DETAIL**

- NOTES:**
- EVERY 3rd INTERSECTION MUST BE TIED
  - LAP NEW REINFORCEMENT WITH EXISTING LONGITUDINAL REINFORCEMENT
  - VARIABLES: WHERE S<sub>1</sub> AND S<sub>2</sub> ARE 2 1/2" MIN. AND 12" MAX. D<sub>1</sub> = 2(S<sub>1</sub>) AND D<sub>2</sub> = 2(S<sub>2</sub>)

REVISIONS	
NAME	DATE

ILLINOIS DEPARTMENT OF TRANSPORTATION  
**CLASS A PATCHING DETAILS**  
FAI ROUTE 57 (I-57)  
SECTION 46(1,2,3)PATCHING  
KANKAKEE COUNTY

Date: MARCH 29, 2007  
C:/projects/cm308/cm308/details.dgn