

ROUTE		SECTION	COUNTY	SHEET	
MKD.	FAP	D-4 PAVT. MARKING 2007	PEORIA	TOTAL	NO.
US 150	317			14	6

D-94-111-06
CONTRACT NO. 68642

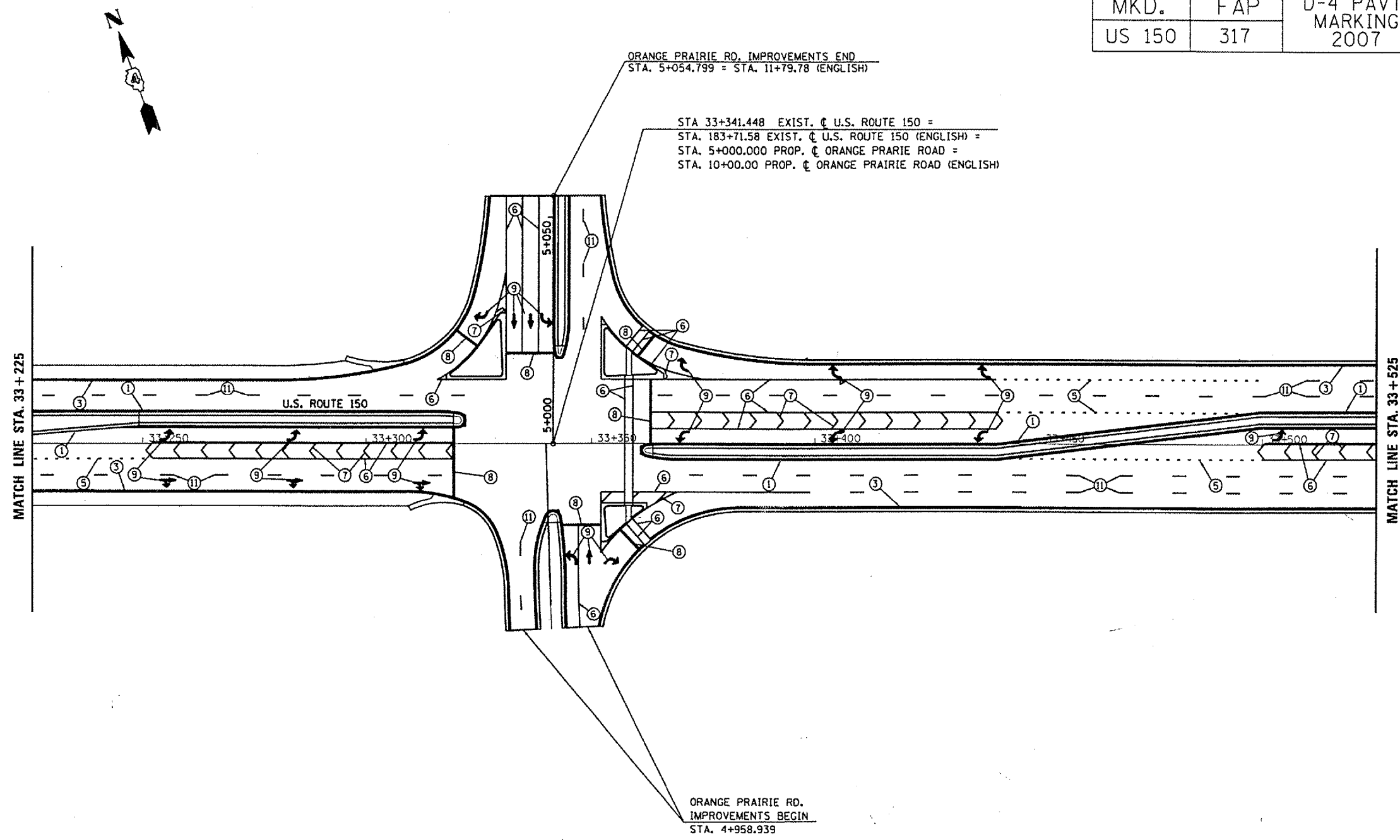

ORANGE PRAIRIE RD. IMPROVEMENTS END
STA. 5+054.799 = STA. 11+79.78 (ENGLISH)

STA 33+341.448 EXIST. C U.S. ROUTE 150 =
STA. 183+71.58 EXIST. C U.S. ROUTE 150 (ENGLISH) =
STA. 5+000.000 PROP. C ORANGE PRAIRIE ROAD =
STA. 10+00.00 PROP. C ORANGE PRAIRIE ROAD (ENGLISH)

ORANGE PRAIRIE RD.
IMPROVEMENTS BEGIN
STA. 4+958.939

PAVEMENT MARKING LEGEND

- ① PREFORMED PLASTIC PAVEMENT MARKING - LINE 4" YELLOW SOLID
- ② PREFORMED PLASTIC PAVEMENT MARKING - LINE 4" YELLOW SOLID (DOUBLE LINE)
- ③ PREFORMED PLASTIC PAVEMENT MARKING - LINE 4" WHITE SOLID
- ④ PREFORMED PLASTIC PAVEMENT MARKING - LINE 4" YELLOW SKIP DASH
- ⑤ PREFORMED PLASTIC PAVEMENT MARKING - LINE 8" WHITE SKIP DASH
- ⑥ PREFORMED PLASTIC PAVEMENT MARKING - LINE 8" WHITE SOLID
- ⑦ PREFORMED PLASTIC PAVEMENT MARKING - LINE 12" WHITE SOLID
- ⑧ PREFORMED PLASTIC PAVEMENT MARKING - LINE 24" WHITE SOLID (STOP BAR)
- ⑨ PREFORMED PLASTIC PAVEMENT MARKING - LETTERS AND SYMBOLS
- ⑩ PREFORMED PLASTIC PAVEMENT MARKING - LINE 12" YELLOW SOLID
- ⑪ PREFORMED PLASTIC PAVEMENT MARKING - LINE 6" WHITE SKIP DASH

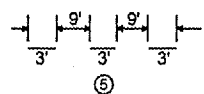
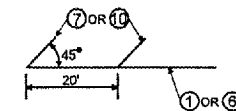
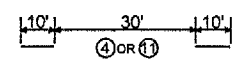

ILLINOIS DEPARTMENT OF TRANSPORTATION
PAVEMENT MARKING DETAIL