

F.A.P. RTE.	SECTION	COUNTY	TOTAL SHEETS	SHEET NO.
317	*	PEORIA	22	8
STA. 215+18.77		TO STA. 246+46.02		
FED. ROAD DIST. NO. 4 ILLINOIS FED. AID PROJECT				
* D4 JOINT REPAIR 2007-3				

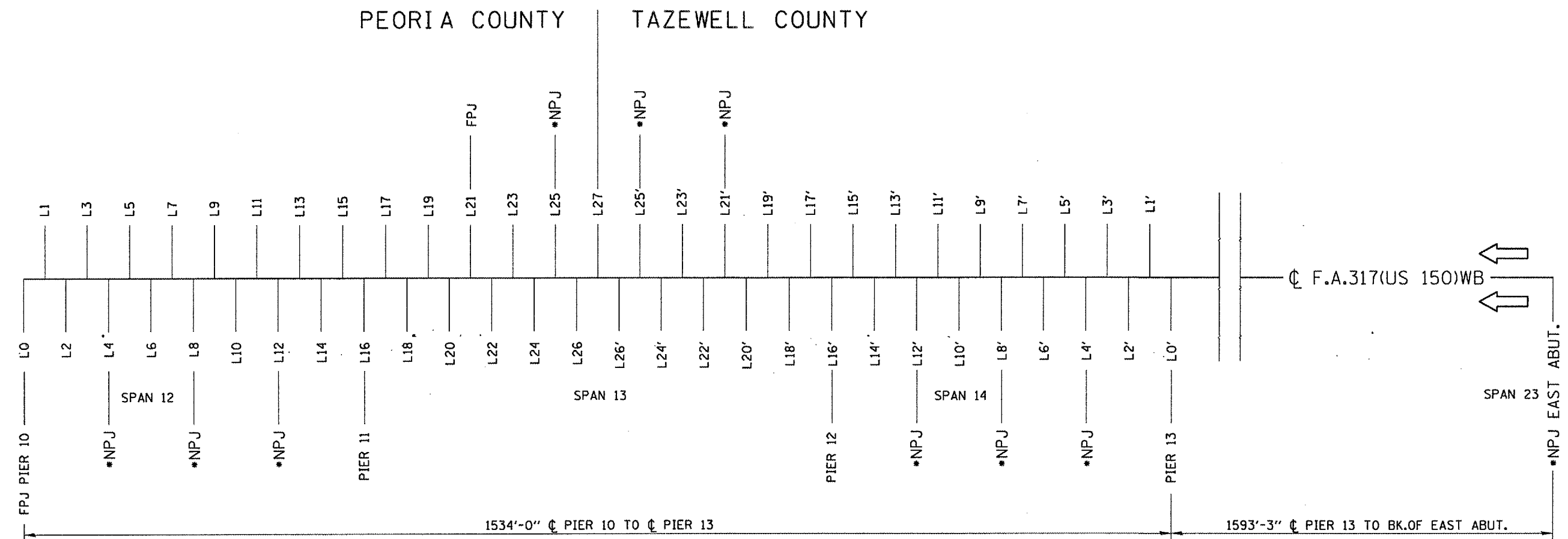

**JOINT REPLACEMENT
PLAN**

- LEGEND
- FPJ = FINGERPLATE JOINT
 - NPJ = NEOPRENE JOINT
 - *NPJ = TO BE REPLACED w/STRIP SEAL
 - L = TRUSS LOW POINT

NOTE
 * NPJ - A Protective Shield System according to Article 501.03 shall be constructed and maintained under the bridge deck at each of these joint locations during removal and replacement. The protective shield shall be 10' wide, centered on joint, out to out of deck, Typ.

PLOT DATE * DATE *
 FILE NAME * REFERENCE *
 PLOT SCALE * REFERENCE *
 PLOT SHEET * REFERENCE *

REVISIONS	NAME	DATE

SN.090-0115 US24/150
 over IL. River

ILLINOIS DEPARTMENT OF TRANSPORTATION

**STRUCTURE
LINE DIAGRAM**

SCALE: VERT. DRAWN BY CEJ
 HORIZ. CHECKED BY
 DATE 02-07-2007