

F.A.P. RTE.	SECTION #	COUNTY	TOTAL SHEETS	SHEET NO.
820	*	DOUGLAS	57	1

\*(37,37-1,2&3)RS-1

STATE OF ILLINOIS  
 DEPARTMENT OF TRANSPORTATION  
 DIVISION OF HIGHWAYS

# PROPOSED HIGHWAY PLANS

FAP ROUTE 820 (IL 130)  
 SECTION (37,37-1,2&3)RS-1  
 DOUGLAS COUNTY  
 PROJECT F-0820 (012)  
 C-95-118-02

RESURFACING (3P) FROM US 36 TO COLES COUNTY LINE

D-95-070-02

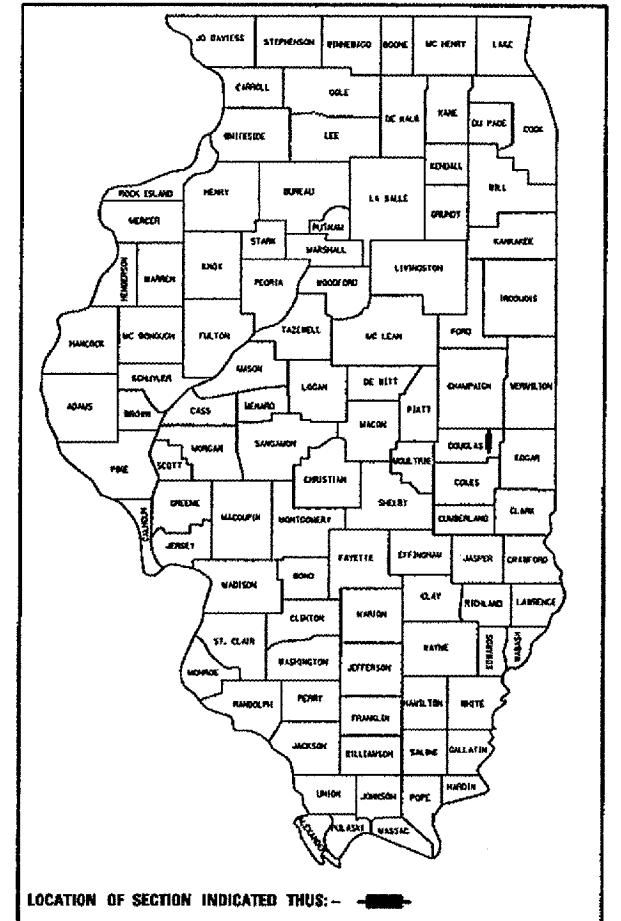

FOR INDEX OF SHEETS, SEE SHEET NO. 2  
 FOR SUMMARY OF QUANTITIES, SEE SHEET NO. 4 & 5

(217)465-4181

PROJECT ENGINEER: TIM BRANDENBURG

SQUAD LEADER: TODD BLACK

DESIGNER: GARY SIMS

**DESIGN DESIGNATION**  
 POLICY RESURFACING

ADT = 2250(2005)



FULL SIZE PLANS HAVE BEEN PREPARED USING STANDARD ENGINEERING SCALES. REDUCED SIZED PLANS WILL NOT CONFORM TO STANDARD SCALES. IN MAKING MEASUREMENTS ON REDUCED PLANS, THE ABOVE SCALES MAY BE USED.

J.U.L.I.E.  
 JOINT UTILITY LOCATION INFORMATION FOR EXCAVATION  
 1-800-892-0123

CONTRACT NO. 70276

DOUGLAS COUNTY SECTION (37,37-1,2&3)RS-1 F.A.P. ROUTE 820 (IL 130)

PROJECT ENDS  
 STATION 691+00.00

STATION EQUATION:  
 STATION 529+16.79 BK =  
 STATION 529+15.31 AH

STATION EQUATION:  
 STATION 210+85.93 BK =  
 STATION 501+01.77 AH

\*\* STATION EQUATION:  
 STATION 216+91.00 BK =  
 STATION 1+00.97 AH

PROJECT BEGINS  
 STATION 109+00.00

\*\* STATION EQUATION - NOT FROM SURVEY  
 DETERMINED BY OLD PLAN MEASUREMENTS

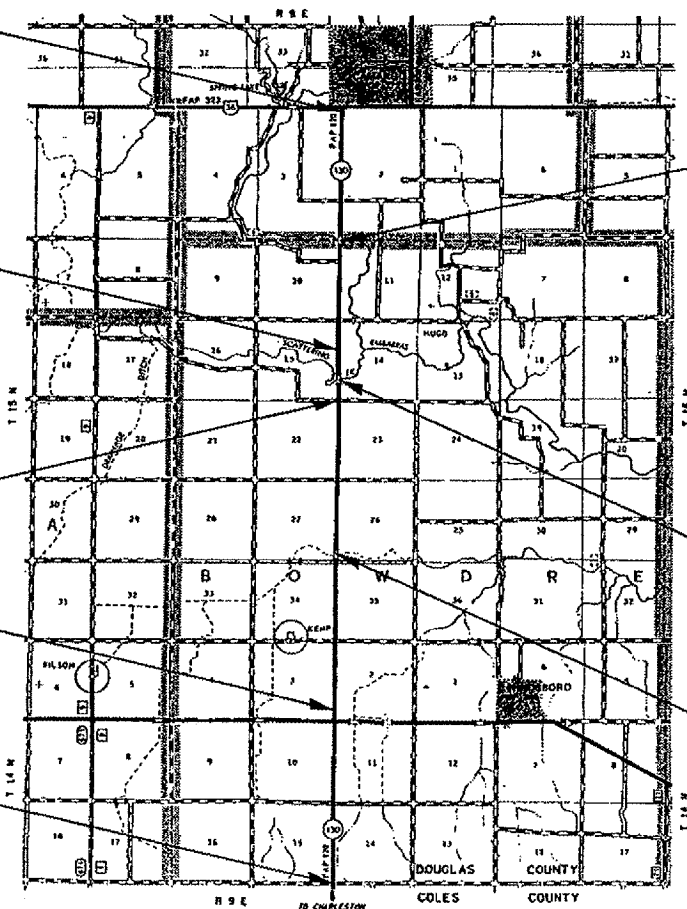

BRIDGE OMISSION:  
 STRUCTURE NO. 021-0030  
 EMBARRAS RIVER  
 STATION 602+93.25 TO  
 STATION 605+26.95

BRIDGE OMISSION:  
 STRUCTURE NO. 021-0031  
 SCATTERING FORK CREEK  
 STATION 512+82.99 TO  
 STATION 514+50.41

BRIDGE OMISSION:  
 STRUCTURE NO. 021-0049  
 DEER CREEK  
 STATION 107+60.00 TO  
 STATION 108+80.00

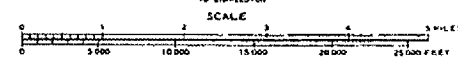

TOTAL LENGTH OF SECTION & PROJECT = 50,775.67 FEET = 9.617 MILES  
 NET LENGTH OF SECTION & PROJECT = 50,254.55 FEET = 9.518 MILES

STATE OF ILLINOIS  
 DEPARTMENT OF TRANSPORTATION  
 DIVISION OF HIGHWAYS

SUBMITTED *M. March 22, 2007*

*John*  
 DEPUTY DIRECTOR OF HIGHWAYS, REGION ENGINEER

*May 11, 2007*  
*Eric E. Harshbarger*  
 ENGINEER OF DESIGN AND ENVIRONMENT

*May 11, 2007*  
*Milton R. Sees, P.E.*  
 DIRECTOR OF HIGHWAYS, CHIEF ENGINEER

**PRINTED BY THE AUTHORITY  
 OF THE STATE OF ILLINOIS**