

SEC 15, T14N, R9E, 3rd PM

EXIST. CURVE DATA
PI STA. = 132+64.20
 Δ = 0° 39' 23" (RT)
D = 0° 01' 58.15"
R = 174,597.578'
T = 1,000.00'
L = 1999.872
E = 2.864'
S.E. = NONE
P.C. STA. = 122+64.20
P.T. STA. = 142+64.04

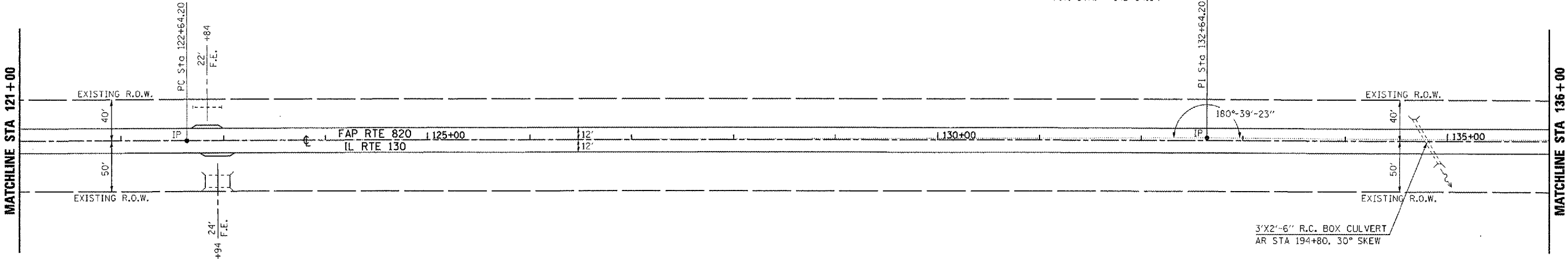

F.A.P. RTE.	SECTION	COUNTY	TOTAL SHEETS	SHEET NO.
820	*	DOUGLAS	57	27
STA. 121+00		TO STA. 151+00		
* (37,37-1,2&3)RS-1				



SEC 14, T14N, R9E, 3rd PM

SEC 15, T14N, R9E, 3rd PM

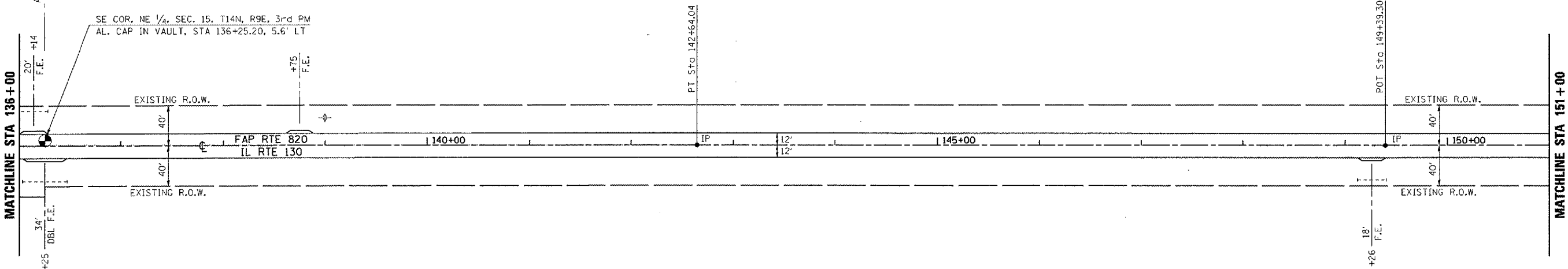

SEC 14, T14N, R9E, 3rd PM

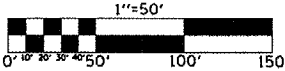

ILLINOIS DEPARTMENT OF TRANSPORTATION
PLAN VIEW
F.A.P. ROUTE 820 (IL 130)
SECTION (37,37-1,2&3)RS-1
DOUGLAS COUNTY
SCALE: 1" = 50'
DATE: 12/28/06
DRAWN BY: JRP
CHECKED BY:

STA 121+00 TO STA 151+00