

F.A.P. RTE.	SECTION	COUNTY	TOTAL SHEETS	SHEET NO.
820	*	DOUGLAS	57	30

STA. 211+00 TO STA. 25+00

*(37,37-1,2&3)RS-1

SEC 10, T14N, R9E, 3rd PM

SEC 3, T14N, R9E, 3rd PM

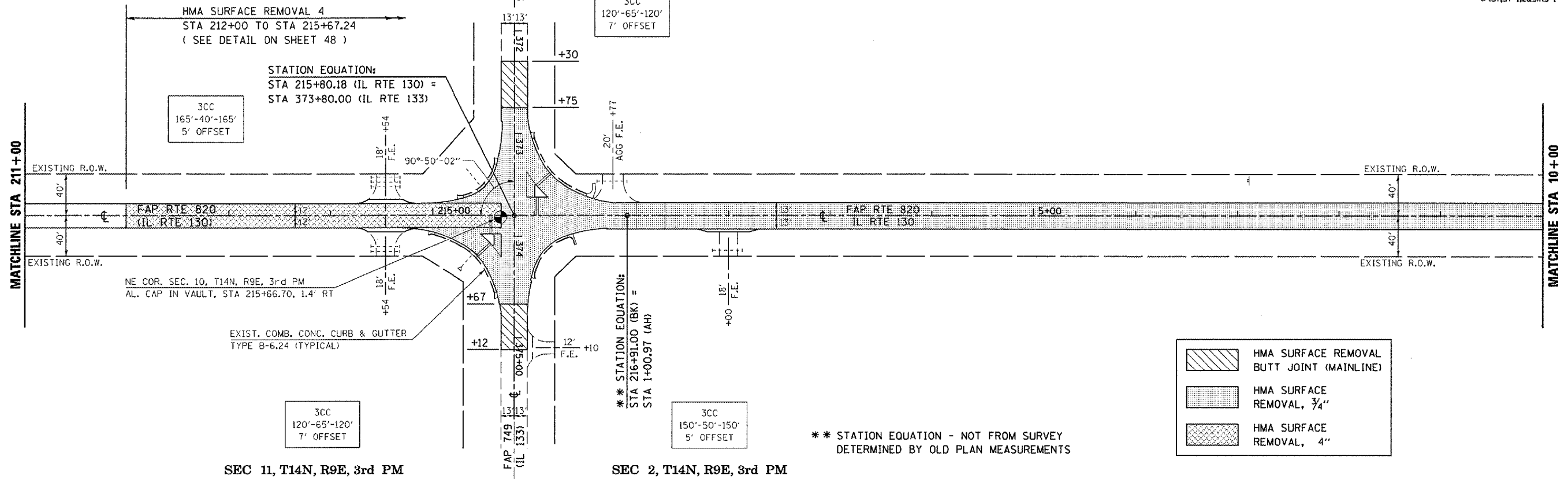

	HMA SURFACE REMOVAL BUTT JOINT (MAINLINE)
	HMA SURFACE REMOVAL, 3/4"
	HMA SURFACE REMOVAL, 4"

** STATION EQUATION - NOT FROM SURVEY DETERMINED BY OLD PLAN MEASUREMENTS

SEC 11, T14N, R9E, 3rd PM

SEC 2, T14N, R9E, 3rd PM

SEC 3, T14N, R9E, 3rd PM

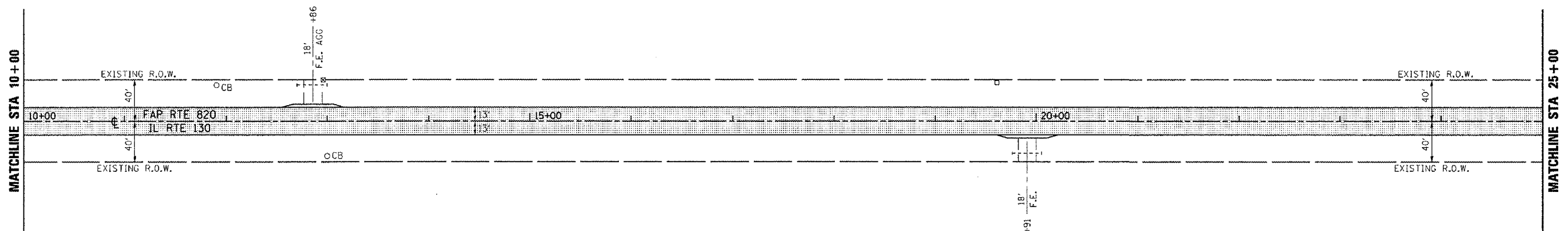

	HMA SURFACE REMOVAL, 3/4"
--	---------------------------

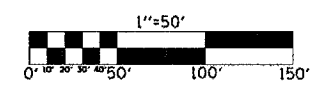

ILLINOIS DEPARTMENT OF TRANSPORTATION
PLAN VIEW
F.A.P. ROUTE 820 (IL 130)
SECTION (37,37-1,2&3)RS-1
DOUGLAS COUNTY

SCALE: 1" = 50'
 DATE: 12/28/06
 DRAWN BY: JRP
 CHECKED BY:

SEC 2, T14N, R9E, 3rd PM

STA 211+00 TO STA 25+00

PLOT DATE = 3/26/2007
 FILE NAME = c:\projects\820\820.dwg
 PLOT SCALE = 1/8"=1'-0"
 USER NAME = philipajr