

SEC 3, T14N, R9E, 3rd PM

CONTRACT NO. 70276

F.A.P. RTE.	SECTION	COUNTY	TOTAL SHEETS	SHEET NO.
820	*	DOUGLAS	57	31
STA. 25+00		TO STA. 55+00		

* (37,37-1,2&3)RS-1

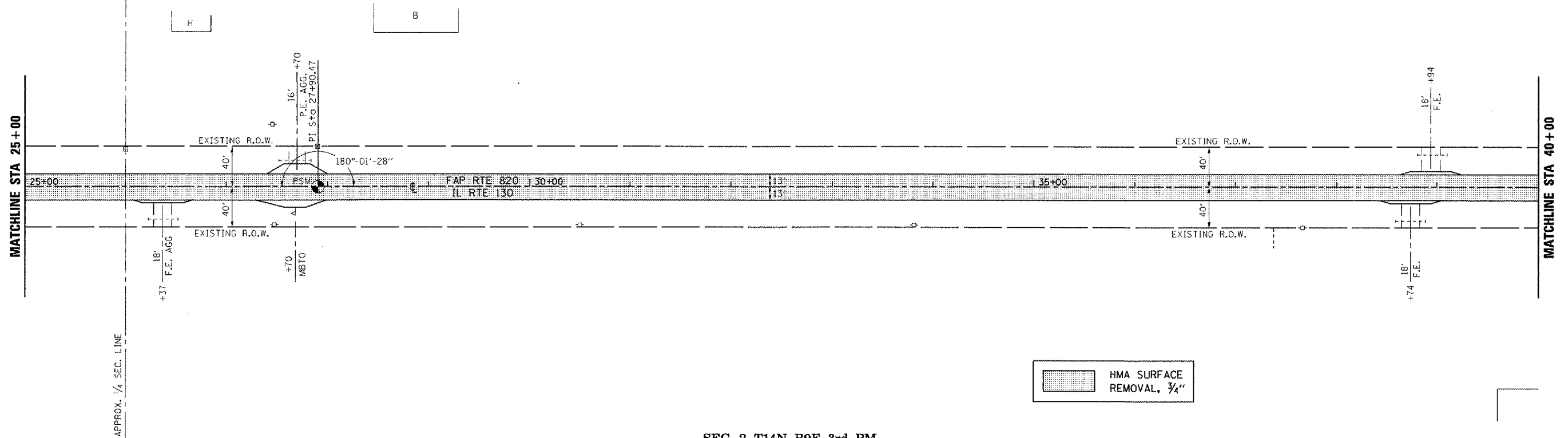

SEC 2, T14N, R9E, 3rd PM

SEC 3, T14N, R9E, 3rd PM

SEC 34, T15N, R9E, 3rd PM

EXIST. CURVE DATA
 PI STA. = 52+29.87
 Δ = 2° 02' 08" (RT)
 D = 0° 11' 04"
 R = 31,063.98'
 T = 551.86'
 L = 1,103.62'
 E = 4.90'
 S.E. = NONE
 P.C. STA. = 46+78.01
 P.T. STA. = 57+81.63

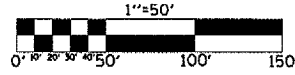
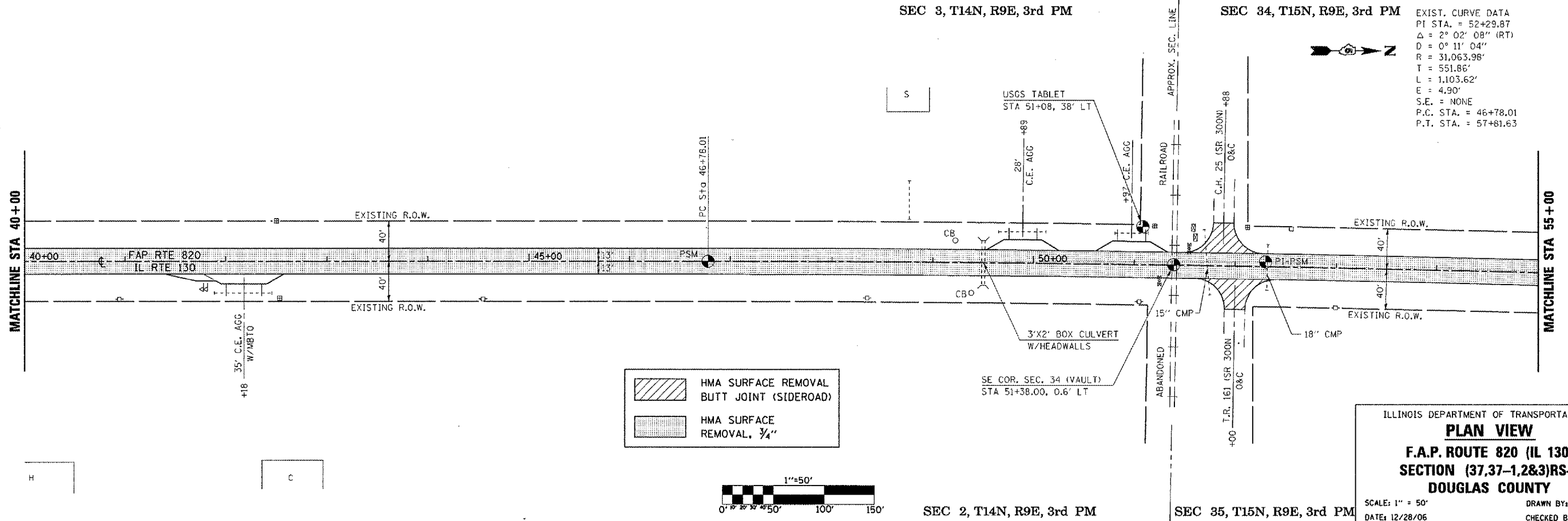

ILLINOIS DEPARTMENT OF TRANSPORTATION
PLAN VIEW
F.A.P. ROUTE 820 (IL 130)
SECTION (37,37-1,2&3)RS-1
DOUGLAS COUNTY
 SCALE: 1" = 50'
 DATE: 12/28/06
 DRAWN BY: JRP
 CHECKED BY:

STA 25+00 TO STA 55+00

PLOT DATE = 3/26/2007
 FILE NAME = c:\projects\4507002 (v8)17002-reference.dgn
 PLOT SCALE = 105,9824 * 1/31
 USER NAME = philipka