

F.A.P. RTE.	SECTION	COUNTY	TOTAL SHEETS	SHEET NO.
820	*	DOUGLAS	57	36
STA. 175+00 TO STA. 205+00				
* (37,37-1,2&3)RS-1				

EXIST. CURVE DATA
 PI STA. = 176+96.11
 $\Delta = 1^\circ 53' 41''$ (LT)
 $D = 0^\circ 11' 34''$
 $R = 29,721.15'$
 $T = 491.47'$
 $L = 982.85'$
 $E = 4.06'$
 S.E. = NONE
 P.C. STA. = 172+04.64
 P.T. STA. = 181+87.49

SEC 22, T15N, R9E, 3rd PM

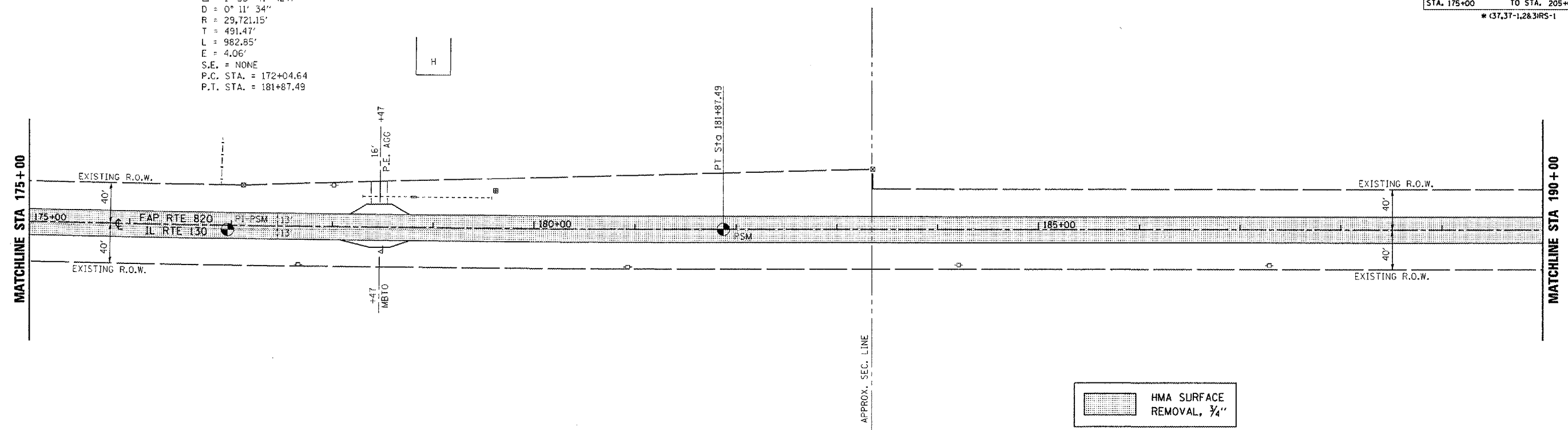

SEC 23, T15N, R9E, 3rd PM

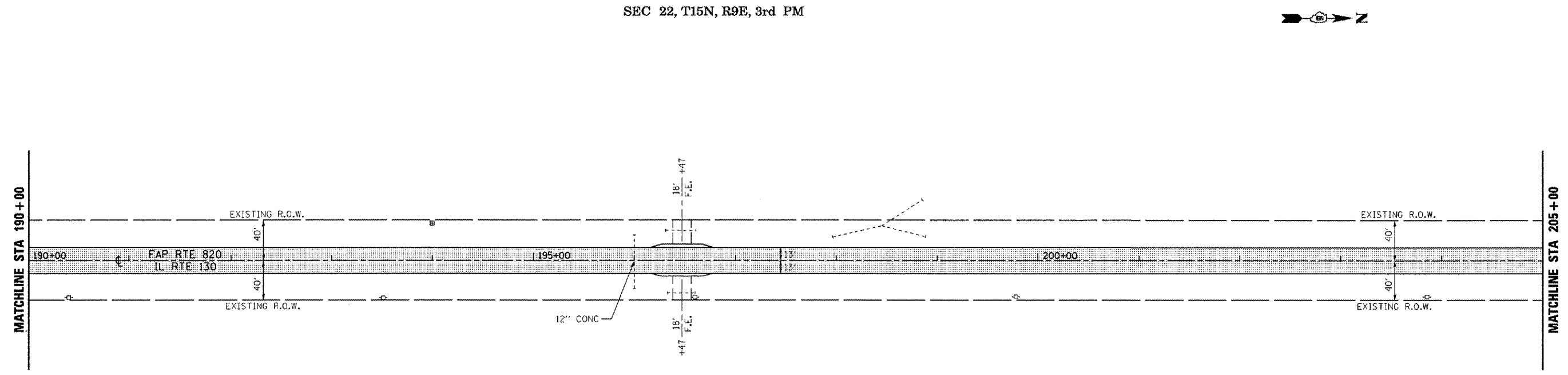

SEC 23, T15N, R9E, 3rd PM

HMA SURFACE REMOVAL, 3/4"

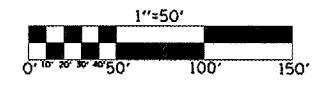

ILLINOIS DEPARTMENT OF TRANSPORTATION
PLAN VIEW
F.A.P. ROUTE 820 (IL 130)
SECTION (37,37-1,2&3)RS-1
DOUGLAS COUNTY

SCALE: 1" = 50'
 DATE: 12/28/06

DRAWN BY: JRP
 CHECKED BY:

STA 175+00 TO STA 205+00

PLOT DATE = 3/26/2007
 FILE NAME = c:\pco\pco\pco\587082 (587082-reference.dgn
 PLOT SCALE = 1/8"=50' / IN.
 USER NAME = phillips