

F.A.P. RTE.	SECTION	COUNTY	TOTAL SHEETS	SHEET NO.
820	*	DOUGLAS	57	37
STA. 205+00 TO STA. 525+00			* (37,37-1,2&3)RS-1	

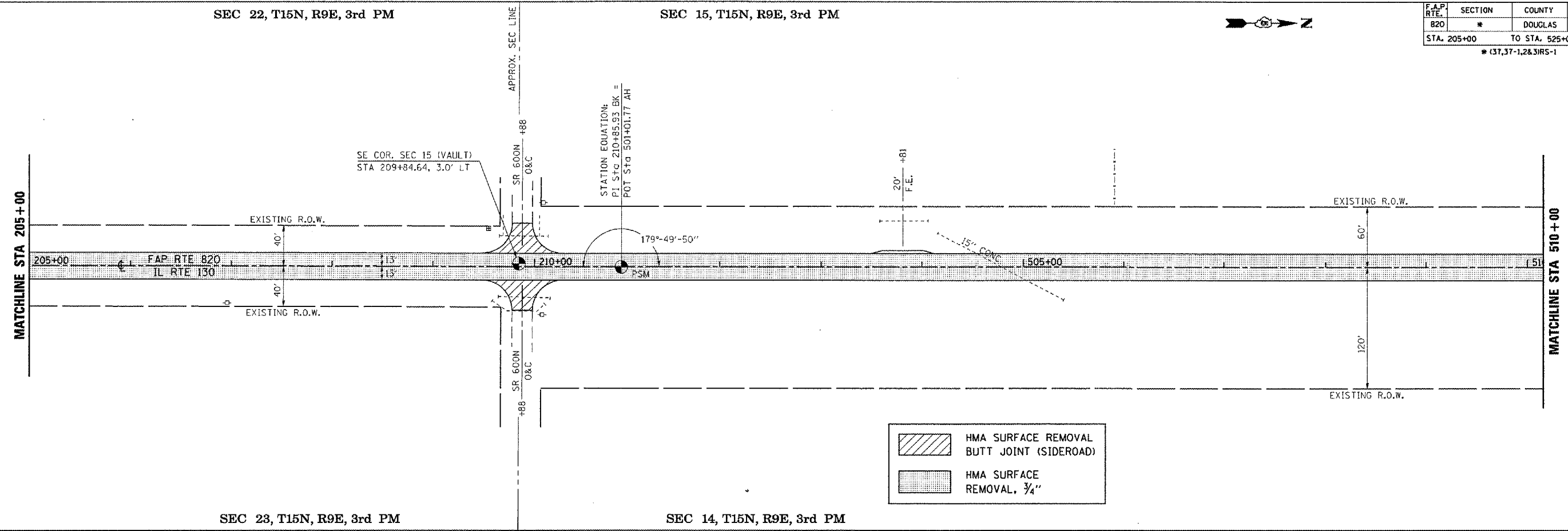

	HMA SURFACE REMOVAL BUTT JOINT (SIDEROAD)
	HMA SURFACE REMOVAL, 3/4"

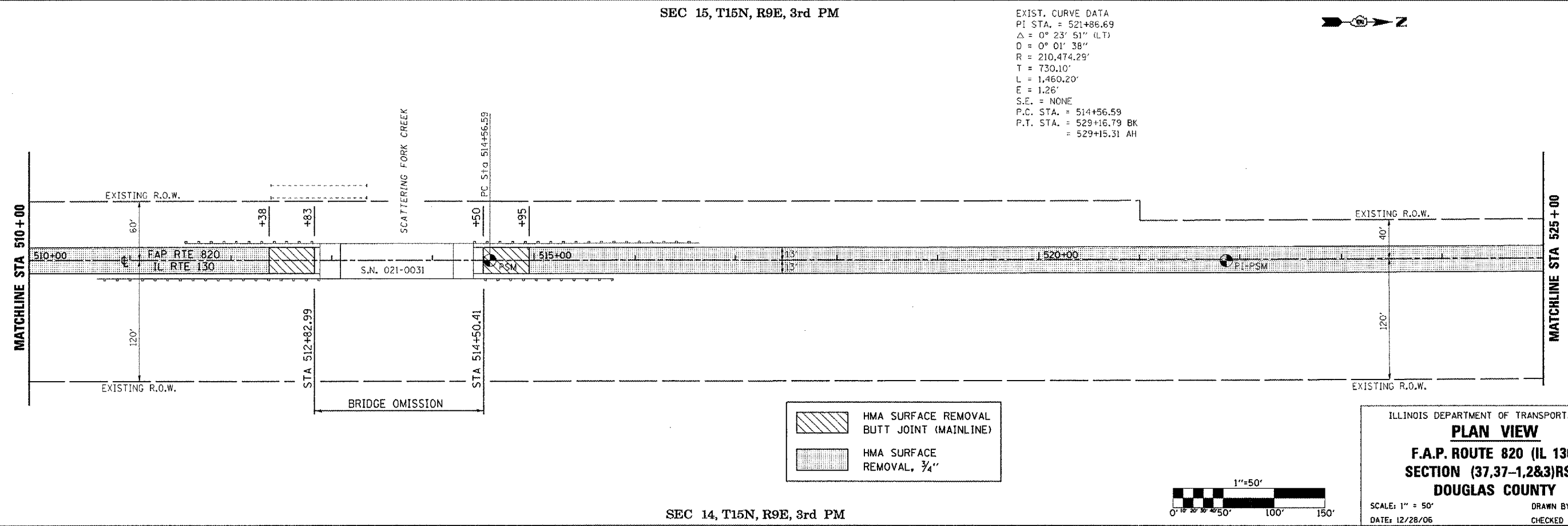

EXIST. CURVE DATA
 PI STA. = 521+86.69
 Δ = 0° 23' 51" (LT)
 D = 0° 01' 38"
 R = 210,474.29'
 T = 730.10'
 L = 1,460.20'
 E = 1.26'
 S.E. = NONE
 P.C. STA. = 514+56.59
 P.T. STA. = 529+16.79 BK
 = 529+15.31 AH

	HMA SURFACE REMOVAL BUTT JOINT (MAINLINE)
	HMA SURFACE REMOVAL, 3/4"

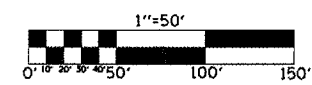

ILLINOIS DEPARTMENT OF TRANSPORTATION
PLAN VIEW
F.A.P. ROUTE 820 (IL 130)
SECTION (37,37-1,2&3)RS-1
DOUGLAS COUNTY
 SCALE: 1" = 50'
 DATE: 12/28/06
 DRAWN BY: JRP
 CHECKED BY:

SEC 14, T15N, R9E, 3rd PM

STA 205+00 TO STA 525+00

PLOT DATE : 3/26/2007
 FILE NAME : c:\projects\ad507002\4\81\7002-reference.dgn
 PLOT SCALE : 1/8"=1'-0" / 1/4"=1'-0"
 USER NAME : philipja