

SEC 15, T15N, R9E, 3rd PM

CONTRACT NO. 70276			
F.A.P. RTE.	SECTION	COUNTY	TOTAL SHEETS
820	*	DOUGLAS	57
STA. 525+00		TO STA. 555+00	
* (37,37-1,2&3)RS-1			

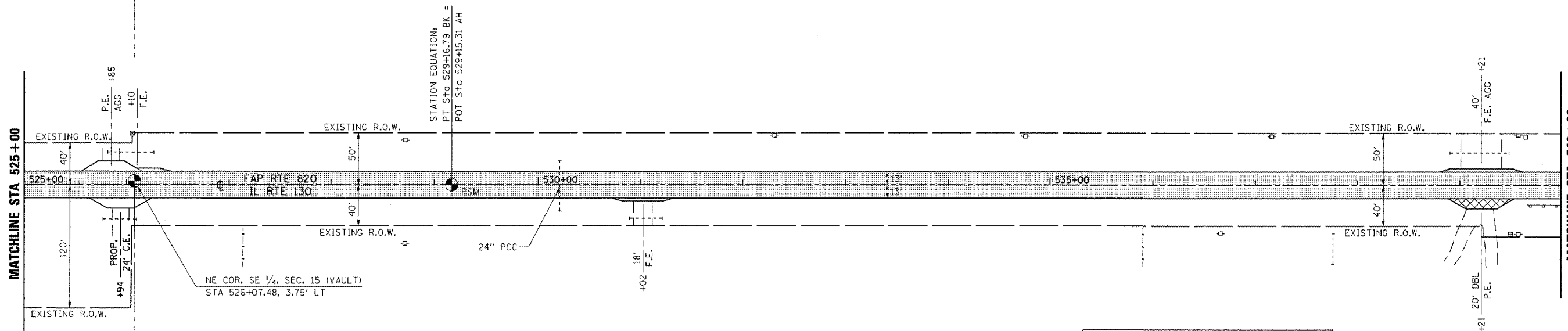

	HMA SURFACE REMOVAL BUTT JOINT (PRIVATE ENTR.)
	HMA SURFACE REMOVAL, 3/4"

SEC 14, T15N, R9E, 3rd PM



SEC 15, T15N, R9E, 3rd PM

SEC 10, T15N, R9E, 3rd PM

EXIST. CURVE DATA  
 P1 STA. = 552+55.28  
 $\Delta = 1^\circ 17' 20''$  (RT)  
 $D = 0^\circ 07' 54''$   
 $R = 43,515.78'$   
 $T = 489.47'$   
 $L = 978.90'$   
 $E = 2.75'$   
 $S.E. = \text{NONE}$   
 $P.C. STA. = 547+65.81$   
 $P.T. STA. = 557+44.71$

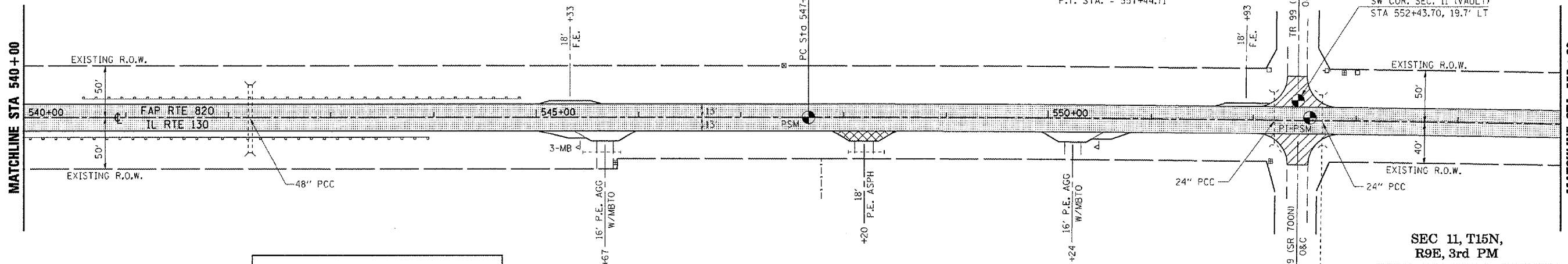

	HMA SURFACE REMOVAL BUTT JOINT (PRIVATE ENTR.)
	HMA SURFACE REMOVAL BUTT JOINT (SIDEROAD)
	HMA SURFACE REMOVAL, 3/4"

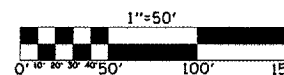

SEC 14, T15N, R9E, 3rd PM

SEC 11, T15N, R9E, 3rd PM

ILLINOIS DEPARTMENT OF TRANSPORTATION  
**PLAN VIEW**  
**F.A.P. ROUTE 820 (IL 130)**  
**SECTION (37,37-1,2&3)RS-1**  
**DOUGLAS COUNTY**  
 SCALE: 1" = 50'  
 DATE: 12/28/06  
 DRAWN BY: JRP  
 CHECKED BY:

STA 525+00 TO STA 555+00

PLOT DATE : 3/26/2007  
 FILE NAME : c:\projects\12597882 (68)\7882-reference.dgn  
 PLOT SCALE : 1/8"=50' / IN.  
 USER NAME : philippsjr