

F.A.P. RTE.	SECTION	COUNTY	TOTAL SHEETS	SHEET NO.
820	*	DOUGLAS	57	49

\*(37,37-1,2&3)RS-1

## DETAIL OF HMA SURFACE REMOVAL, 1 1/2"

EXISTING RUMBLE STRIPS SHALL REMAIN IN PLACE (SEE NOTE)

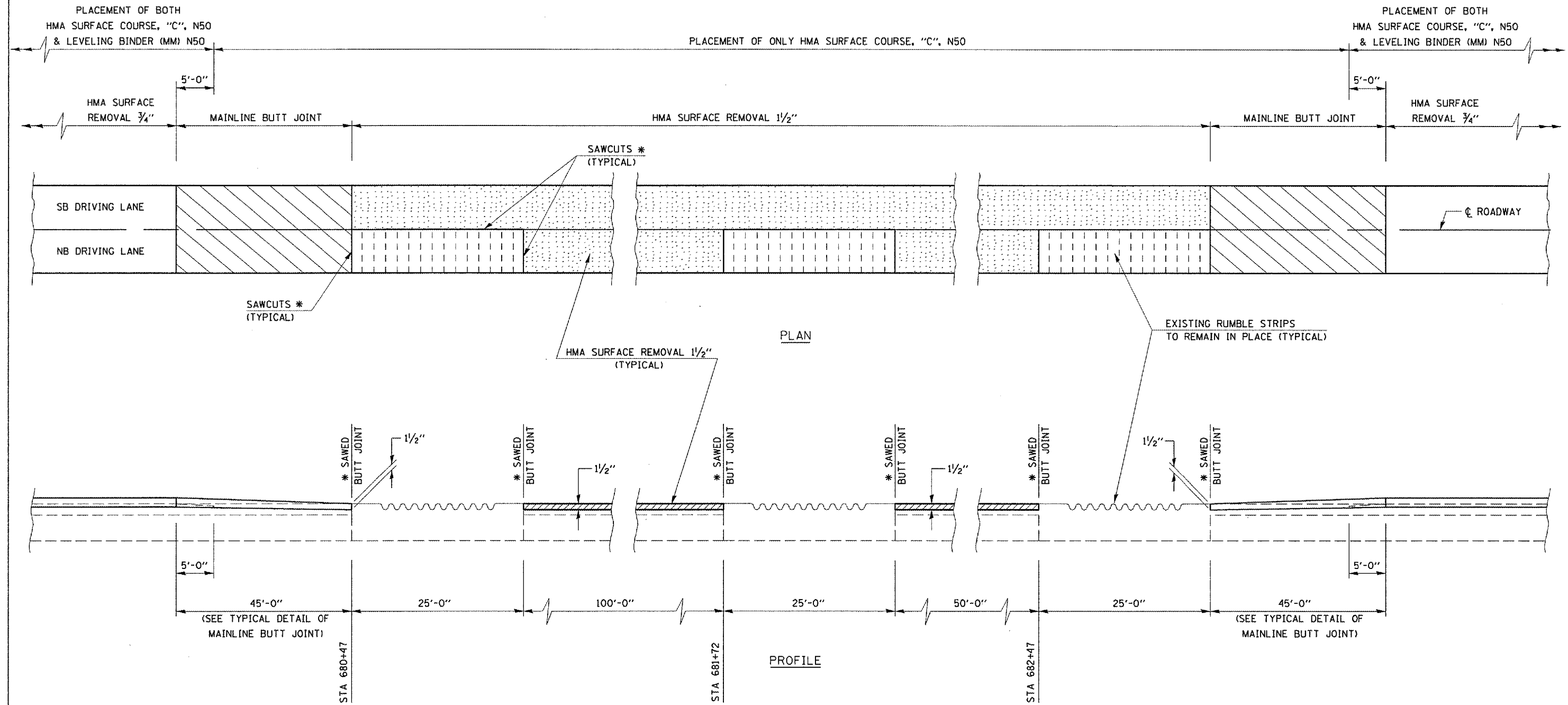

\* SAWCUTS AND SAWED BUTT JOINTS ADJACENT TO THE RUMBLE STRIPS SHALL NOT BE MEASURED FOR PAYMENT AND SHALL BE INCLUDED IN THE CONTRACT UNIT PRICE PER SQUARE YARD FOR HMA SURFACE REMOVAL 1 1/2".

**NOTE:**  
 EXISTING RUMBLE STRIPS SHALL REMAIN IN PLACE. THE CONTRACTOR SHALL INSURE EXISTING RUMBLE STRIPS ARE NOT DAMAGED DURING CONSTRUCTION. ANY DAMAGE DURING CONSTRUCTION SHALL BE THE CONTRACTOR'S RESPONSIBILITY TO REPAIR OR REPLACE TO THE SATISFACTION OF THE ENGINEER. NO ADDITIONAL COMPENSATION WILL BE ALLOWED.