

F.A.I. RTE.	SECTION	COUNTY	TOTAL SHEETS	SHEET NO.
57		••	153	68

STA. 148+90.00 TO STA. 154+90.312
 FED. ROAD DIST. NO. ILLINOIS FED. AID PROJECT

- D5 SAFETY IMPROVEMENT 2007-2
- CHAMPAIGN, COLES, & DOUGLAS



PLAN	SURVEYED	BY	DATE
NO. _____	PLOTTED		
	RT. OF WAY CHECKED		
	NO. _____		
	CADD FILE NAME		

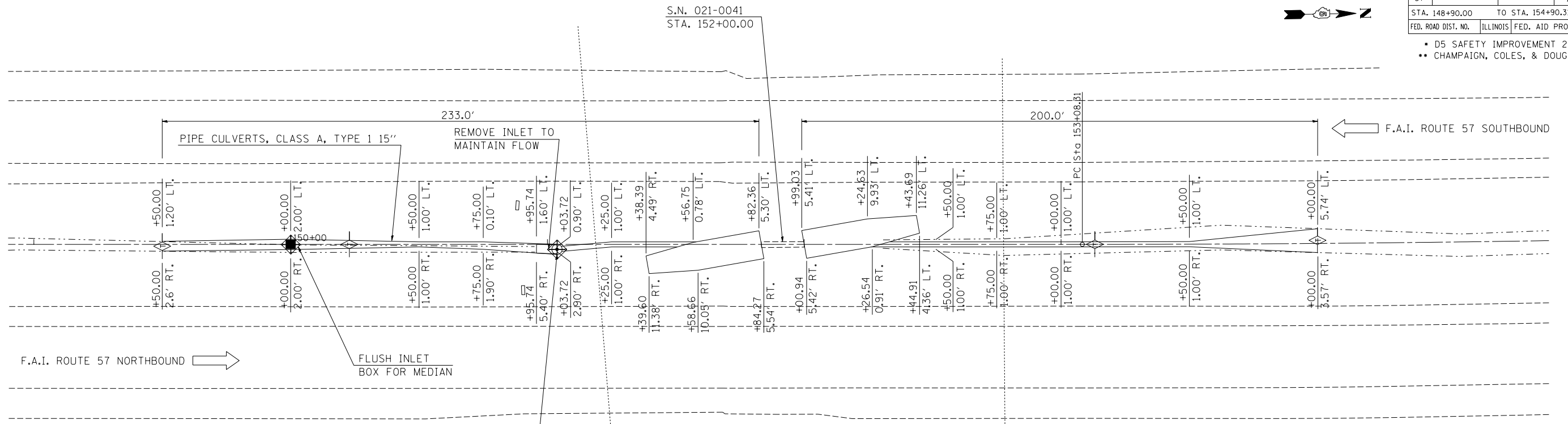

NOTE
 PIPE UNDERDRAINS 4" SHALL BE EXTENDED TO FLOW LINE OR NEAREST INLET. THE PIPE UNDERDRAIN HEADWALLS SHALL BE INCIDENTAL TO PIPE UNDERDRAINS 4".

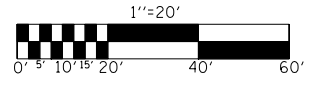

PROFILE	SURVEYED	BY	DATE
NO. _____	PLOTTED		
	STRUCTURE NOTATIONS CHKD		

PLOT DATE = 3/30/2007
 FILE NAME = c:\projects\0514406 (v8)\021_0041\0041.mpd
 PLOT SCALE = 42.3529' / IN.
 USER NAME = piersonbr

