

CONTRACT NO. 72798

F.A.P. RTE.	SECTION	COUNTY	TOTAL SHEETS	SHEET NO.
315	(1,2)RS-4	MASON	44	39
STA. 31+00.00		TO STA. 37+00.00		
FED. ROAD DIST. NO.	ILLINOIS	FED. AID PROJECT		

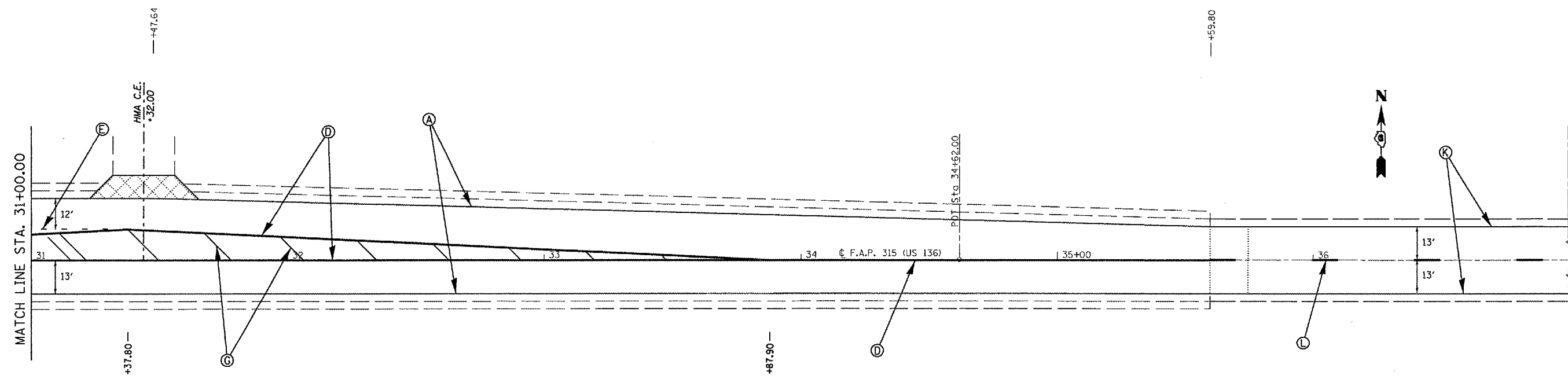

PAVEMENT MARKING LEGEND

(THERMOPLASTIC)

- (A) PAVEMENT MARKING - LINE - 5" WHITE (SOLID)
- (B) PAVEMENT MARKING - LINE - 5" YELLOW (SOLID)
- (C) PAVEMENT MARKING - LINE - 5" YELLOW (SKIP-DASH)
- (D) PAVEMENT MARKING - LINE - 5" DOUBLE YELLOW (SOLID)
- * (E) PAVEMENT MARKING - LINE - 6" WHITE (SKIP - DASH)
- (F) PAVEMENT MARKING - LINE - 6" WHITE (SOLID)
- (G) PAVEMENT MARKING - LINE - 12" YELLOW (SOLID)

(PREFORMED PLASTIC, TYPE B)

- (H) PAVEMENT MARKING - LINE - 6" WHITE (SOLID)
- (I) PAVEMENT MARKING - LINE - 24" WHITE (SOLID)
- (J) PAVEMENT MARKING - LETTERS & SYMBOLS WHITE (SOLID)

(PAINT)

- * (K) PAVEMENT MARKING - LINE - 5" WHITE (SOLID)
- * (L) PAVEMENT MARKING - LINE - 5" YELLOW (SKIP - DASH)
- * (E) 12' DASH - 6' SKIP)
- * (L) (4' DASH - 40' SKIP)

REVISIONS	
NAME	DATE

ILLINOIS DEPARTMENT OF TRANSPORTATION

PAVEMENT MARKING DETAILS

F.A.P. Route 315 (US 136)
Section (1,2)RS-4
MASON COUNTY

SCALE: VERT.
HORIZ.
DATE: MARCH 1, 2007

DRAWN BY: JWC
CHECKED BY: RSC

PLOT DATE = 3/22/2007
PLOT SCALE = 41.3775 / IN.
USER NAME = eocj