

F.A. RTE.	SECTION	COUNTY	TOTAL SHEETS	SHEET NO.
	*	MACON	12	14
STA.	TO STA.			
FED. ROAD DIST. NO.	ILLINOIS	FED. AID PROJECT		

D-7 JOINT REPAIRS 2007-3

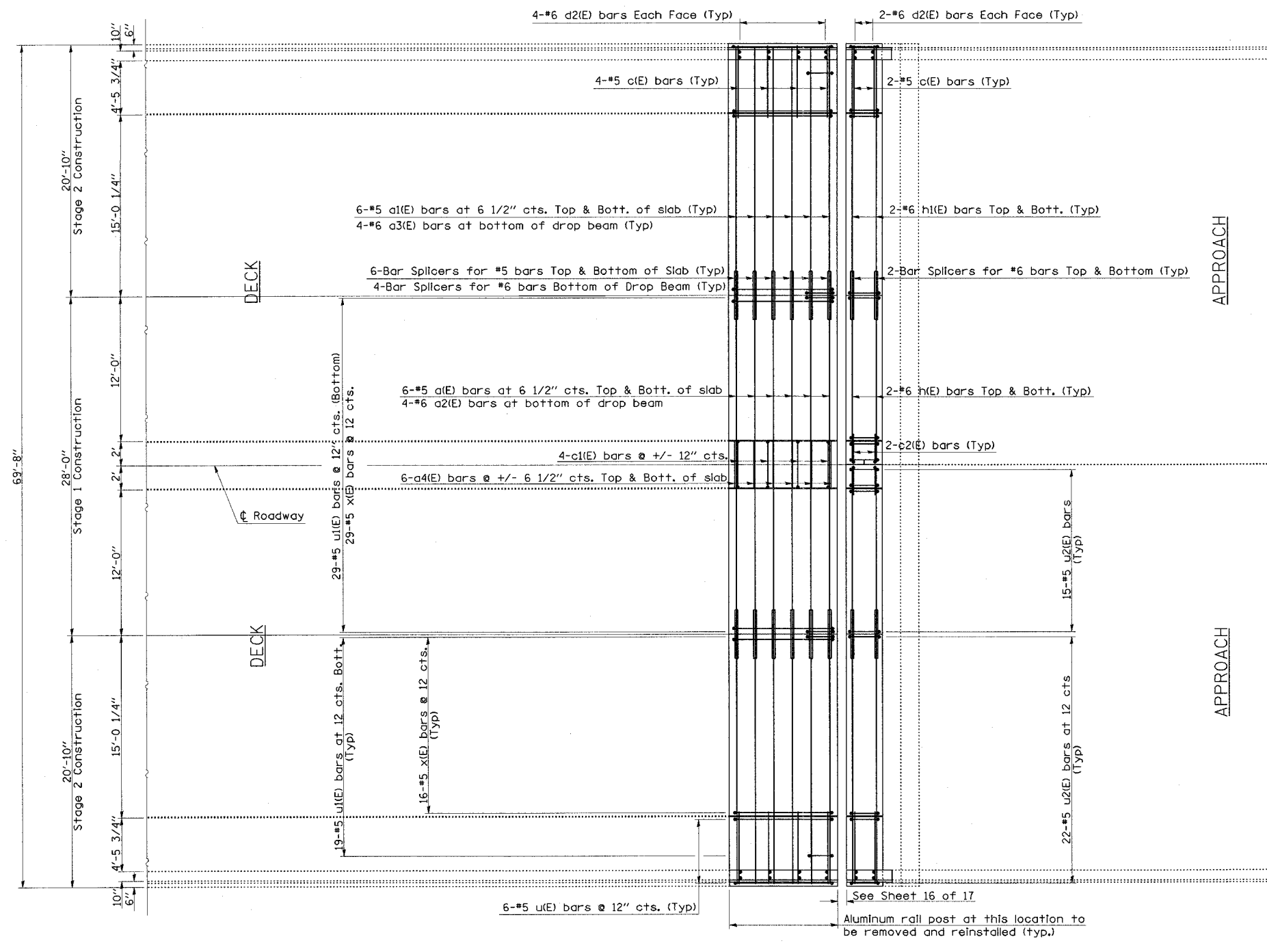

PLAN VIEW OF DECK/ABUTMENT REINFORCEMENT DETAIL

BAR LIST - PER ABUTMENTS - STR #058-0020

BAR	NUMBER OF BARS		TOTAL	SIZE	LENGTH	SHAPE	
	STAGE I	STAGE II					
a(E)	12		12	#5	27'-9"	—	
a1(E)		24	24	#5	20'-7"	—	
a2(E)	4		4	#6	27'-9"	—	
a3(E)		8	8	#6	18'-7"	—	
a4(E)	12		12	#5	4'-0"	—	
c(E)		12	12	#5	6'-9"	—	
c1(E)	4		4	#5	6'-4"	┌	
c2(E)	4		4	#5	4'-1"	┌	
d2(E)		24	24	#6	6'-0"	┌	
h(E)	8		8	#6	13'-8"	—	
h1(E)		8	8	#6	20'-7"	—	
u(E)		12	12	#5	3'-11"	┌	
u1(E)	29	38	67	#5	4'-0"	┌	
u2(E)	30	44	74	#5	1'-11"	┌	
x(E)	29	32	61	#5	3'-4"	┌	
CONCRETE REMOVAL						CU. YD.	25.6
REINFORCEMENT BARS (EPOXY COATED)						POUND	5490
CONCRETE SUPERSTRUCTURE						CU. YD.	25.6

REINFORCEMENT BARS DESIGNATED (E) SHALL BE EPOXY COATED

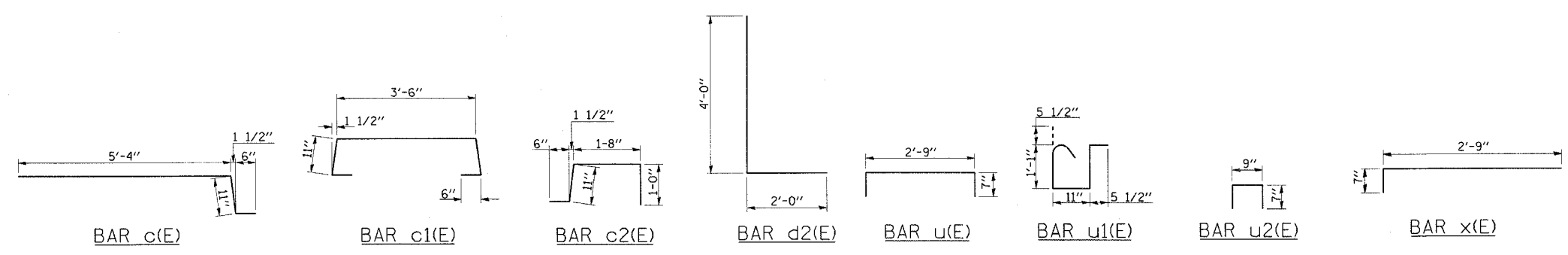

REVISIONS		ILLINOIS DEPARTMENT OF TRANSPORTATION
NAME	DATE	
		EXPANSION JOINT REINFORCEMENT DETAILS SN 058-0020

SCALE: VERT. _____
HORIZ. _____
DATE _____

DRAWN BY _____
CHECKED BY _____

PLOT DATE = 3/25/2007
FILE NAME = c:\projects\74202b\087486.psdgn
PLOT SCALE = 50.0000 / 1"
USER NAME = sub-ctr